

**Driveway**  
1 : 50

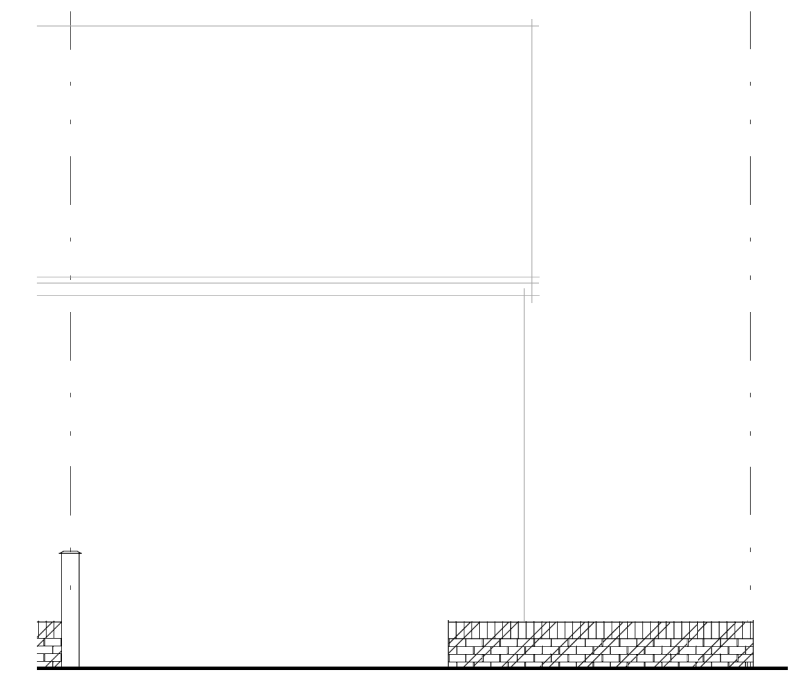
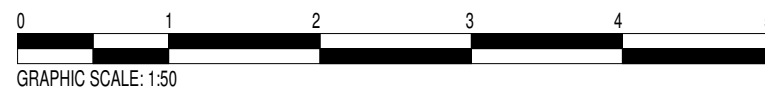

**Front Elevation**  
1 : 100

This drawing and the information provided is the property of Thorns-Young Architectural and shall not be copied whole, in part, or used for any other purpose without written permission from the company.

Principle Contractor is to ensure all materials and workmanship complies with Regulation 7 of the Building Regulations whether or not specifically stated on these drawings. It is the Principle Contractors' duty to ensure all works on site are approved by an appointed Building Control body.

Principle Contractor is to ensure dimensions are taken on site before procurement of any materials/work proceeding. Structural members are not to be ordered scaling from this drawing.

Principle Contractor to ensure full compliance with the amended CDM Regulations (2015) if the project requires.

This drawing, unless noted, does not represent compliance with the Party Wall Act 1996 and if required, all agreements are to be in place before works commence.

It is the Principle Contractors' responsibility to ensure Planning/Building Control approvals are in place prior to works commencing. Should works commence prior to relevant approvals Thorns-Young Architectural accept no responsibility.

Do not scale from this drawing except for the purpose of Local Authority Planning department

Rev.	Date	Description
------	------	-------------

**THORNS YOUNG**  
ARCHITECTURAL

**THORNS-YOUNG LTD**  
CHARTERED BUILDING CONSULTANTS  
www.thornsyong.co.uk

<b>Fareham</b> 21 Middle Road Park Gate SO31 7GH Tel: (01329) 888 322	<b>Portsmouth</b> 232 London Road North End PO2 9JQ Tel: (023) 9267 2883
---	--

Client  
**Mr Miah**

Job Title  
**519 London Road  
North End**

Drawing Title  
**Proposed Droob Kerb**

Scale **As indicated** Sheet **A2**

Date **JUL 20** Drawn by **CM**

Drg. No.  
**4118 · 20 · 1**

Rev.