

New uPVC double glazed window, style to match existing house to give min 1.6 W/m<sup>2</sup>k U value. Catnic CH110/100 over with 150mm minimum end bearings

New uPVC french doors, style to clients choice to give min 1.6 W/m<sup>2</sup>k U value. Glazing to be toughened to BS6206 class A. Colour to be white RAL 9010 Matt. Catnic CH110/100 over with 150mm minimum end bearings

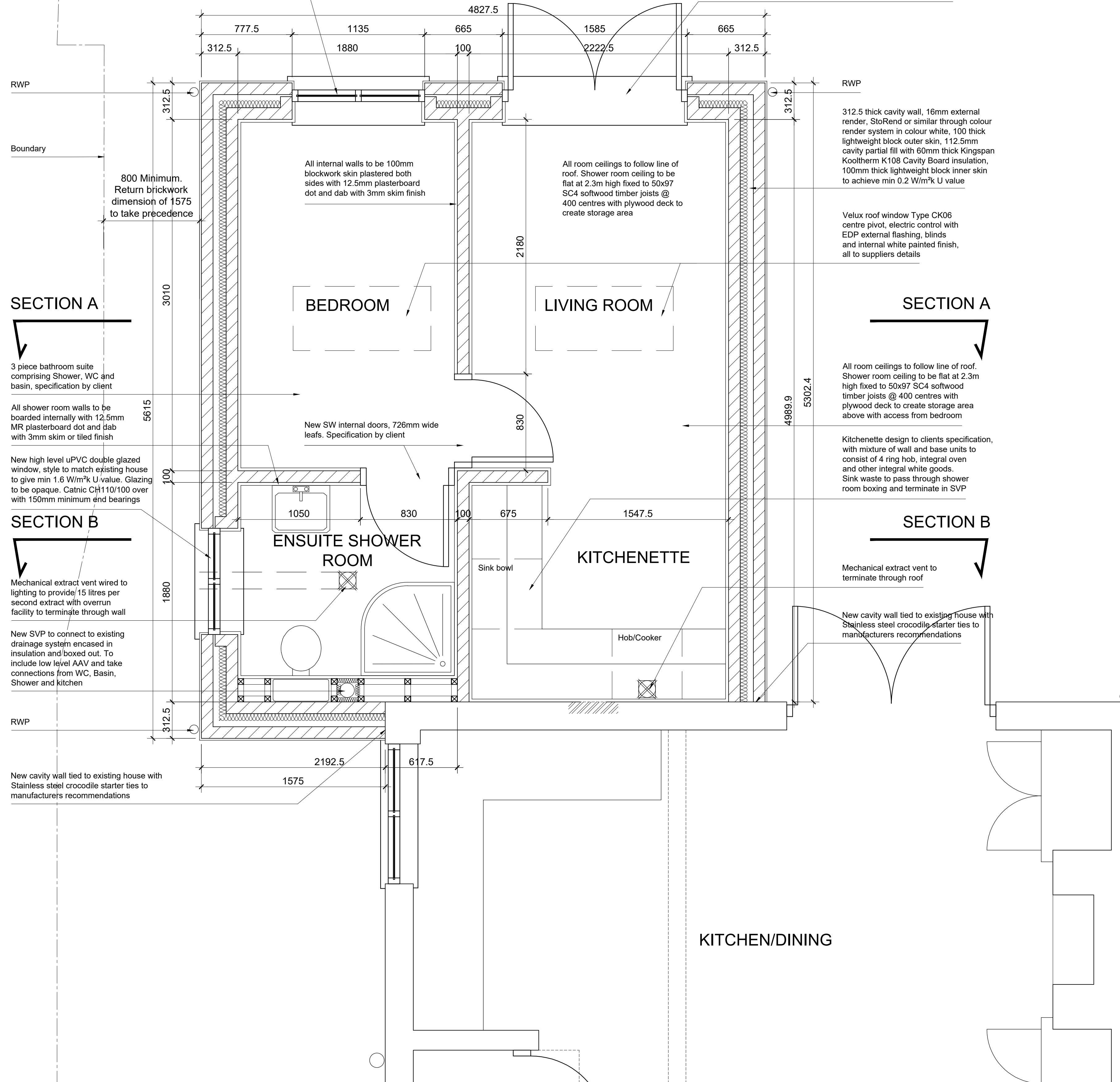

RWP

RWP

Boundary

800 Minimum. Return brickwork dimension of 1575 to take precedence

All internal walls to be 100mm blockwork skin plastered both sides with 12.5mm plasterboard dot and dab with 3mm skim finish

All room ceilings to follow line of roof. Shower room ceiling to be flat at 2.3m high fixed to 50x97 SC4 softwood timber joists @ 400 centres with plywood deck to create storage area

312.5 thick cavity wall, 16mm external render, StoRender or similar through colour render system in colour white, 100 thick lightweight block outer skin, 112.5mm cavity partial fill with 60mm thick Kingspan Kooltherm K108 Cavity Board insulation, 100mm thick lightweight block inner skin to achieve min 0.2 W/m<sup>2</sup>k U value

Velux roof window Type CK06 centre pivot, electric control with EDP external flashing, blinds and internal white painted finish, all to suppliers details

SECTION A

SECTION A

3 piece bathroom suite comprising Shower, WC and basin, specification by client

All shower room walls to be boarded internally with 12.5mm MR plasterboard dot and dab with 3mm skim or tiled finish

New high level uPVC double glazed window, style to match existing house to give min 1.6 W/m<sup>2</sup>k U value. Glazing to be opaque. Catnic CH110/100 over with 150mm minimum end bearings

New SW internal doors, 726mm wide leafs. Specification by client

All room ceilings to follow line of roof. Shower room ceiling to be flat at 2.3m high fixed to 50x97 SC4 softwood timber joists @ 400 centres with plywood deck to create storage area above with access from bedroom

Kitchenette design to clients specification, with mixture of wall and base units to consist of 4 ring hob, integral oven and other integral white goods. Sink waste to pass through shower room boxing and terminate in SVP

SECTION B

SECTION B

Mechanical extract vent wired to lighting to provide 15 litres per second extract with overrun facility to terminate through wall

New SVP to connect to existing drainage system encased in insulation and boxed out. To include low level AAV and take connections from WC, Basin, Shower and Kitchen

Mechanical extract vent to terminate through roof

New cavity wall tied to existing house with Stainless steel crocodile starter ties to manufacturers recommendations

RWP

New cavity wall tied to existing house with Stainless steel crocodile starter ties to manufacturers recommendations

KITCHEN/DINING

STATUS  
PROJECT  
2 PLAINS GROVE  
MAPPERLEY, NOTTINGHAM  
DRAWING  
EXTENSION TO DWELLING  
PROPOSED GROUND FLOOR PLAN

SCALE 1:50 SHEET SIZE A1 DRAWN BY DS CHECKED BY DATE 14/12/2020  
PROJECT NO. DRAWING NO. PGM (20)001 REVISION