

Aberdeenshire Council  
Development Management

**NESBReC**  
Aberdeenshire Council  
Woodhill House  
Westburn Road  
Aberdeen  
AB16 5GB  
Tel: 01467 537221  
[nesbrec@aberdeenshire.gov.uk](mailto:nesbrec@aberdeenshire.gov.uk)

11 January 2021

Dear Planning Officer

**NESBReC report: Planning Reference APP/2021/0001**

NESBReC has provided this report based on the biological data that it holds in the NESBReC database. However, NESBReC is solely the provider of data and cannot advise on individual planning applications. If you wish to comment on any planning application please contact your local planning office at: [planning@aberdeenshire.gov.uk](mailto:planning@aberdeenshire.gov.uk) or add your comments to the relevant planning application on the Aberdeenshire Council website.

A list of all the datasets used in the search process can be obtained directly from NESBReC and data can be summarised as designated, non-designated and priority species, sites and habitats.

Results table:

Ref no	Data set	Interest	Locality	Grid Ref	Proposal
APP/2021/0001	Common Swift records	Swift ( <i>Apus apus</i> )	Former Aviation Storage Facility Station Road / A947 Millmoss Turrieff Aberdeenshire AB53 8BJ	NJ 72860 49056	Erection of Car Showroom / Service Centre and Formation of Car Parking and Car Display Areas
	Designated Species	<b>UK BAP</b> Brown Hare ( <i>Lepus europaeus</i> ) Dunnock ( <i>Prunella modularis</i> ) Linnet ( <i>Linaria cannabina</i> ) Skylark ( <i>Alauda arvensis</i> ) Spotted Flycatcher ( <i>Muscicapa striata</i> ) Song Thrush ( <i>Turdus philomelos</i> ) Yellowhammer ( <i>Emberiza citrinella</i> ) <b>SBL S5</b> Barn Owl ( <i>Tyto alba</i> ) Swift ( <i>Apus apus</i> )			
	Integrated Habitat System Openspace 2008-2009	GI0 - improved grassland CR0 - arable and horticulture GNZ - other neutral grassland			

Maps showing all the search results are included below.

Yours sincerely

D Caffrey  
GIS Project Officer

**PLEASE READ THE FOLLOWING NOTES:**

- 1) NESBReC has provided this report based on the biological data that it holds in the NESBReC database. However, NESBReC is solely the provider of data and cannot advise on individual planning applications. If you wish to comment on any planning application please contact your local planning office at: [planning@aberdeenshire.gov.uk](mailto:planning@aberdeenshire.gov.uk) or add your comments to the relevant planning application on the website.
- 2) Search was done to within 100 metres of the area of interest. This is indicated on the map by a broken line around the site.
- 3) Search areas or centroids are highlighted in red.
- 4) The dots on any maps depicting the locations of a species are positioned at the centre of a square representing the resolution of the recorded grid reference. Care should be taken over interpretation
- 5) Due to the limits of the map display function, all records may not be visible on the species maps. However, all species are listed in the relevant table above the map and a full list of records can be supplied in Excel format.
- 6) Scientific names are only used to identify species on maps when no common name is in general accepted usage.
- 7) For maps without a key, the relevant information is provided in the table.
- 8) The ownership of the data within this report remains with the original recorder and is subject to the laws defining Intellectual Property Copyright.
- 9) This report and the data held within it are to be used solely for those purposes described under the terms of any agreement between the Planning Authority and NESBReC.
- 10) Some, or all of the data held within this report may be of a sensitive or confidential nature. Such information will be marked as such and if required an appropriate contact for further correspondence will be given (otherwise NESBReC should be contacted).
- 11) Although NESBReC makes every possible effort to ensure that the data it provides is accurate and up to date, this report should only be considered to represent the most recent version of each dataset as available at the time of the search.
- 12) For the purposes of planning reports NESBReC is returning data on Habitat Survey, Protected Species, Invasive Species and Protected Areas data only.
- 13) NE LBAP Locally Important Species are species that are not on existing designated species lists but have been identified as important in the local context.

For designated species, the following abbreviated sub-headings are used to describe different levels of importance:

Protection of Badgers Act (1992)

ANNEX 1, 2.1, 2.2 – EC Birds Directive

UK BAP - UK BAP list of Priority Species

SBL S2 - Scottish Biodiversity List: International Obligations

SBL S3 - Scottish Biodiversity List: Nationally Rare at UK level, found in only 1-15 10km squares

SBL S4 - Scottish Biodiversity List: Present in 5 or fewer 10km squares or sites in Scotland

SBL S5 - Scottish Biodiversity List: Decline of 25% or more in Scotland in last 25 years

Note, a species may be designated under several of these lists, but will only be listed under its highest level designation within this report. The ranking order used here is Protection of Badgers Act (1992), ANNEX 1, ANNEX 2.1, UK BAP, ANNEX 2.2, SBL S2-SBL S5.



APP/2021/0001	Designated Species	<b>UK BAP</b> Brown Hare ( <i>Lepus europaeus</i> ) Dunnoch ( <i>Prunella modularis</i> ) Linnet ( <i>Linaria cannabina</i> ) Skylark ( <i>Alauda arvensis</i> ) Spotted Flycatcher ( <i>Muscicapa striata</i> ) Song Thrush ( <i>Turdus philomelos</i> ) Yellowhammer ( <i>Emberiza citrinella</i> ) <b>SBL S5</b> Barn Owl ( <i>Tyto alba</i> ) Swift ( <i>Apus apus</i> )	Former Aviation Storage Facility Station Road / A947 Millmoss Turrieff Aberdeenshire AB53 8BJ	NJ 72860 49056	Erection of Car Showroom / Service Centre and Formation of Car Parking and Car Display Areas
---------------	--------------------	--	--	-------------------	--

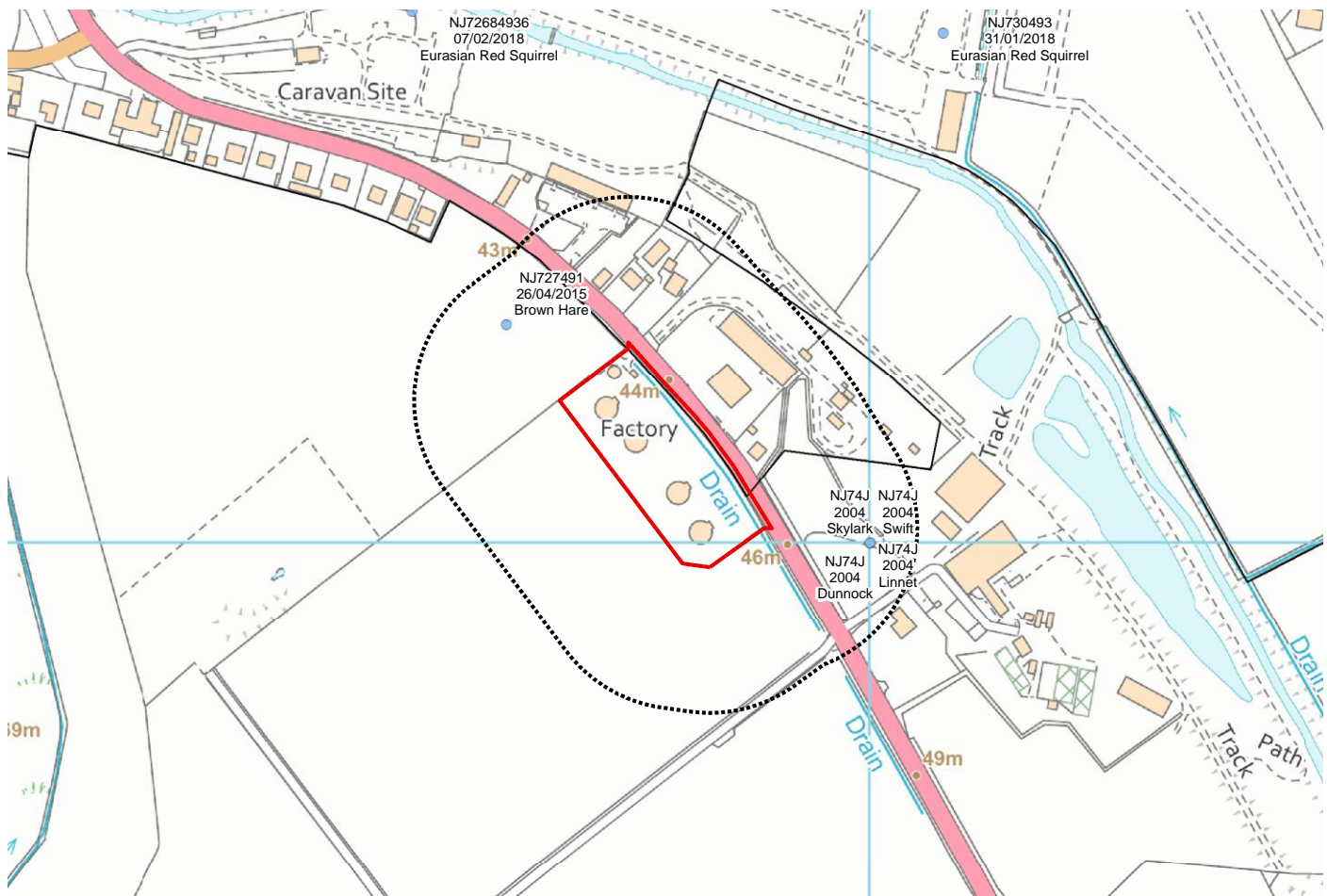

APP/2021/0001	Integrated Habitat System Openspace 2008-2009	GI0 - improved grassland CR0 - arable and horticulture GNZ - other neutral grassland	Former Aviation Storage Facility Station Road / A947 Millmoss Turriff Aberdeenshire AB53 8BJ	NJ 72860 49056	Erection of Car Showroom / Service Centre and Formation of Car Parking and Car Display Areas
---------------	---	--	---	-------------------	--

