

SECTION A-A

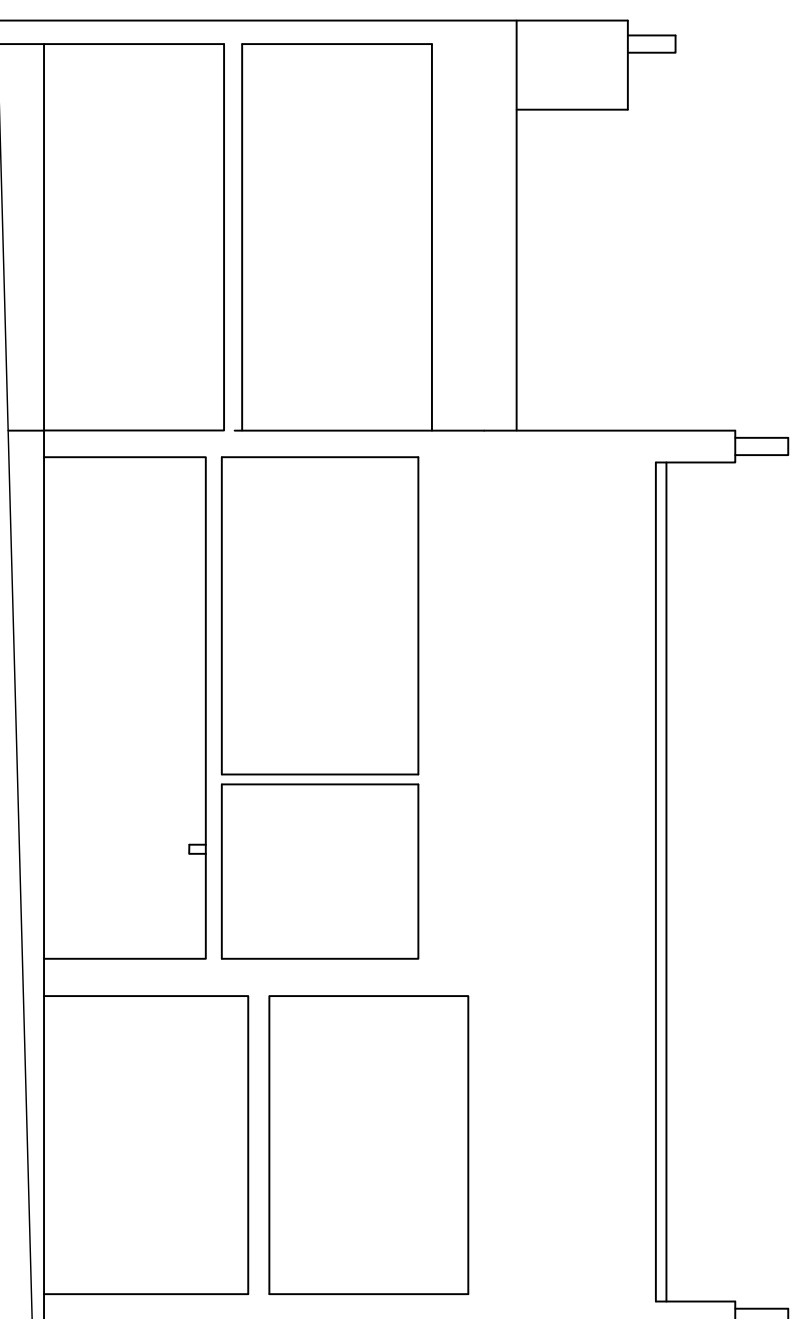

SECTION B-B



Notes
 All setting out of work to be checked before work commences.
 Any errors to be reported to the Architect before any further work is carried out.
 All work to be in accordance with the relevant Building Regulations.

ISSUED FOR INFORMATION

Revision	Note	Date	Revision	Note	Date
A	Issued for Listed Building Consent application.	22/01/20			

Project	
KINGSLAND HOUSE, SALWAYASH, BRIDPORT, DT6 5JF	Title
22/01/2020	SECTION A-A AND B-B AS EXISTING
SS	Drawn by
SS	Checked by
1:100 @ A3	Scale
1122 ASU 006	Drawing No.
Rev. A	Rev.