

N.B. Works noted in italics approved as previous Listed Building Consent and Planning Approval refs: WD/D/20/000483 and WD/D/20/000484

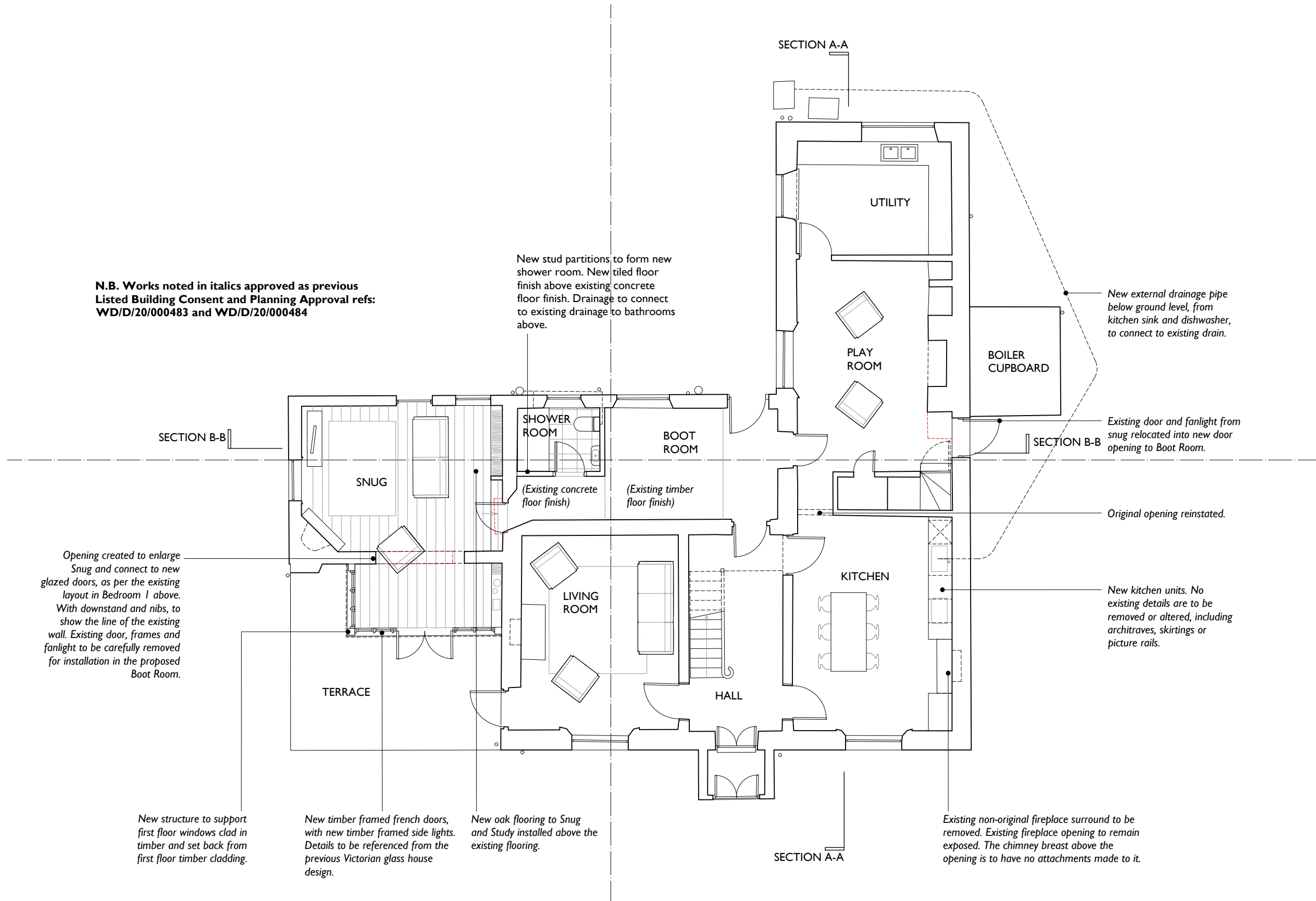

Opening created to enlarge Snug and connect to new glazed doors, as per the existing layout in Bedroom 1 above. With downstand and nibs, to show the line of the existing wall. Existing door, frames and fanlight to be carefully removed for installation in the proposed Boot Room.

New structure to support first floor windows clad in timber and set back from first floor timber cladding.

New timber framed french doors, with new timber framed side lights. Details to be referenced from the previous Victorian glass house design.

New oak flooring to Snug and Study installed above the existing flooring.

Existing non-original fireplace surround to be removed. Existing fireplace opening to remain exposed. The chimney breast above the opening is to have no attachments made to it.



Notes
 All setting out of work to be checked before work commences.
 Any errors to be reported to the Architect before any further work is carried out.
 All work to be in accordance with the relevant Building Regulations.

ISSUED FOR APPROVAL

Revision	Note	Date	Revision	Note	Date
A	Issued for Listed Building Consent application.	18/11/20			

Project		
KINGSLAND HOUSE, SALWAYASH, BRIDPORT, DT6 5JF		
Date	18/11/2020	Title
Drawn by	SS	GROUND FLOOR PLAN AS PROPOSED
Checked by	SS	
Scale	1:100 @ A3	Drawing No. 1122 APL 201 Rev. A

SSA
 SADIE SNELSON ARCHITECTS
 Unit 2E, Old Rope Walks,
 North Mills Trading Estate,
 Bridport, DT6 3BE
 info@ssarchitects.co.uk
 © COPYRIGHT 2009 SS ARCHITECTS LTD