

The Merryburn Hotel, Station Road, Birnam

First floor plan as proposed

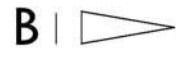

Colour coded key for different properties proposed:

- Main body of hotel retained as self catering apartments and owner's accommodation
- New independent dwelling created at mews house 'Garraidh Uisdean'

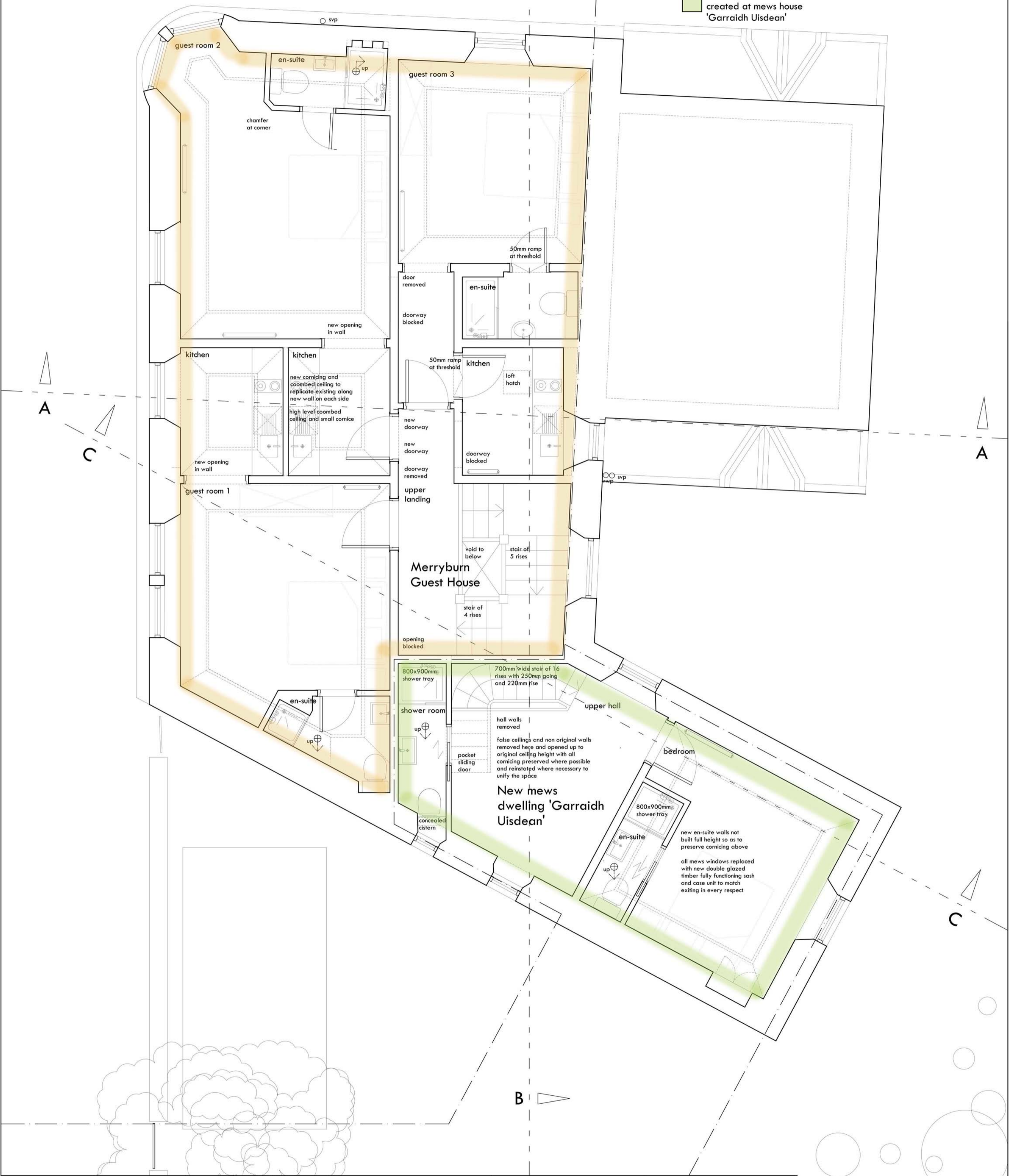

notes

do not scale from the drawing for any construction purpose

any discrepancies to be reported to the architect immediately

the property is hotel in a three storey traditional stone building

drawing to be read in conjunction with structural engineer's details and specification

revisions	revisions
A	01/12/2020 updated for formal planning, en-suite added AMW

project	drawing title
ALTERATIONS AND CONVERSION AT THE MERRYBURN HOTEL, BIRNAM, PERTSHIRE	FIRST FLOOR PLAN AS PROPOSED

client	drawing no.	scale
HILARY RENNIE AND DEIRDRE MORRISON	212A	1:50@A2
	drawn by	date
	AMW	SEP 2020

lucid
architecture

116 shakespeare street glasgow G20 8LF

0141 628 5557

mail@lucidarchitecture.co.uk
www.lucidarchitecture.co.uk