

All these windows (and door) replaced with double glazed sash and case fully functioning timber windows to match existing.

WINDOW TYPE A
(8 WINDOWS)

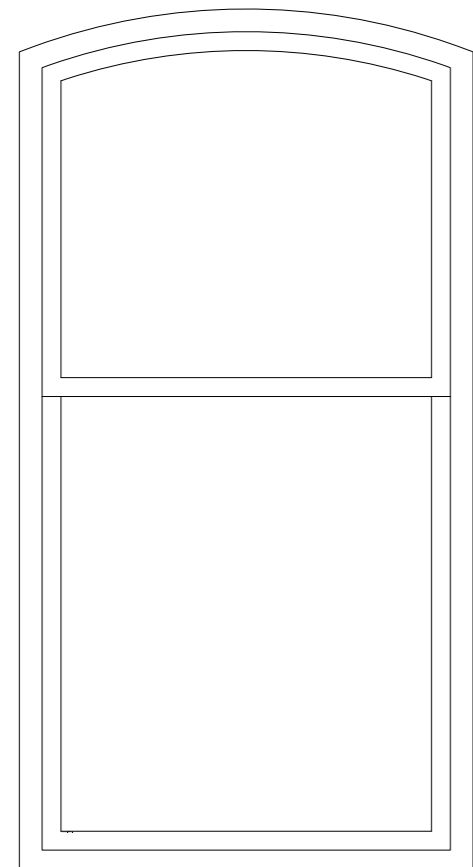

Plan and section through existing sash and case window

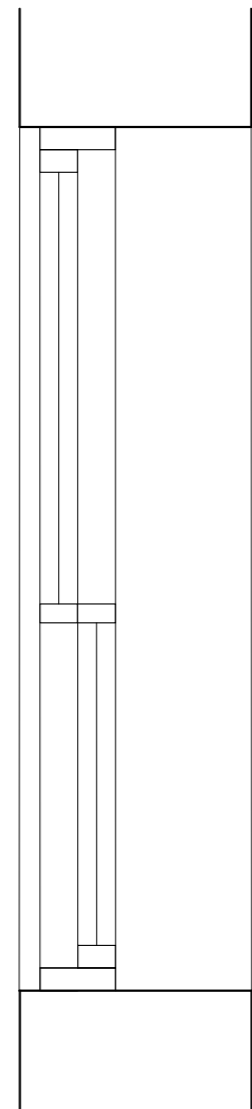

WINDOW TYPE B
(1 WINDOW)

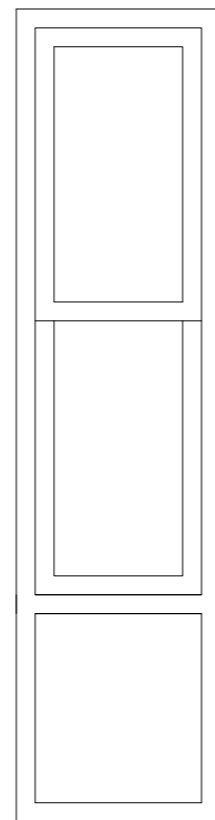

Plan and section through existing sash and case window

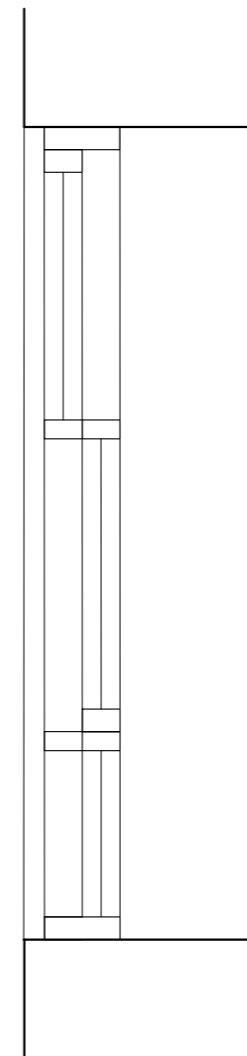

DOOR TYPE C
(1 DOOR)

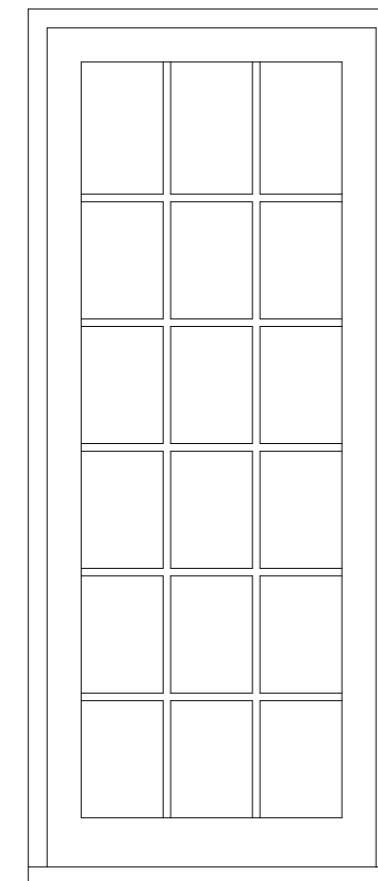

Plan and section through existing timber door

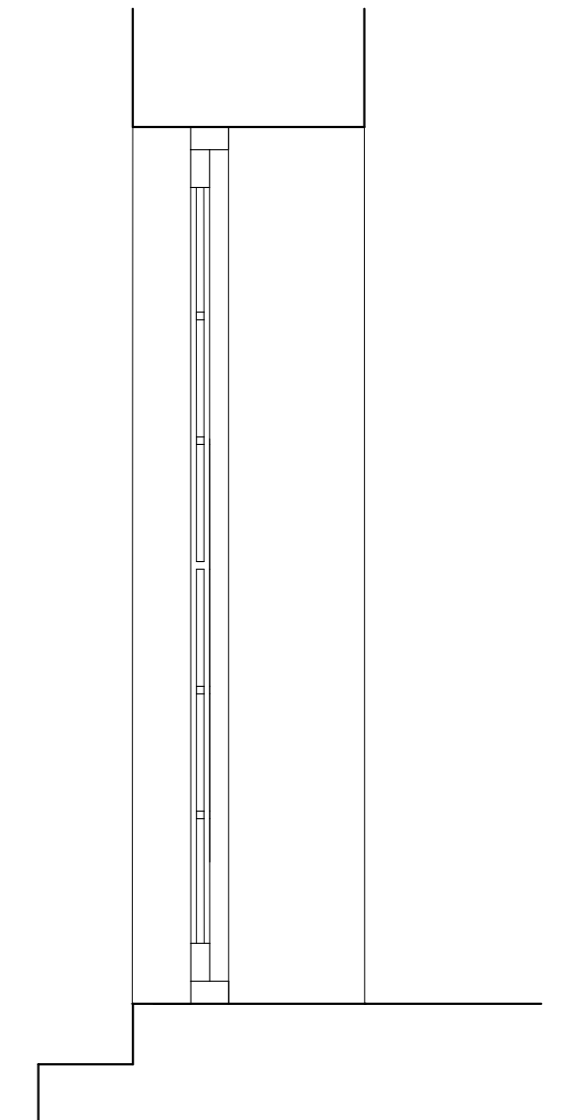

WINDOW TYPE D
(1 WINDOW)

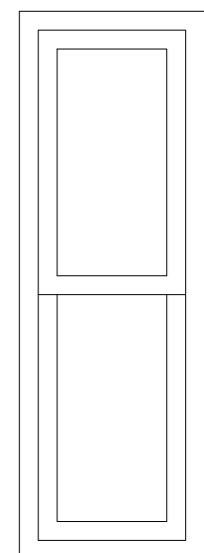

Plan and section through existing sash and case window

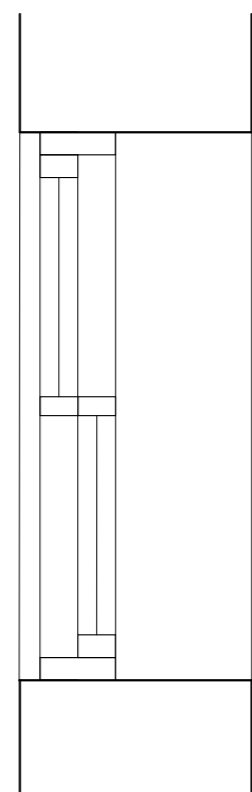

WINDOW TYPE E
(1 WINDOW)

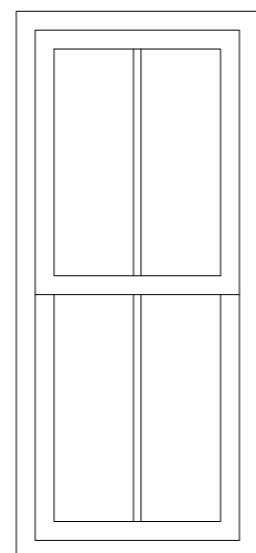

Plan and section through existing sash and case window

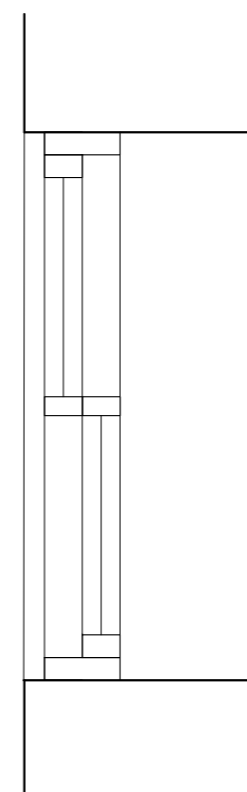

WINDOW TYPE F
(1 WINDOW)

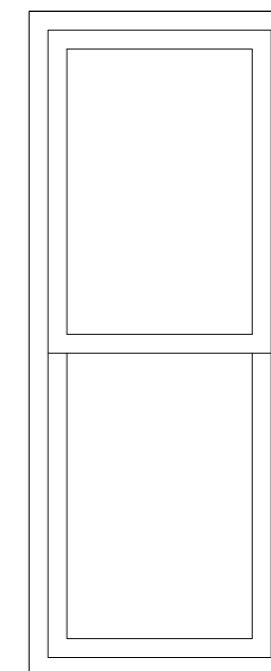

Plan and section through existing sash and case window

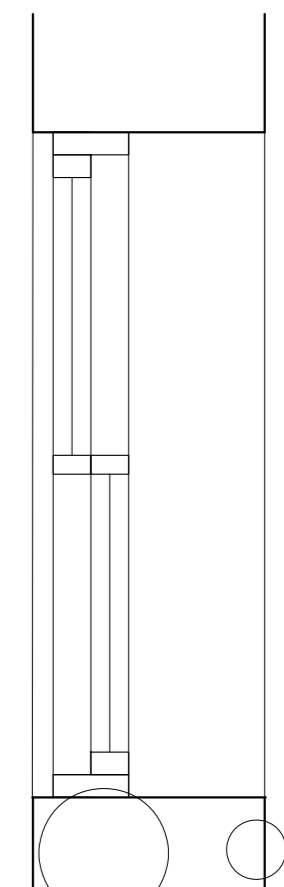

<p>notes</p> <p>do not scale from the drawing for any construction purpose</p> <p>any discrepancies to be reported to the architect immediately</p> <p>the property is hotel in a three storey traditional stone building</p> <p>drawing to be read in conjunction with structural engineer's details and specification</p>	revisions		revisions		project	drawing title	
					ALTERATIONS AND CONVERSION AT THE MERRYBURN HOTEL, BIRNAM, PERTSHIRE	EXTRACT SHOWING TYPICAL WINDOW DETAILS AS EXISTING SHEET 1	
					client	drawing no.	scale
					HILARY RENNIE AND DEIRDRE MORRISON	300	1:20@A2
						drawn by	date
					AMW	DEC 2020	

lucid
architecture

116 shakespeare street glasgow G20 8LF

0141 628 5557

mail@lucidarchitecture.co.uk
www.lucidarchitecture.co.uk