

The Merryburn Hotel, Station Road, Birnam

Ground floor plan as proposed

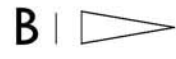

Colour coded key for different properties proposed:

- Main body of hotel retained as self catering apartments and owner's accommodation
- New independent dwelling created at mews house 'Garraidh Uisdean'

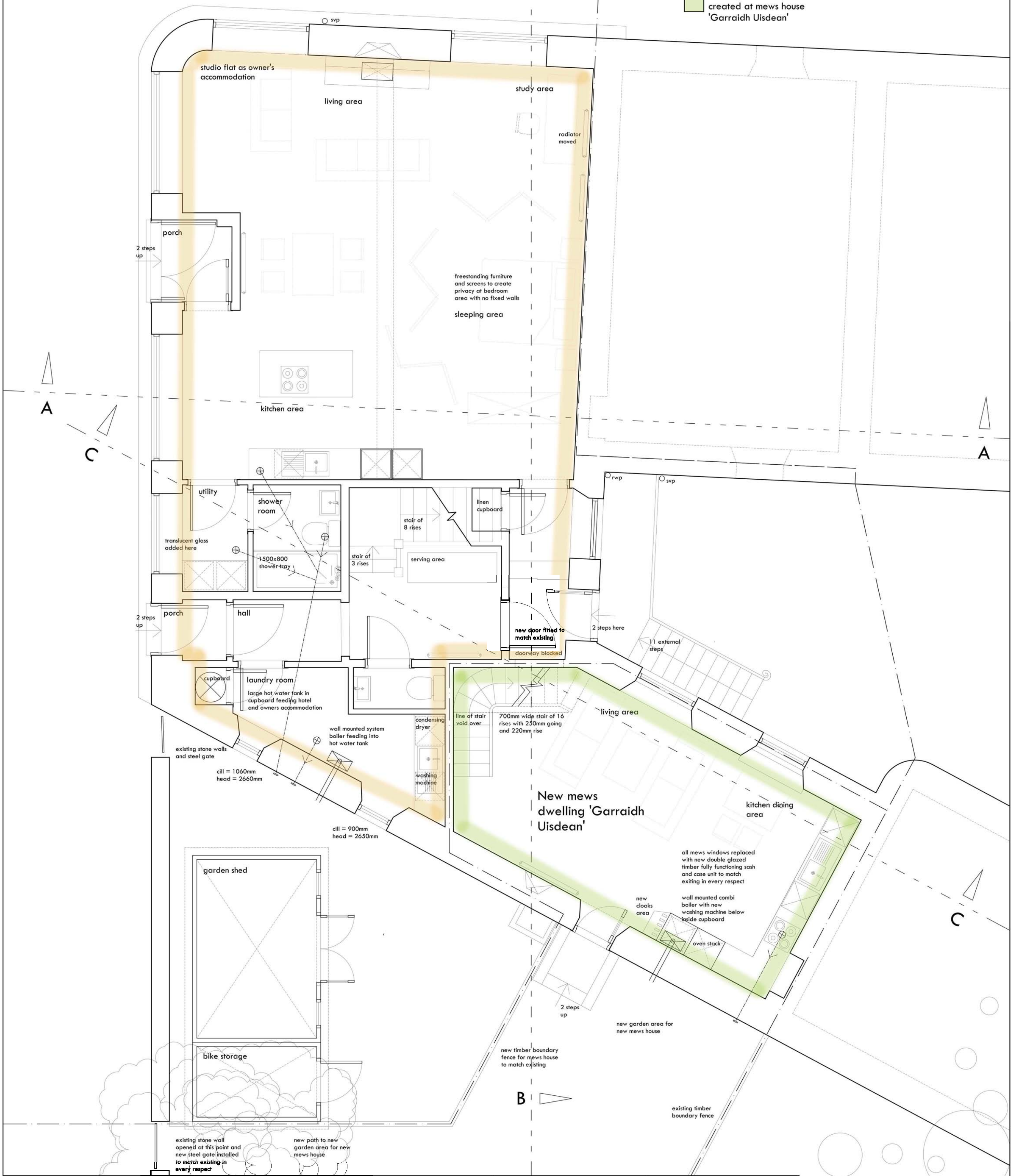

notes

do not scale from the drawing for any construction purpose

any discrepancies to be reported to the architect immediately

the property is hotel in a three storey traditional stone building

drawing to be read in conjunction with structural engineer's details and specification

revisions	
A	01/12/2020 updated for formal planning kitchen adjusted AMW
B	06/01/2021 updated to add door at reception area AMW

revisions	

project

ALTERATIONS AND CONVERSION AT THE MERRYBURN HOTEL, BIRNAM, PERTSHIRE

client

HILARY RENNIE AND DEIRDRE MORRISON

drawing title	
GROUND FLOOR PLAN AS PROPOSED	
drawing no.	scale
211B	1:50@A2
drawn by	date
AMW	SEP 2020

116 shakespeare street glasgow G20 8LF

0141 628 5557

mail@lucidarchitecture.co.uk
www.lucidarchitecture.co.uk