

General Notes
This drawing is to be read in conjunction with all relevant design team specifications and drawings. All dimensions are to be checked on site prior to commencement of work any discrepancies reported to the Project Architect. All materials and components are to be handled, stored, protected, installed and finished strictly in accordance with the manufacturer's recommendations.
Copyright RK Architectural Services Limited

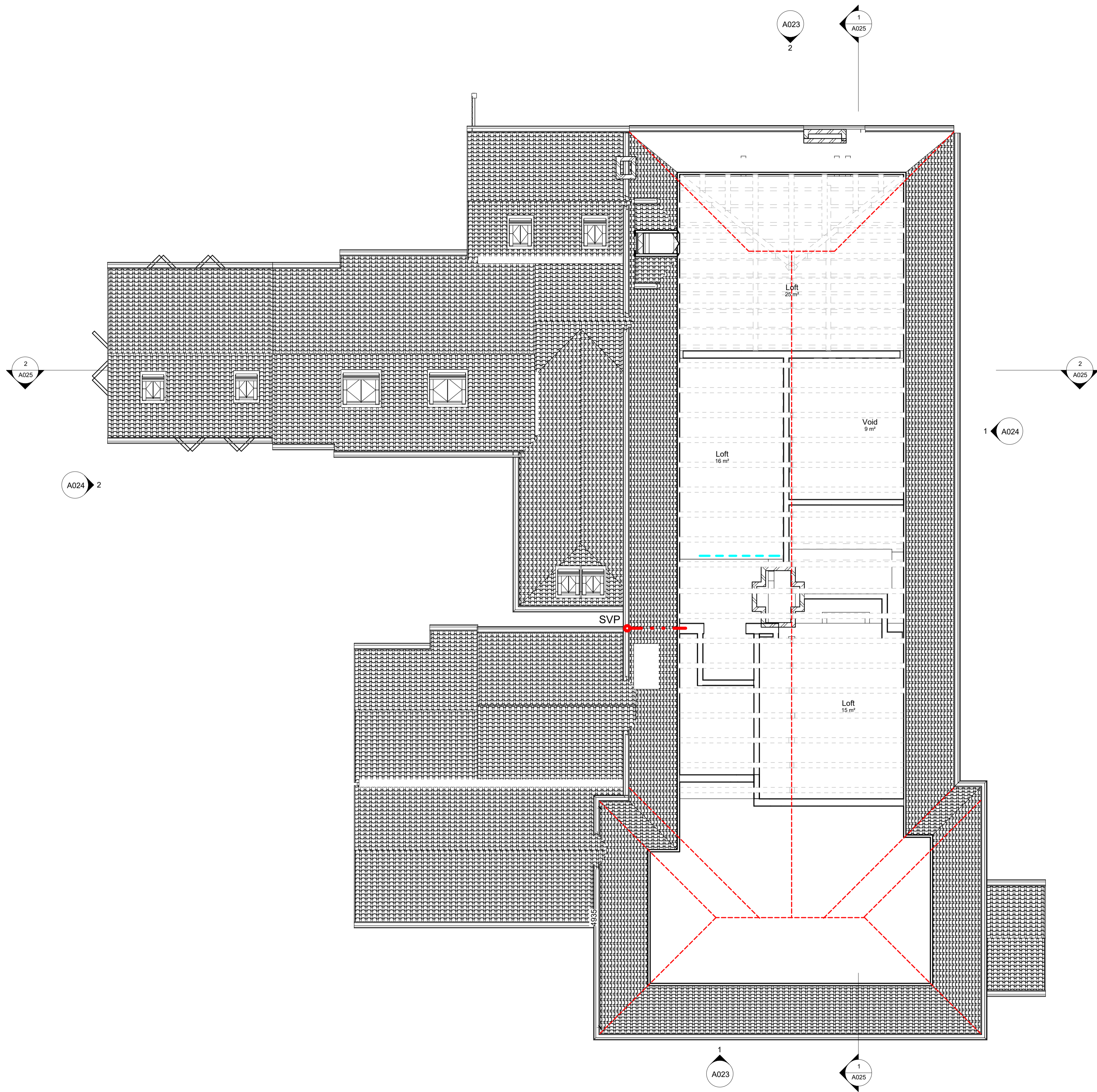

1 Proposed Loft Floor Plan
1 : 50

Planning Application

REV	DATE	DESCRIPTION	INITIALS
Client			
James & Debbie Lown			
Project title			
Yew Tree Cottage - Shipbourne			
Project address			
Yew Tree Cottage Upper Green Road Shipbourne, Tonbridge - TN11 9PL			
Drawing title			
Proposed 2F Plan			
Date			
Oct 2020		Drawing scale 1:200 @ A1, 1:400 @ A3	
Project number RKAV-225		Drawing number A 014	
Revision			
Drawn by RCK		Authorised by	
Drawing status Planning Application			
Richard Kostyrka 07889861587		www.rkas.co.uk info@rkas.co.uk	