

PLEASE NOTE THAT THIS DESIGN IS FOR PLANNING PURPOSES

PLEASE NOTE THAT ADDITIONAL
SUPPORT STRUCTURE WILL NEED
TO BE PROVIDED ABOVE THE ROOF
TO ALLOW SUPPORT OF THE FLUE.

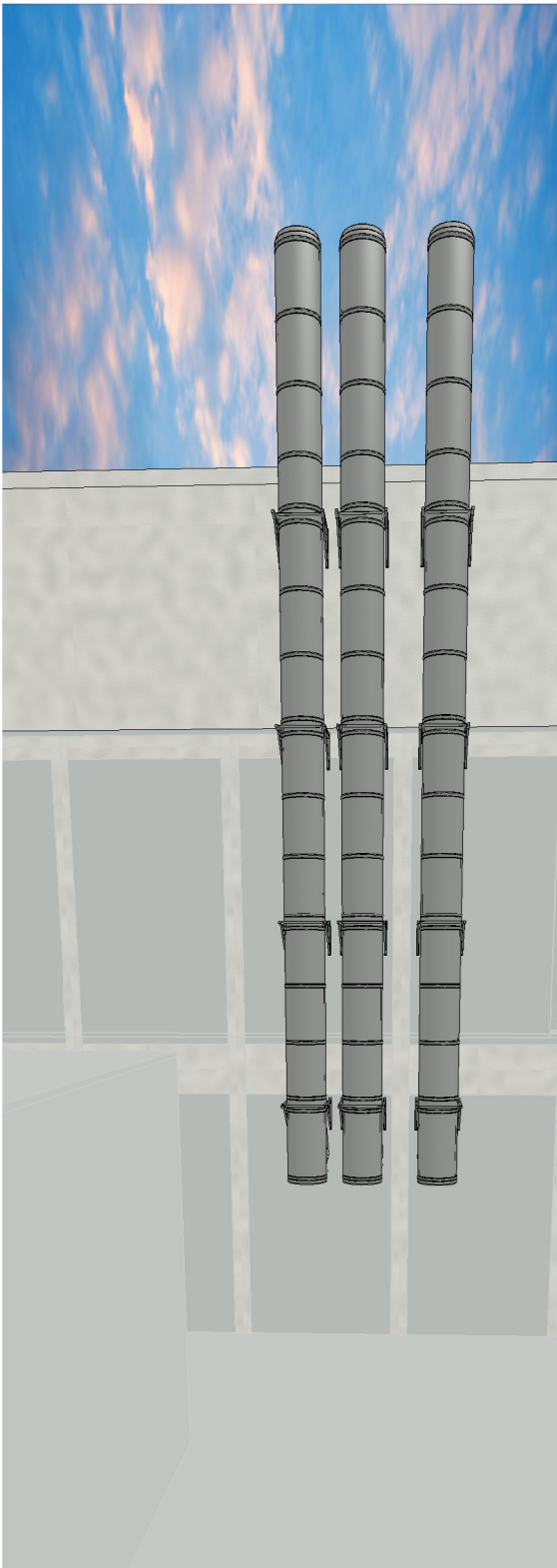
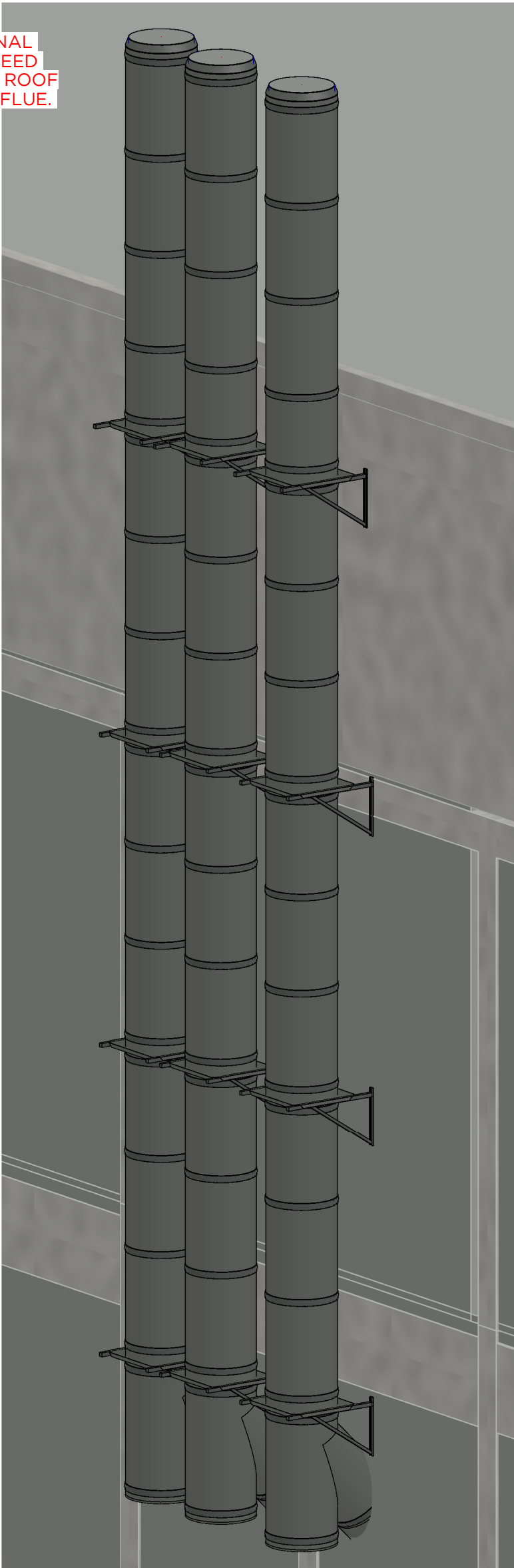
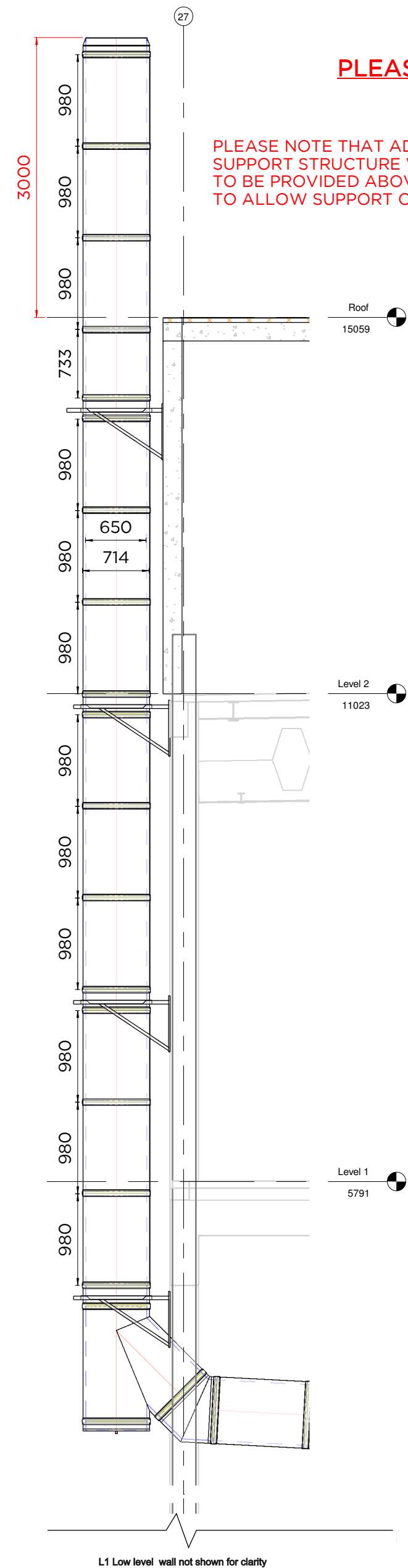

1

Section 1
1 : 50

CONTRACTS EXCLUSION/STANDARD NOTES

All builders work - Internal/External

All scaffolding and/or access equipment over 3 metres in height to be supplied by the client at the time of installation

If the flashing/s are to be supplied by JEREMIAS UK LTD. All roof openings and weathering by the clients roofing contractor at the time of installation. If storm collar is removed after our visit , and found to leak at a later date we shall not be held responsible.

JEREMIAS UK LTD accept no responsibility for any services or fittings installed between our site survey and installations which obstruct the flue run,the supports or installation access.

JEREMIAS UK LTD are not responsible for any electrical wiring to our installed equipment.

Any notes contained on this drawing concerning removal of pipes, cable tray's etc. must be adhered to prior to our installation.

Pipework from drain points. All drains within the system will require pipe work by others to gulleys.

For all termination heights and final position of our flue systems, you must seek approval from the relevant local Environmental officer, in line with the current regulations using either Clean Air Act (and memorandum)/LAQM (09/DI Ministry of Pollution dependant on the appliances being selected for the project. We at Jeremias are not responsible for sourcing the necessary approvals, we can only presume at the time of this tender, it has obtained already by the professional team.

We presume the building structure is capable of taking all the necessary imposed loads of the expansion devices/lateral load/weight bearing brackets.

Upon receipt of drawing approval, manufacture will proceed in accordance with the details and dimensions shown on this drawing. It is the clients responsibility to ensure that the flue route is kept clear from obstruction by other services. Please ensure that this drawing is issued to your site contract manager.

Please ensure this flue route is passed on to your appliance manufacturer to avoid any issues at commissioning and to ensure that the proposed flue route is suitable for the appliance/s. By design we can prove that this flue system works within the appliance characteristics available in their literature, however information is not always available within their literature for every eventuality/site conditions for the flue route. If they decline to comment (saying they are not flue specialists) and there is an issue at commissioning stage, then any costs for recommendations by themselves to correct the flue system will be passed onto yourselves.

Without confirmation/comments we will not proceed with manufacture.

2

3D

SPECIFIC PROJECT NOTES

Please note their will be signs of plumbing on this type of system at the flue outlet.

ADDITIONAL ITEMS			
Quantity	Description	Type	Diameter





Rev	Description	Date	By	
Preliminary	For Approval	X	Construction	As Constructed

3

3D View 1

Drawing No.
17972 - 001

System Materials:
Boiler Flue (External): TW FS 316/304: Twin Wall
Flanged Chimney System



Drawn By:
D.Henderson

Date:
26/11/2020

Title:
Thermo Fisher Science External

Customer:
Megan Mechanical Services Ltd

Project:
Thermo Fisher Science

Site Address:
Kingfisher Drive
Swindon
SN3 5BZ