

**Changing Room Finishes:**

Floor Finish - Spike resistant homogenous sheet or carpet.  
 Wall Finish - Painted brick, block-work or plaster. Alternative homogenous hygienic sheet.  
 Ceiling Finish - Painted plaster. Suspended ceilings with modular tiles are not recommended for ceiling heights lower than 2.7m. If used, tiles must be humidity resistant.  
 Skirting - Optional

**Shower and Drying Area Finishes:**

Floor Finish - Sheet safety flooring with welded joints or non-slip floor tiles, laid to fall towards the floor drain.  
 Wall Finish - Homogenous waterproof sheet or ceramic tiles.  
 Ceiling Finish - Painted plaster. Suspended ceilings with modular tiles are not recommended for ceiling heights lower than 2.7m. If used, tiles must be humidity resistant.  
 Skirting - Coved skirting forming a waterproof joint between floor and wall.

**Toilet Finishes:**

Floor Finish - Sheet safety flooring with welded joints, preferably spike resistant.  
 Wall Finish - Minimum requirement is painted brick or block-work with tiled splash-back over washbasins and behind urinals. Preferred finish is if funds are available is homogenous waterproof sheet or ceramic tiles.  
 Ceiling Finish - Painted plaster. Suspended ceilings with modular tiles are not recommended for ceiling heights lower than 2.7m. If used, tiles must be humidity resistant.  
 Skirting - Coved skirting forming a waterproof joint between floor and wall. Concealed pipes and WC cisterns are preferred if funds are available.

**Circulation Finishes:**

Floor Finish - Spike resistant homogenous sheet or carpet in areas expected to be used by players.  
 Wall Finish - Painted brick, block-work or plaster.  
 Ceiling Finish - Painted plaster. Suspended ceilings with modular tiles are not recommended for ceiling heights lower than 2.7m.  
 Skirting - Optional

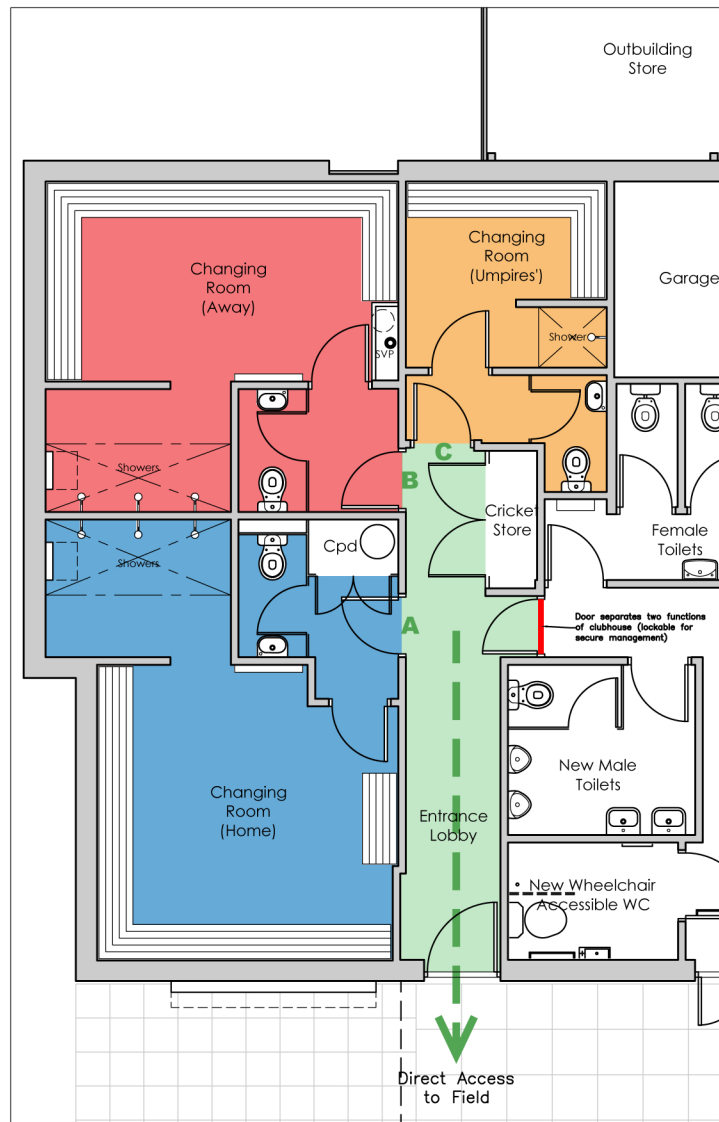

Traditional Men's 1st/2nd XI Fixture  
 (Also Women's Hardball/W10 Fixture)

ECB GUIDANCE: Umpires must have separate changing and shower facilities to the players. A lockable room with bench seating, coat and towel hooks suitable for two umpires with one shower, wc and wash-hand basin would be suitable for small clubs. Secure storage for valuables should be provided, possibly in the form of a lockable cupboard. A view of the pitch is desirable.

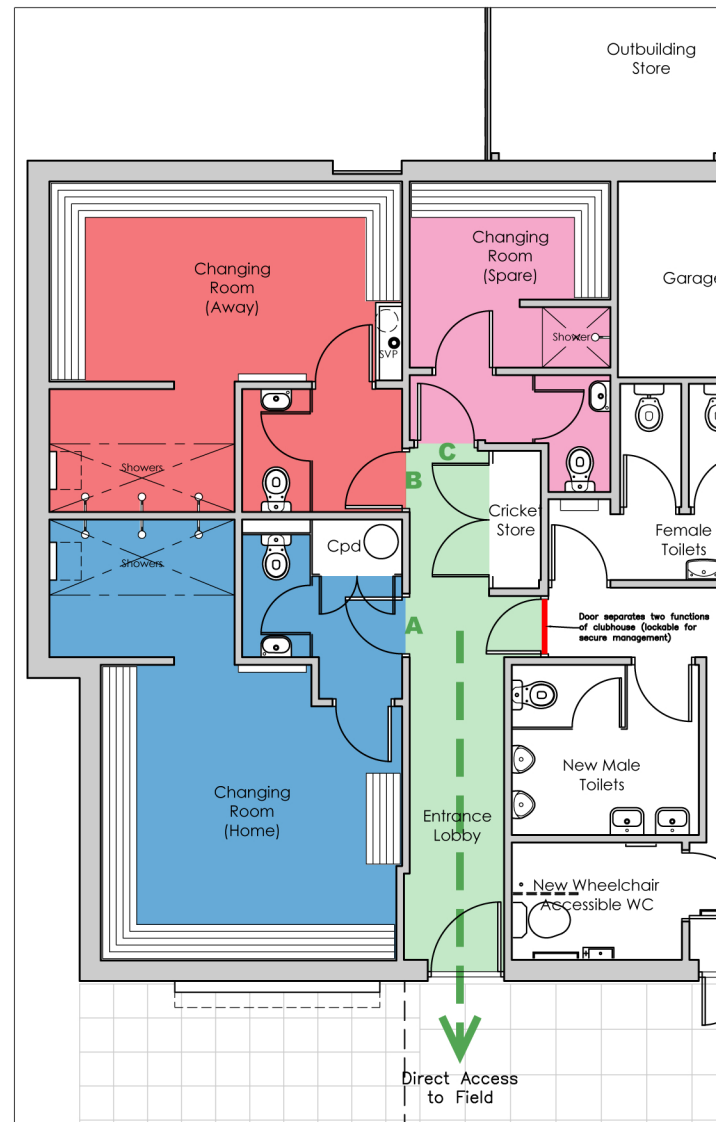

Typical Men's Adult Fixture with a  
 Female Player Involvement

ECB GUIDANCE: The pavilion should provide flexibility for different cultures, mixed gender teams and junior players. Suitable changing facilities can usually be accommodated by carefully programmed use of the team and umpires changing rooms.

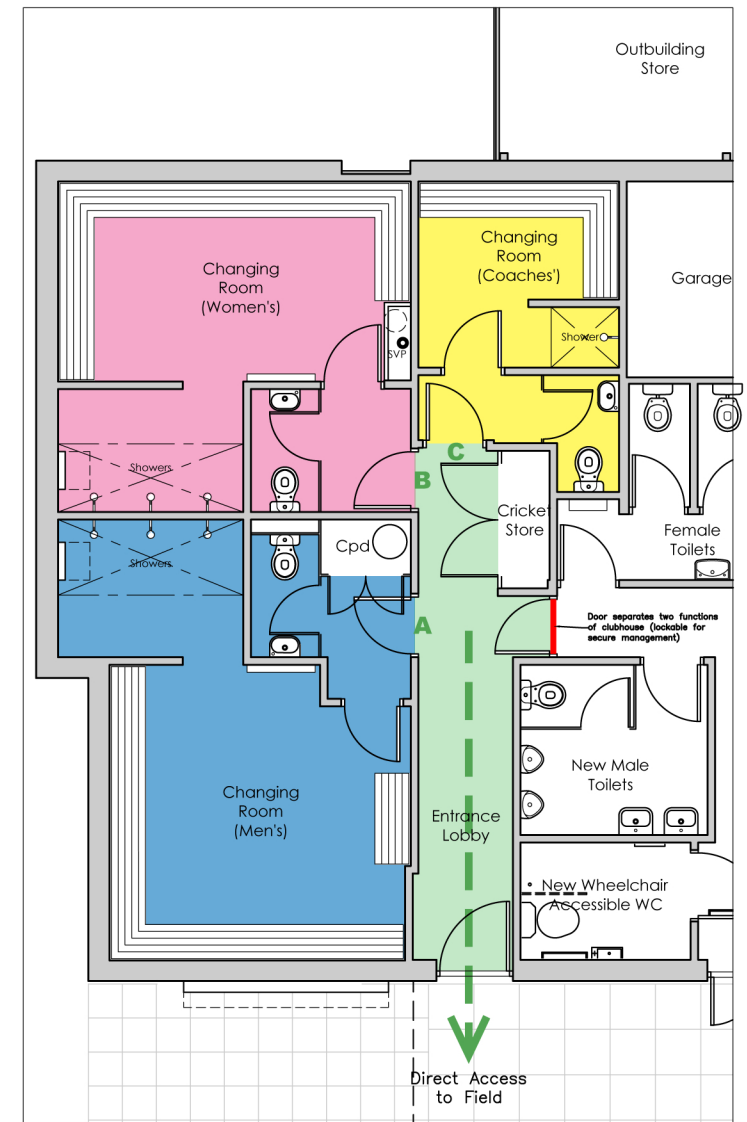

Typical Training Evening with Mixed  
 Gender Participation

**Examples of Flexible Changing Facilities**

Additional Small Changing Room and Shower gives Greater Options

