

H. M. LAND REGISTRY

NATIONAL GRID PLAN

SJ 2992

SECTION G

~~CHESHIRE~~

Scale 1/1250

COUNTY OF MERSEYSIDE
WIRRAL DISTRICT

~~WIRRAL COUNTY BOROUGH~~

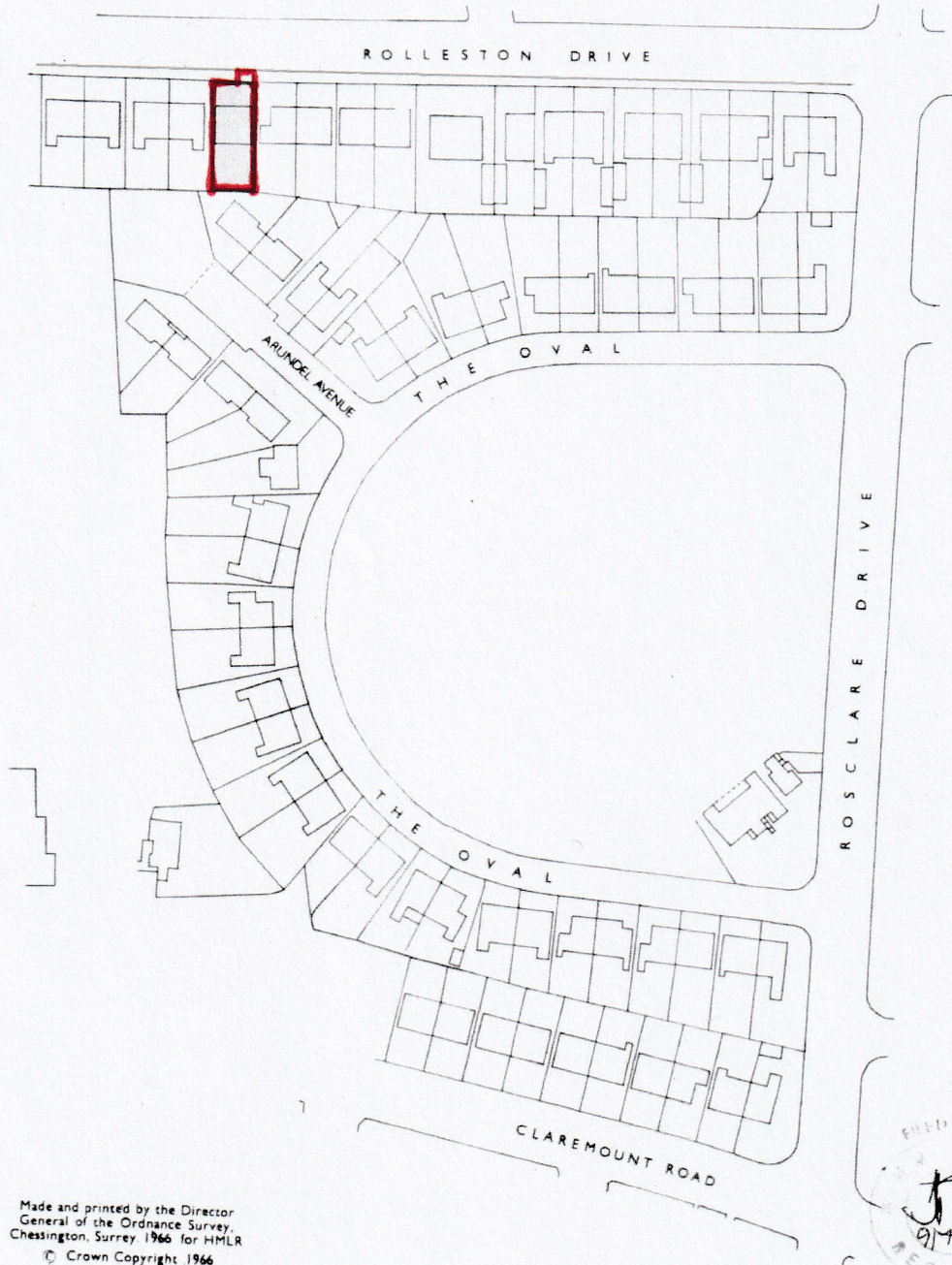
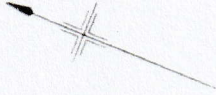

Made and printed by the Director
General of the Ordnance Survey,
Chessington, Surrey 1966 for HMLR
© Crown Copyright 1966

TITLE No. MS 5076

This is a copy of the title plan on 29 JUN 2020 at 19:15:44. This copy does not take account of any application made after that time even if still pending in HM Land Registry when this copy was issued.

This copy is not an 'Official Copy' of the title plan. An official copy of the title plan is admissible in evidence in a court to the same extent as the original. A person is entitled to be indemnified by the registrar if he or she suffers loss by reason of a mistake in an official copy. If you want to obtain an official copy, the HM Land Registry web site explains how to do this.

HM Land Registry endeavours to maintain high quality and scale accuracy of title plan images. The quality and accuracy of any print will depend on your printer, your computer and its print settings. This title plan shows the general position, not the exact line, of the boundaries. It may be subject to distortions in scale. Measurements scaled from this plan may not match measurements between the same points on the ground.

This title is dealt with by HM Land Registry, Birkenhead Office.

© Crown Copyright. Produced by HM Land Registry. Further reproduction in whole or in part is prohibited without the prior written permission of Ordnance