

EXISTING GROUND FLOOR PLAN
SCALE 1:100

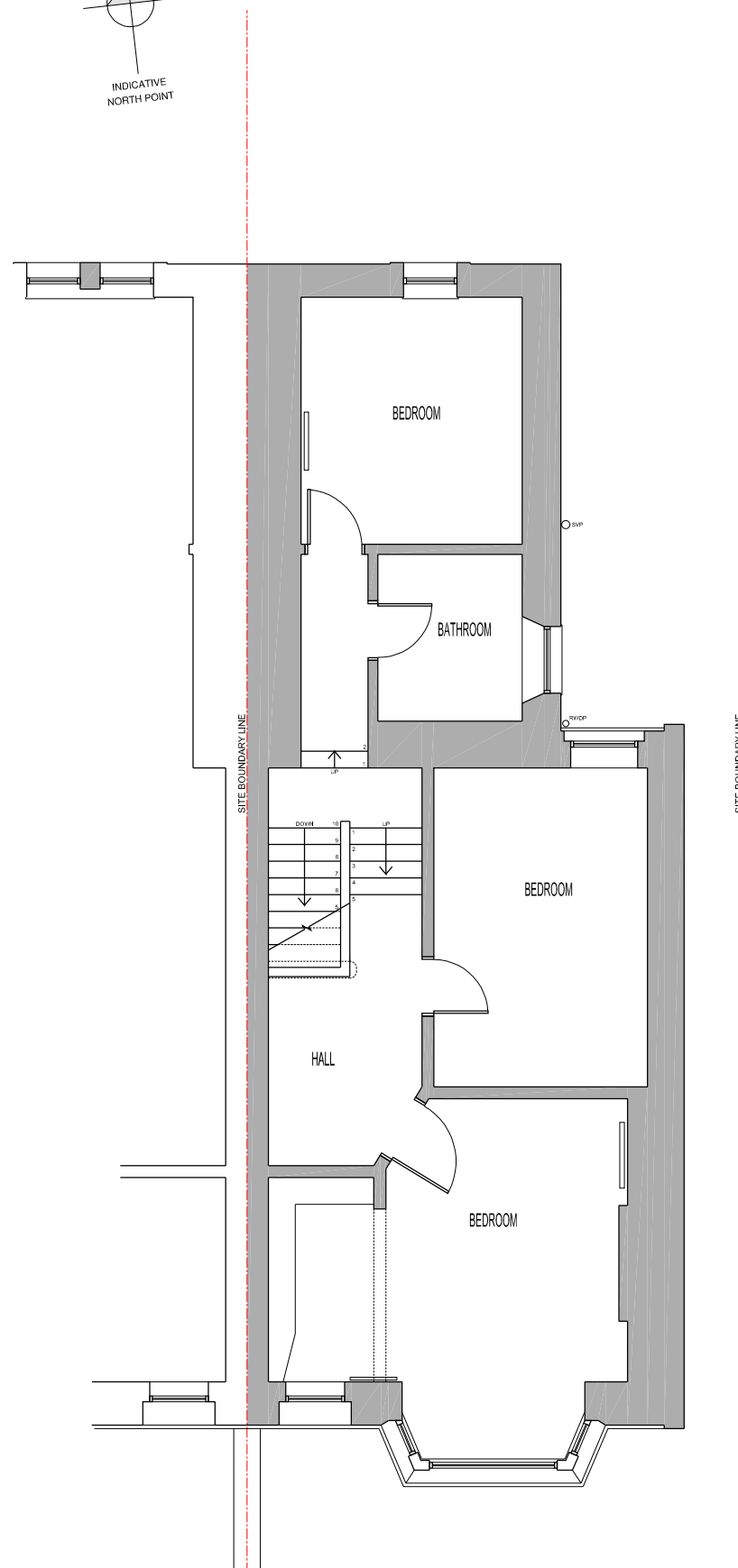

EXISTING FIRST FLOOR PLAN
SCALE 1:100

PROJECT DETAILS

Proposed Extension and Alterations at
32 Dorward Road, Montrose.
DD10 8SB

APPLICANT
Mr Jonathan Duncan

DRAWING TITLE
Existing Ground & First Floor Plans

DRAWING NUMBER
EX002

SCALE
as shown @ A3

DATE
August 2020

REVISIONS

NOTES

ALL SIZES TO BE CHECKED BY CONTRACTOR PRIOR TO START OF BUILDING WORKS.

DRAWING FOR STATUTORY PURPOSES ONLY. ALL SIZES SHOWN ARE INDICATIVE.

DO NOT SCALE DIRECTLY OFF THE DRAWING.

----- EXISTING SITE BOUNDARY

EXISTING SITE AREA = approx. 306m²

EXISTING BUILDING FOOTPRINT = 76m²

EXISTING WALL