

- Notes
1. THIS DRAWING TO BE READ IN CONJUNCTION WITH ALL OTHER RELEVANT ENGINEERS AND SPECIALISTS DRAWINGS TOGETHER WITH THE APPROPRIATE SPECIFICATION.
  2. IT IS THE CONTRACTOR'S RESPONSIBILITY TO CHECK ALL DIMENSIONS ON SITE.
  3. DIMENSIONS MUST NOT BE SCALED FROM THIS DRAWING. ANY DISCREPANCIES TO BE BROUGHT TO THE IMMEDIATE ATTENTION OF THE ENGINEER IN WRITING.
  4. ALL DIMENSIONS ARE IN MILLIMETRES, UNLESS NOTED OTHERWISE.
  5. ALL LEVELS ARE IN METRES, UNLESS NOTED OTHERWISE.

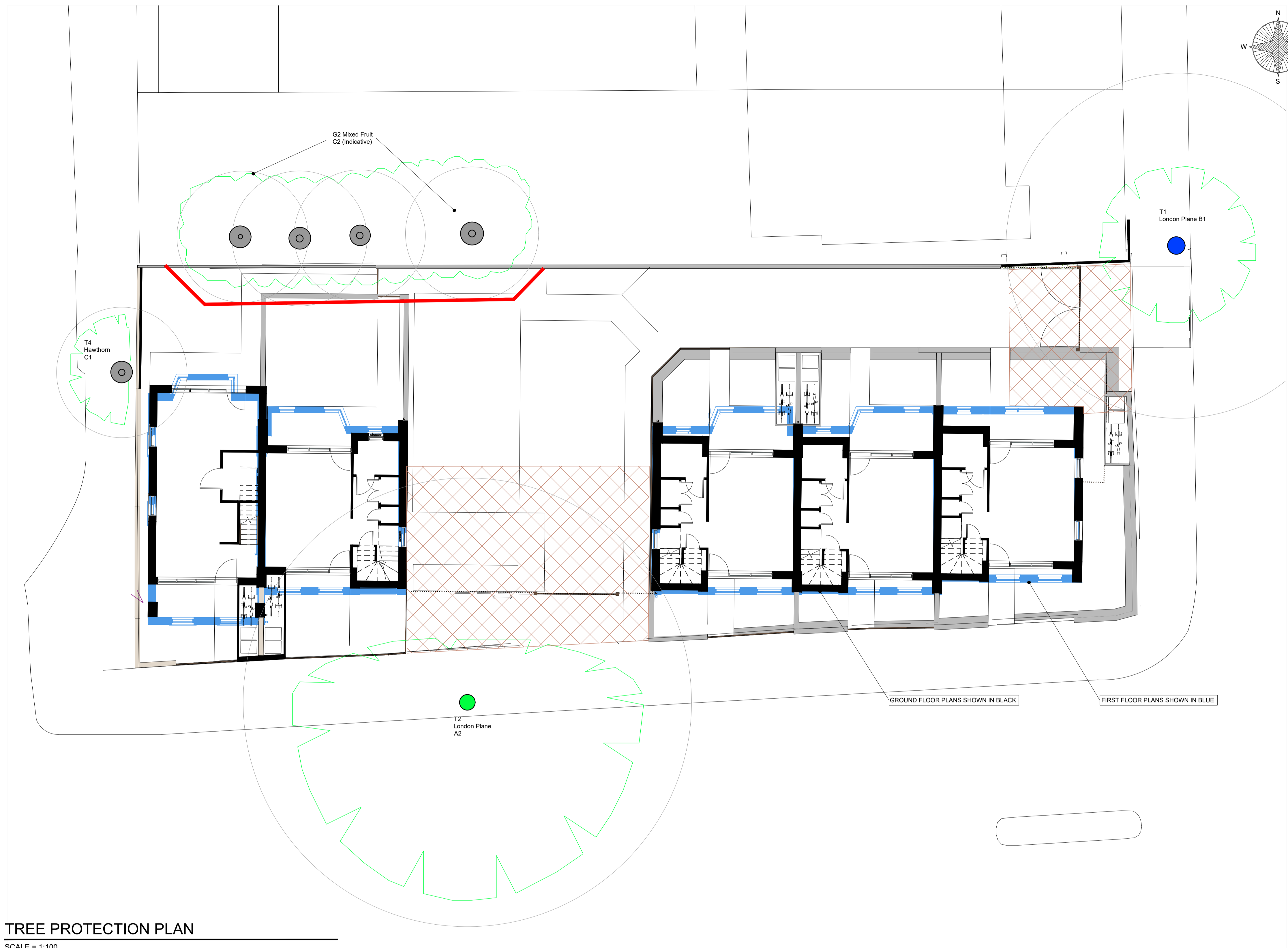

### TREE PROTECTION PLAN

SCALE = 1:100

DRAWING TO BE READ IN CONJUNCTION WITH SILVAN ARB REPORT REF: SA/1719/20

NOTE: Trees to be removed are not shown in order to clarify tree protection requirements. Refer to the Tree Removal Plan for details of trees to be removed.

Key:



Retained Tree



Root Protection Area



Tree Protection Fencing  
Braced Heras Panels  
(See Sylvanarb Appdx. C for specification)



Temporary Ground Protection  
Existing hard surfacing & building floor slab to be retained throughout duration of main superstructure phase. To then be removed and replaced with permeable surfacing within the depth of the existing sub-base.

NOTE: No roots of 25mm diameter or greater to be severed/removed during works on site. Where such roots are encountered, excavations are to cease and further arboricultural advice be sought.

Rev	Date	By	Description	Appd
P1	13-01-21	SM	Issued for Information	SM

PRELIMINARY



**Tier Consult Ltd.**  
Richmond House  
Sandpiper Court  
Chester Business Park  
Chester | CH4 9QZ  
t: 01244 684900

Client



Project  
**GRANVILLE MEWS, EAST FINCHLEY, LONDON**

Title  
**TREE PROTECTION PLAN**

Scale	Drawn	Revision
1:100@A1	SM	P2
Date	Checked	
Jan'21	SM	

Drawing Ref:  
Project no/Originator/Volume/Level/Type/Role/Number

T/20/2344

80-200