

- NOTES
1. ALL DIMENSIONS ARE IN METRES UNLESS NOTED OTHERWISE.
 2. ALL CO-ORDINATES ARE TAKEN FROM ORDNANCE SURVEY INFORMATION.
 3. DRAWING TO BE READ IN CONJUNCTION WITH 602488-DRG-4001 LOCATION PLAN AND 602488-DRG-4003 SECTIONS

- LEGEND
- AREA SUBJECT TO PLANNING PERMISSION 4,512m²
 - PROPOSED ACCESS ROUTE

SITE GRID REFERENCE - NS 81549 79583

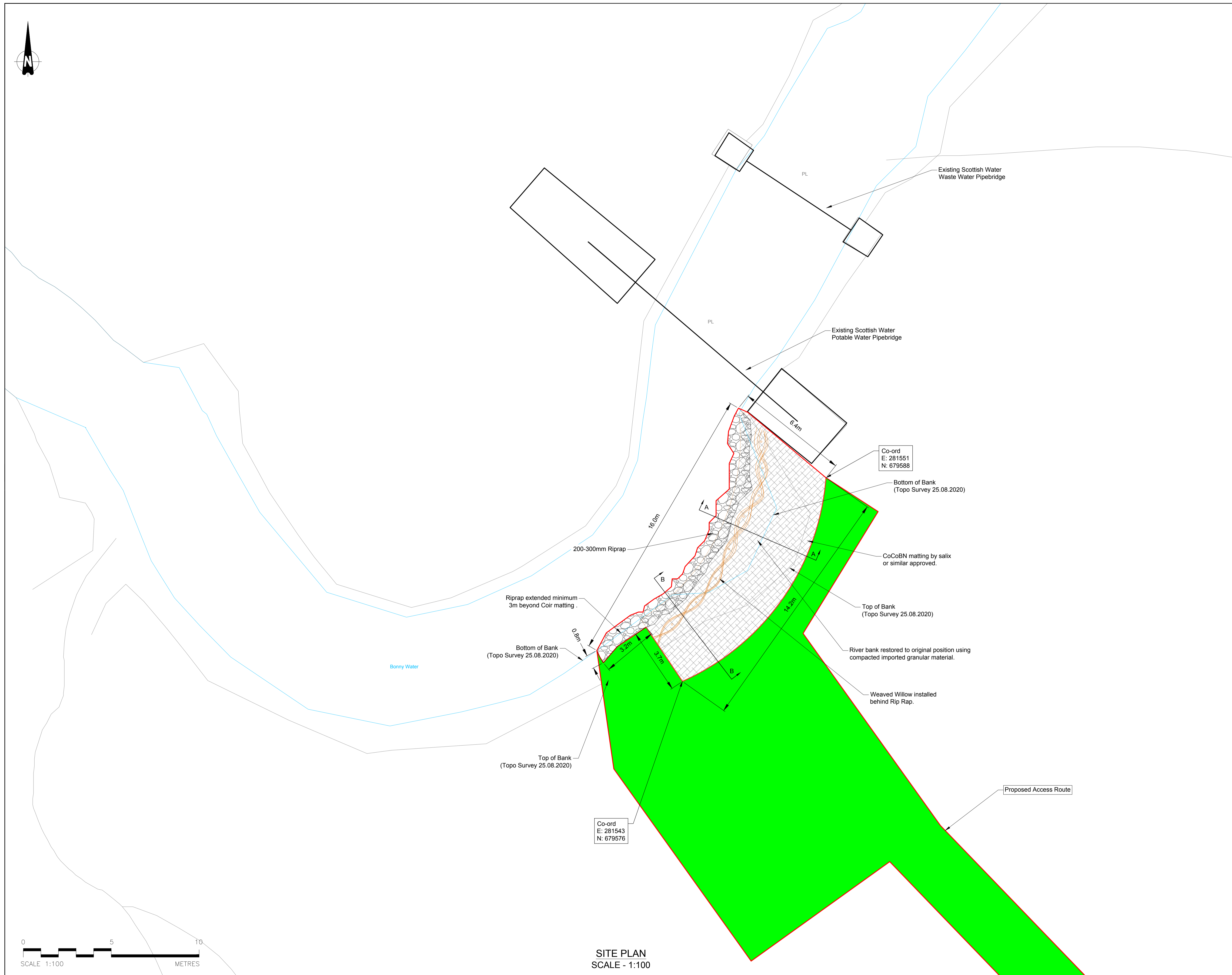

Rev	Description	Drawn	Chk'd	App'd	Date
0C	Access extended, existing pipebridges marked	DY	MY	MY	14.12.20
0B	Updated access route	DY	MY	MY	08.12.20
0A	First issue	DY	MY	MY	15.10.20

This drawing is the property of Scottish Water and must not be copied or used for any purpose other than that for which it is supplied without the written consent of Scottish Water.

Scottish Water
Trusted to serve Scotland

SCOTTISH WATER
CASTLE HOUSE
6 CASTLE HOUSE
CARNEGIE CAMPUS
DUNFERMLINE
FIFE KY11 8GG
TEL: 01383 848200
FAX: 01383 848371

Originated By	Drawn By	Checked By	Approved By
SMcS	DY	MY	MY
Date	Date	Date	Date
27.08.2020	15.10.2020	15.10.2020	15.10.2020
Scale	Status		
As Shown	For Information		

Project Title
Bonnybridge River Bank Erosion

Drawing Title
Planning Drawing Site Plan

ELLIPSE EQUIPMENT No.
ELLIPSE PLANT No. AUTOCODE No.

Drawing No.
602488-DRG-4002

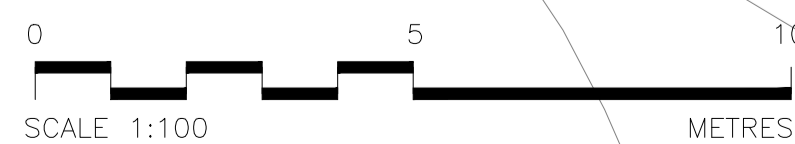

**SITE PLAN
SCALE - 1:100**