

1. Shaded outline of 600w foundations under
2. Wall mounted fan with min. 30 litre/sec extract rate
3. Above ground drainage to BS EN12056.
4. Oak framing to porch consisting of 150 x 150 selected oak butt jointed with 10 ms dowel fixings. Rawlbolt plates to masonry at nmt 600c/c
5. New custom made French casements (2 x 686 leaves) under Catnic lintel with sudg safety glazing
6. New custom made window with sudg safety glazing under lintel to be specified by structural engineer
7. Reposition gully as required to existing outfall
8. Form new opening; lintel to be specified by structural engineer
9. Line external walls with 75 + 9 Gyproc Thermalboard combined PIR insulation and plasterboard with skim plaster finish all to makers recommendations
10. Existing bridging beams over supporting longitudinal ceiling joists
11. Outline of partitions to be removed. Check on site to ensure non loadbearing
12. Cooker hood over with min 60 litre/sec extract rate.
13. Carefully remove tiled floor and replace to clients requirements to enlarged kitchen
14. Join new work to existing with stainless teel profiles. Ensure continuity of cavity where possible. Do not run new foundations under existing
15. 100 Osma PVCU pipework at 1:40 falls to makers recommendation for medium loading to min. 1.5 cu.m. soakway nly 5.0m from structures

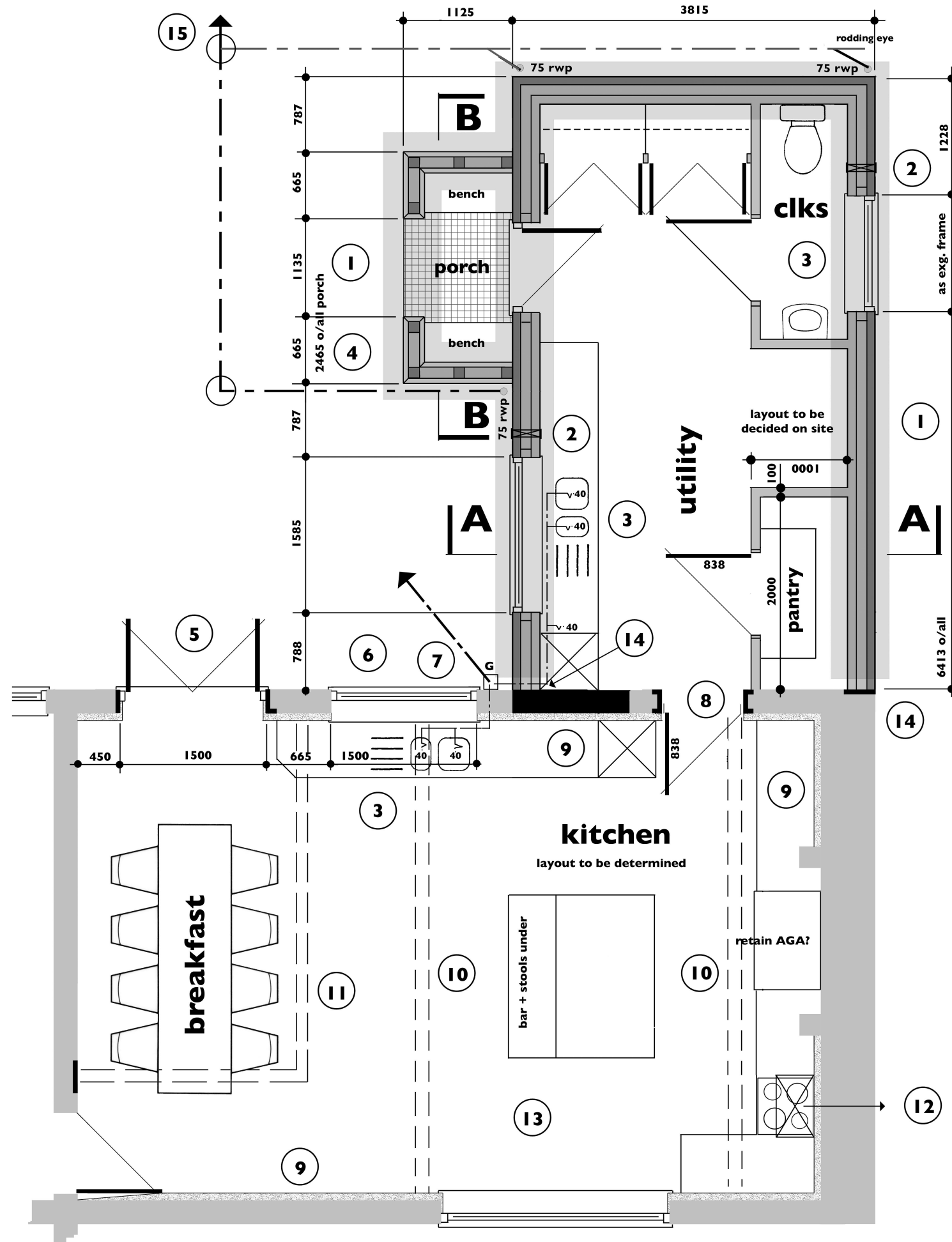

**Replacement  
Side Extension  
at Willow Farm  
School Road  
Bedingham  
for Alison and  
Deane Binks**

**Ground Floor Layout  
Proposed  
Scale: 1:50 at A3  
Drg.No.2182.6  
17Dec20**

**JOHN PUTMAN**  
ARCHITECTURAL DESIGN + PLANNING  
The Hollies :: Station Road :: Earsham  
Bungay :: Suffolk :: NR35 2TS  
johnputman1@btconnect.com :: 01986 892454

**:: Part Ground Floor Layout :: Proposed :: 1:50 at A3 ::**