

SIDE VIEW

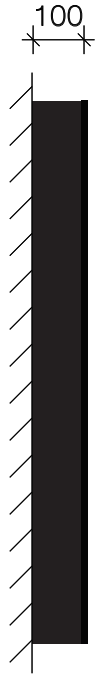

FACE VIEW



SECTION VIEW OF ROOF BLADE SIGNAGE

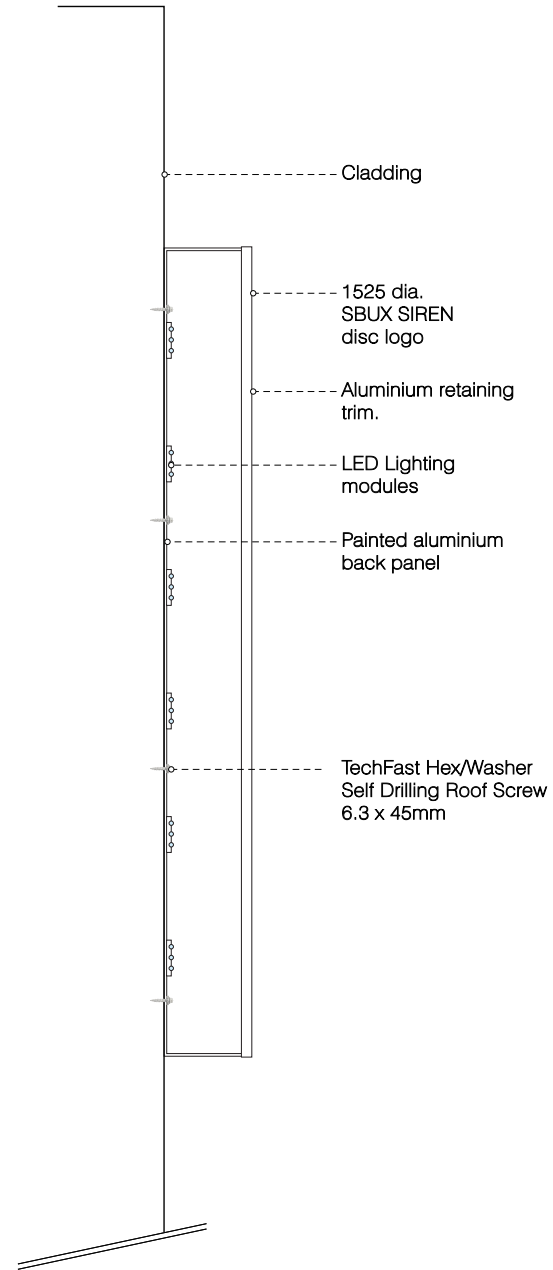

ILLUMINATED 1525 ROUNDEL SIGNS

Illuminated Starbucks siren logo constructed from built-up aluminium finished RAL9005 matt with 3mm thick 050 opal acrylic faces decorated with 'Holly Green' translucent vinyl logo as detailed above, panel fixed to carcass with an aluminium trim also finished RAL9005.

2 off required.

ALL DIMENSIONS TO BE CHECKED ON SITE.
DO NOT SCALE FROM THIS DRAWING EXCEPT FOR THE PURPOSES OF LOCAL AUTHORITY PLANNING

| rev | date | description |
|-----|------|-------------|
| - | - | - |

avonsigns
Unit 8, St. Georges Business Park, Lower Cape, Warwick, CV34 5DR
Tel: (01926) 888226 - Fax: (01926) 888561

client
STARBUCKS

store address

drawing title
**PROPOSED
1525 Roundel Signs**

| | | |
|------------------------------|----------------------|---------------------------|
| drawn by A. Rajput | checked - | date 01.08.2018 |
| store no. - | scale 1:15 | status - |

drawing no.
Sheet 2

revision
-