

All levels and dimensions to be checked on site prior to construction / fabrication; report discrepancies immediately. Do not scale dimensions from this drawings. This drawing is copyright protected.

REVISIONS
 -- 05.01.21 ED First Issue

GENERAL NOTES:

- All works to comply with the Scottish Building Regulation 2004 as amended
- All products to be installed per manufacturer's recommendations
- All dimensions to be verified on site
- Refer to window schedule for sizes and locations
- Refer to window schedule and other tender drawings & schedules for finishes and ironmongery.

WINDOW TYPE B
 Redwood, slimlite double glazed sash and case window
 Glazing pattern to match existing

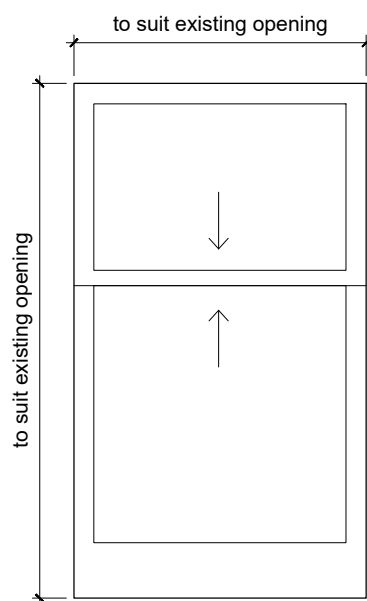

01 Elevation of Typical Window
 1:20

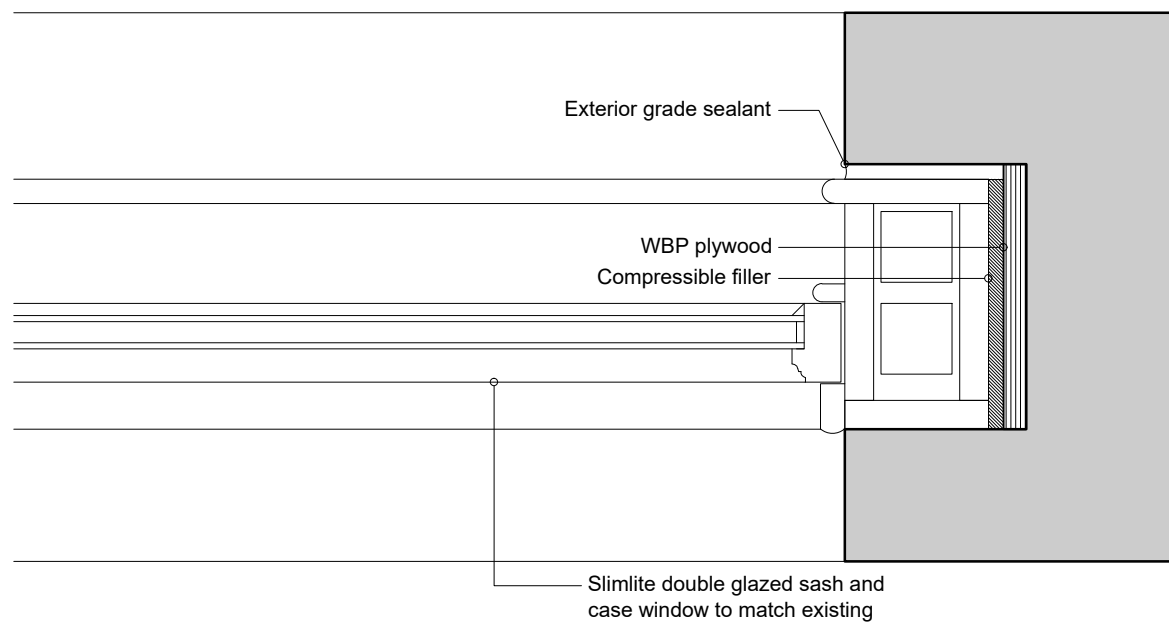

02 Window jamb details
 1:5

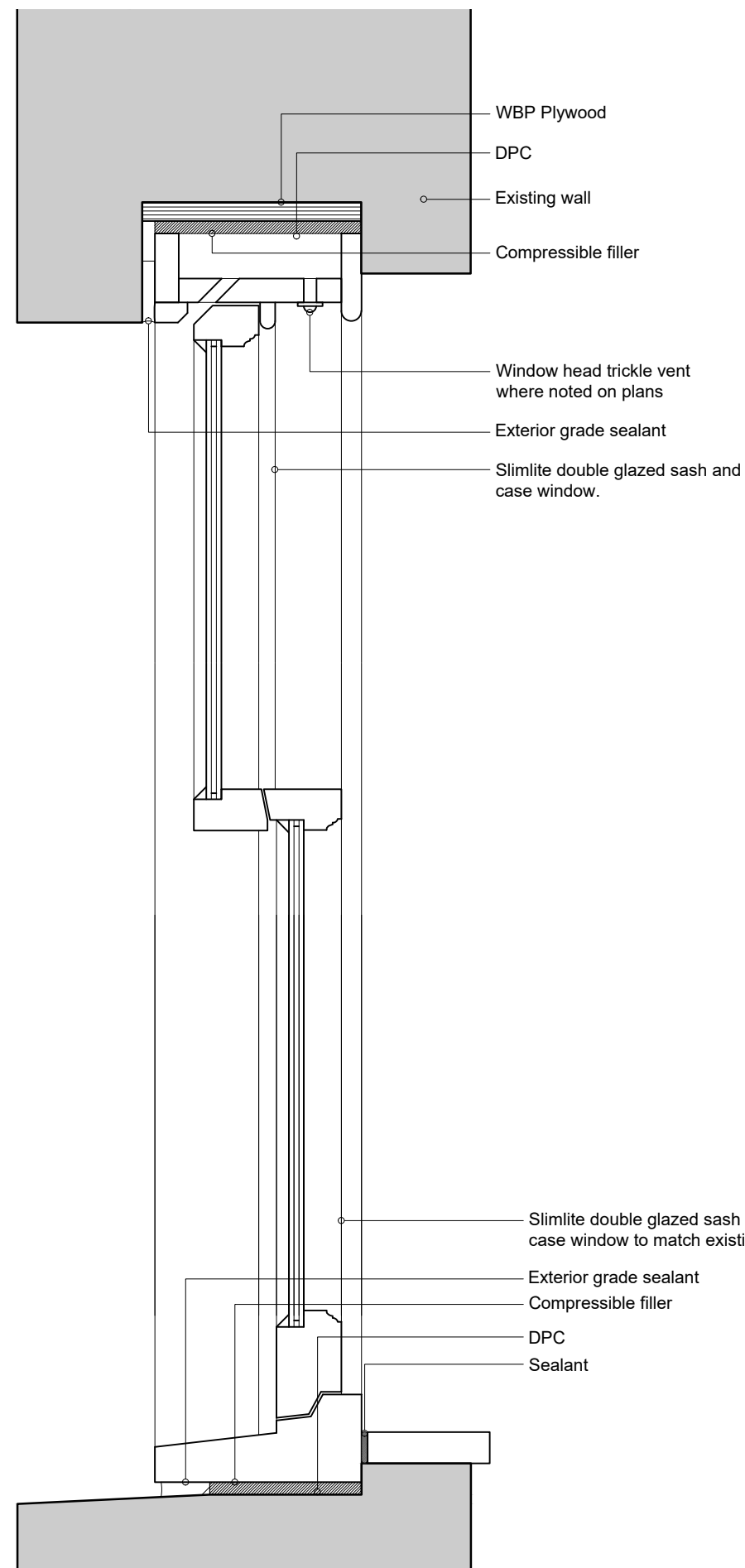

03 Window Section
 1:5