

Site location plan 1:1250

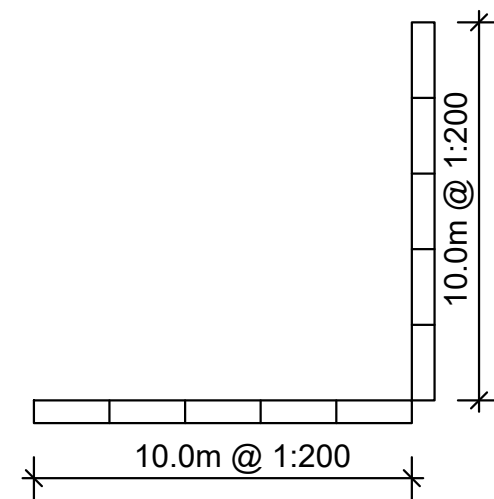

| Rev. | Description. | Date. |
|------|--------------|-------|
| | | |

AT Design (Welwyn) Ltd
 Architectural Design Services
 22 School Lane, Welwyn, Herts AL6 9PH
 Tel: 07931703297 - email: adamtrigg@hotmail.com

Title: Proposed front extension
 18 Eliot Road, Stevenage,
 Hertfordshire, SG2 0LH
 Site plan and location plan

Scale : 1:200 at A3
 Date : Jan 2021

Drawn by: AT

Drg.No: AT931-01