



KEY

- Site Boundary
- Proposed Paths
- Existing & Retained Trees
Root Protection Area [RPA] shown in orange, refer to arboricultural information for details
- Existing & Retained Hedgerows
Root Protection Area [RPA] shown in orange, refer to arboricultural information for details

Proposed Soft Works

- Specimen Trees
- Multistem Tree/Specimen Shrub
- Specimen Shrubs
- Native Mixed Hedgerows
- Ornamental Hedges
- Mixed Ornamental Beds (total=683m2)
- Groundcover Mixes (total = 410m2)
- Mixed Grass & Wildflower (total = 7192m2)
Seeded - sown to supplier's recommendations.
- Service Verges/Species-Rich Grass Mix (total = 5315m2)
Seeded - sown to supplier's recommendations.
- Amenity Grass (total = 4636m2)
Turf to front lawns, seeded elsewhere

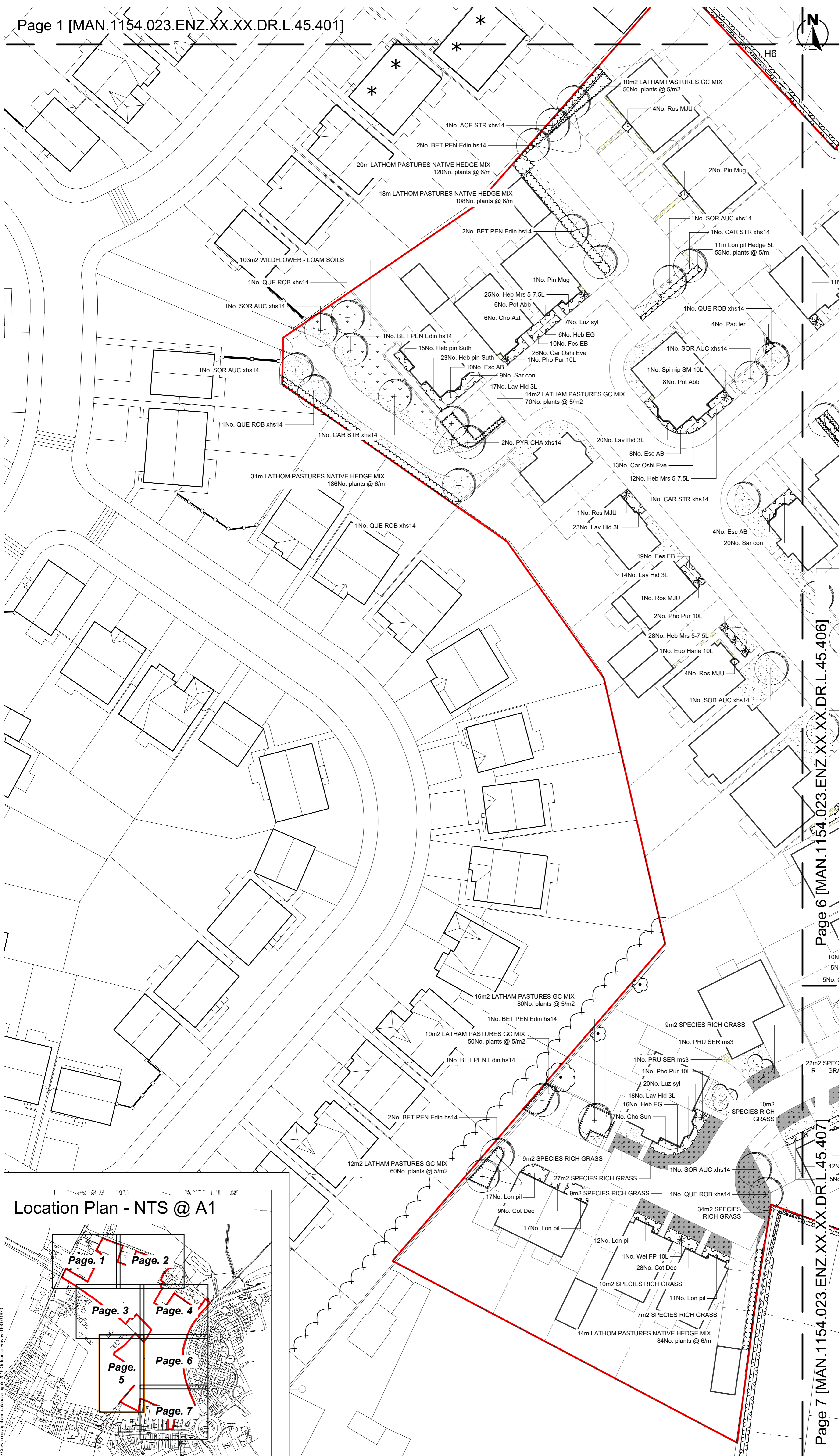

Page 6 [MAN.1154.023.ENZ.XX.XX.DR.L.45.406]

General Notes

- Drawing illustrates design intent, used for planning purposes
- This drawing is to be read in conjunction with all relevant drawings and documents associated with this project.
- All surveyed information including levels and layout is provided by others
- All existing and proposed dimensions, levels and locations to be checked and verified by the main contractor on site prior to the commencement of the works and any anomalies reported to the engineer.
- All planting adjacent to existing trees should be undertaken with supervision of appointed arboriculturalist.
- All listed products and seed mixes, to be installed to suppliers recommendations.
- Refer to Ecological Information for details of existing and retained habitat areas.
- Building foundations to be confirmed by engineer with reference to planting proposals and NHBC guidance or similar, where relevant.
- Refer to engineer's details for level and drainage information.

0m 5m 10m 15m

Rev	Date	Description	WH	CG	PB
			DRA	CHK	APP

Project
Phase 2, Lathom Pastures, Skelmersdale, Lancashire

Client
Bellway Homes (NW Division) Ltd.

Drawing Title
Planting Plan (Page 5 of 7)

Status	Date	Scale
Preliminary	December 2020	1:250 @ A1

Drawn	Designed	Checked	Approved
WH	WH	PB	PB

DWG No.	Revision
MAN.1154.023.ENZ.XX.XX.DR.L.45.405	PL01

enzygo
environmental consultants

BRISTOL 01454 289 237 www.enzygo.com
MANCHESTER 0161 413 6444
SHEFFIELD 0114 321 5151 hello@enzygo.com

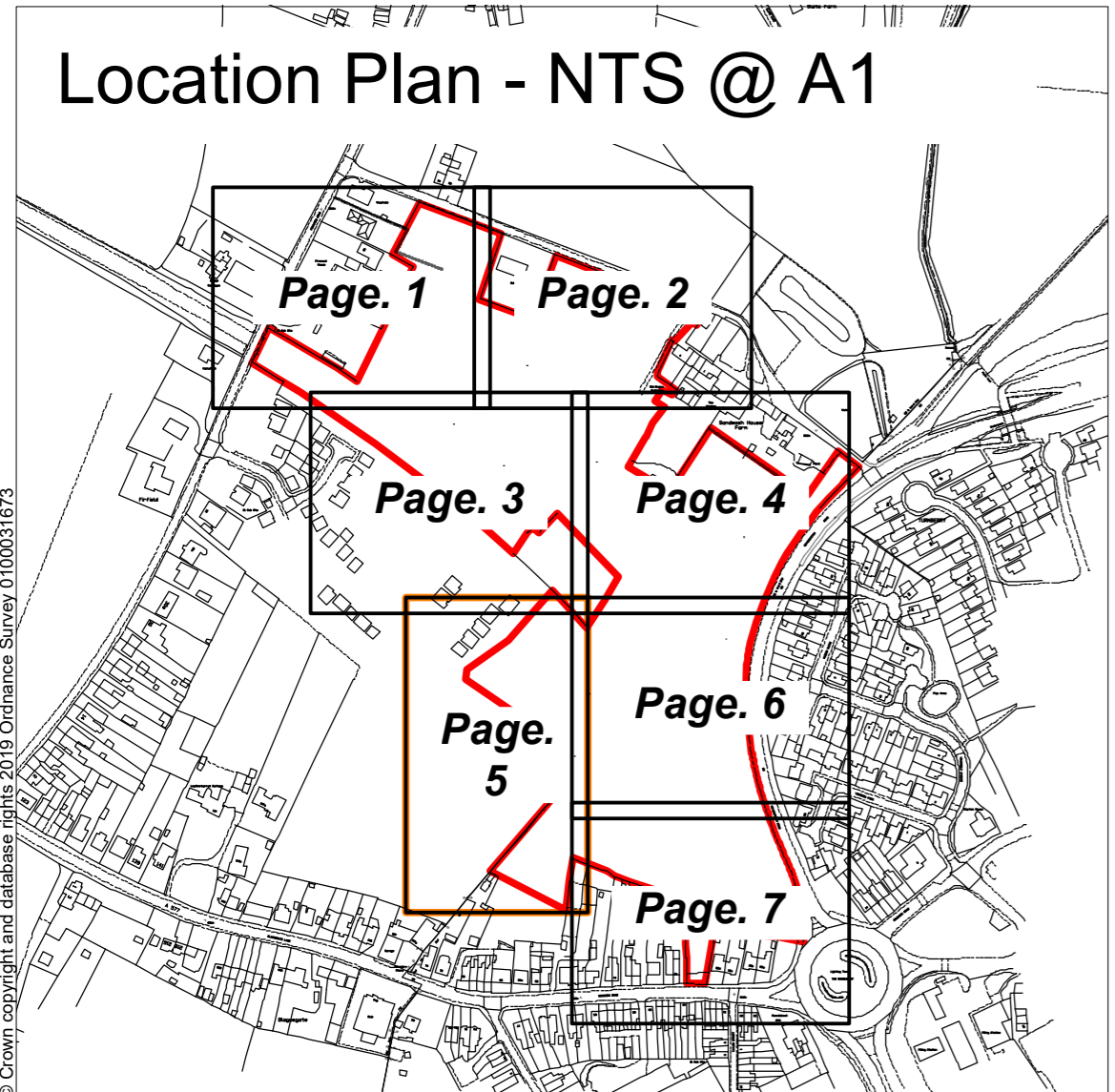

Page 7 [MAN.1154.023.ENZ.XX.XX.DR.L.45.407]

© Crown copyright and database right 2019 Ordnance Survey 100031673