

All existing trees to be retained & protected to landscape Architects details (location tbc on site)

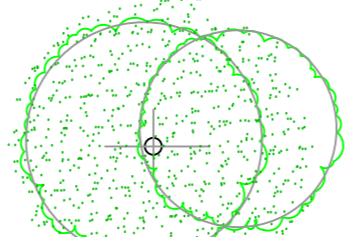

All existing trees to be retained & protected to landscape Architects details (location tbc on site)

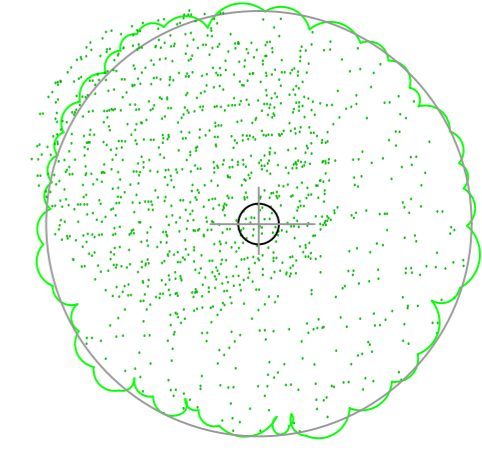

All existing trees to be retained & protected to landscape Architects details (location tbc on site)

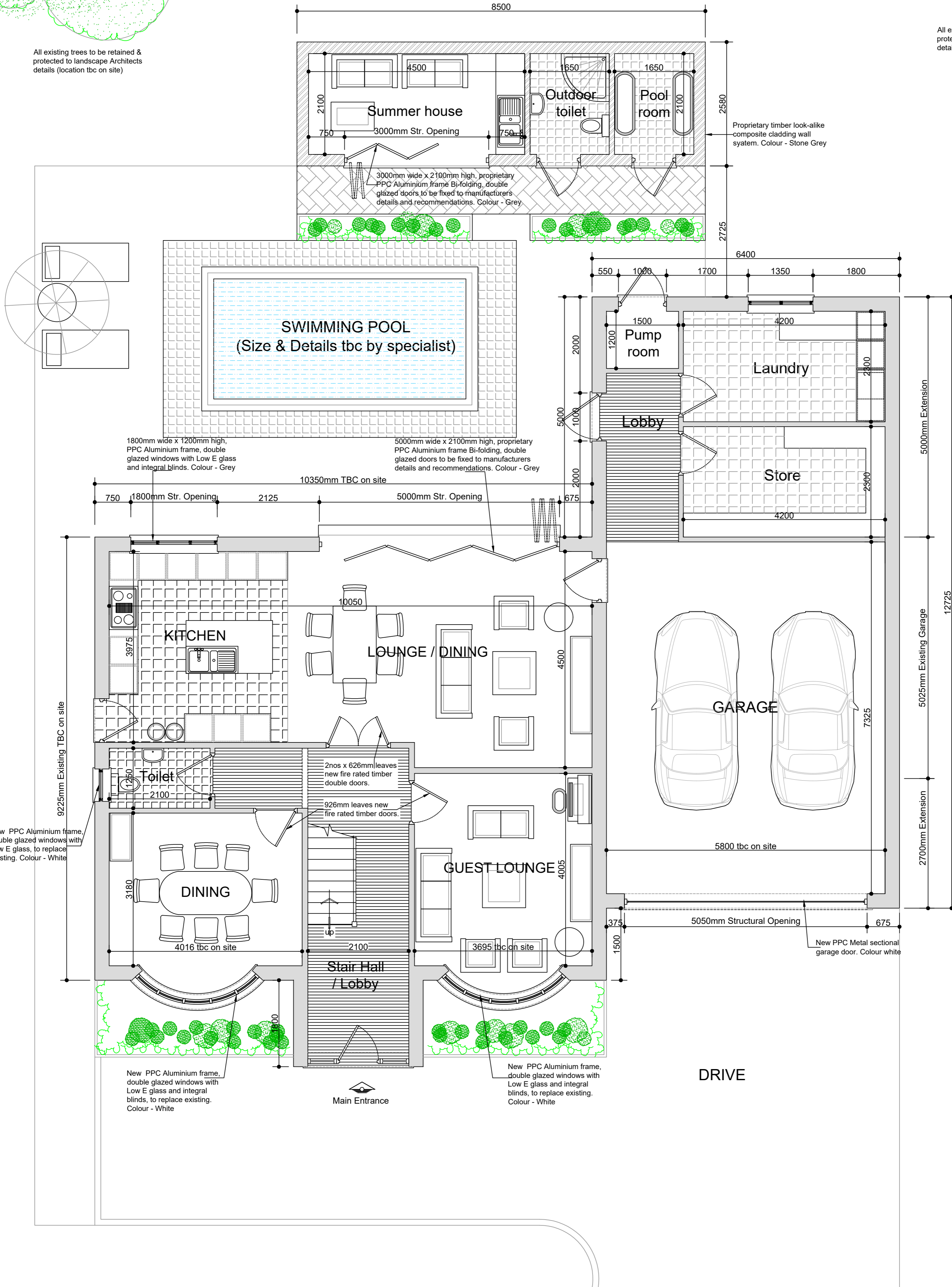

PROPOSED GROUND FLOOR PLAN Scale 1:50

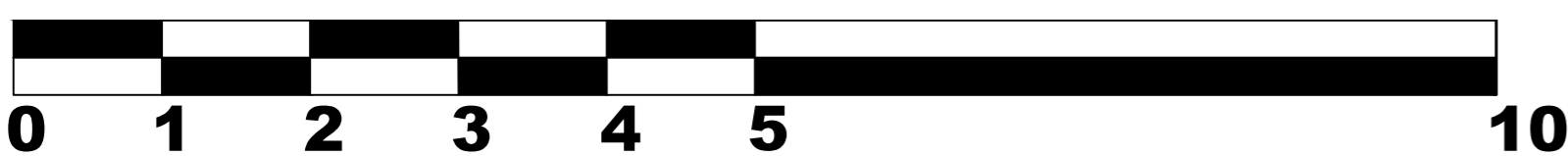

NOTES		

NOS	REVISIONS	DATES
-	-	-

DRAWING TITLE: **Proposed Ground Plan**

Project: **Proposed Extension to, 2 Cedar Close Kingston Vale SW15 3SD.**

Client: **Mr Hathal Al-Zewani**

DRAWN BY: **A .O. A**

CHECKED BY: **A .O. A**

DATE: **Dec, 2020** SCALE: **1 / 50@A1**

DRAWING NO.: **AL/001/06** Rev: **-**