

1

Site Location Plan

1 : 1250

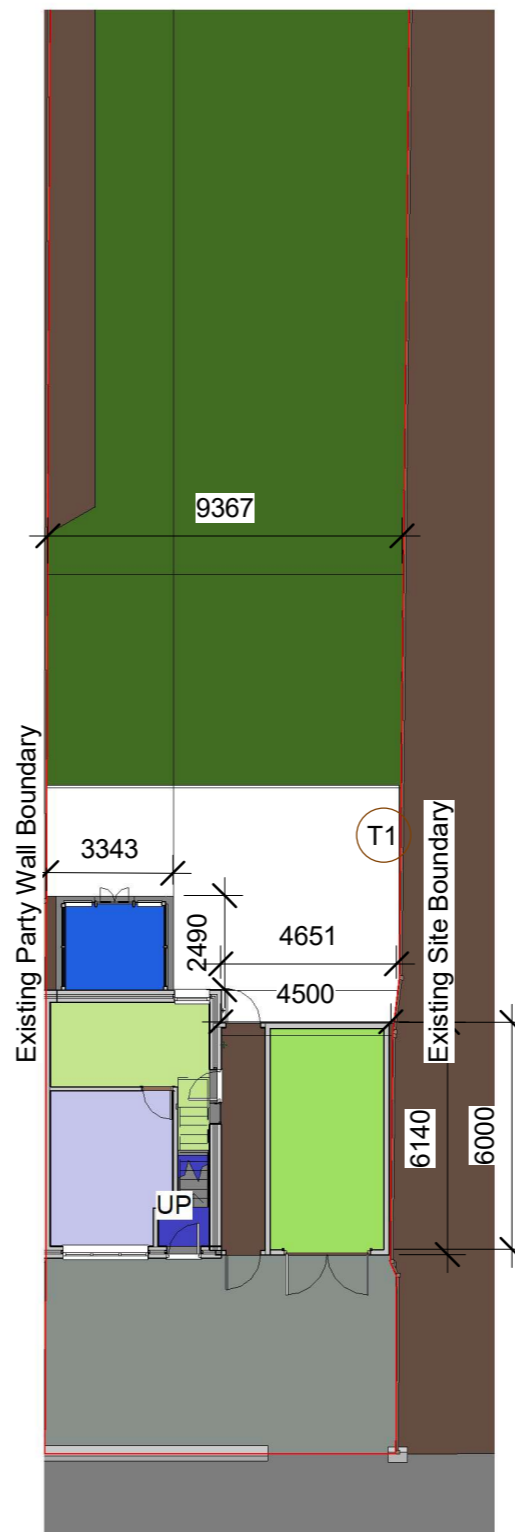

2

Site Plan Existing

1 : 200



3

Site Plan Proposed

1 : 200

Total Area of Site: 423.5m²
Total Ground Floor Building Area of Existing Property: 32m²
Total Ground Floor Building Area of Proposed Property: 92.7m²



CLIENT	Mrs N & Mr M Shaw
PROJECT	2 Storey Side and Single Storey Rear Extension
ADDRESS	19 Annable Rd, Bredbury, Stockport, SK6 2DE

Existing & Proposed Site Plans	
Project number	016
Date	07/01/21
Drawn by	T. Ireland
Revision	3
Drawing Number	016-ST-001
Status	Planning Permission Approval
Scale	As indicated @ A3

Trend
Architectural Design

T: 07757911037
E: thomas.ireland@trend-architectural.co.uk
W: www.trend-architectural.co.uk

© TREND ARCHITECTURAL DESIGN LIMITED
THIS DRAWING IS THE SUBJECT OF COPYRIGHT WHICH VESTS IN TREND ARCHITECTURAL DESIGN LIMITED. IT IS AN INFRINGEMENT OF COPYRIGHT TO REPRODUCE THIS DRAWING BY WHATEVER MEANS, INCLUDING ELECTRONIC, WITHOUT THE EXPRESS WRITTEN CONSENT OF TREND ARCHITECTURAL DESIGN LIMITED WHICH RESERVES ALL ITS RIGHTS. TREND ARCHITECTURAL DESIGN LIMITED ASSERTS ITS RIGHTS TO BE IDENTIFIED AS THE AUTHOR OF THIS DESIGN

■ ALL DIMENSIONS TO BE CHECKED ON SITE
■ ERRORS/EMISSIONS TO BE REPORTED TO DESIGNER
■ DO NOT SCALE FROM DRAWING
■ DRAWING TO BE READ IN CONJUNCTION WITH THE HEALTH AND SAFETY PLAN AND ALL RELEVANT RISK ASSESSMENTS

14/01/2021 13:25:40