

PROPOSED

PLEASE NOTE:
STRUCTURAL ENGINEERS CALCULATIONS REQUIRED FOR THE RS/J'S DESIGN AND FIXING DETAILS AND ALSO STABILITY CALCULATIONS DUE TO THE LARGE OPENING IN THE REAR SUPPORTING WALL. CLIENT/ BUILDER TO OBTAIN STRUCTURAL CALCULATIONS PRIOR TO ANY WORK COMMENCING ON SITE. THE CALCULATIONS ARE THEN TO BE GIVEN TO THE BUILDING CONTROL INSPECTOR FOR HIS APPROVAL.

MAINS WIRED SMOKE DETECTOR TO BE INSTALLED IN THE CIRCULATION SPACES ON EACH LEVEL. HEAT DETECTOR TO BE FITTED IN KITCHEN AREA. DETECTORS TO BE HARD WIRED TO THE MAINS WITH BATTERY BACK UP TO COMPLY WITH BS5446. SMOKE DETECTOR TO LOCATED WITHIN 7.5 METRES OF ANY HABITABLE ROOM DOOR.

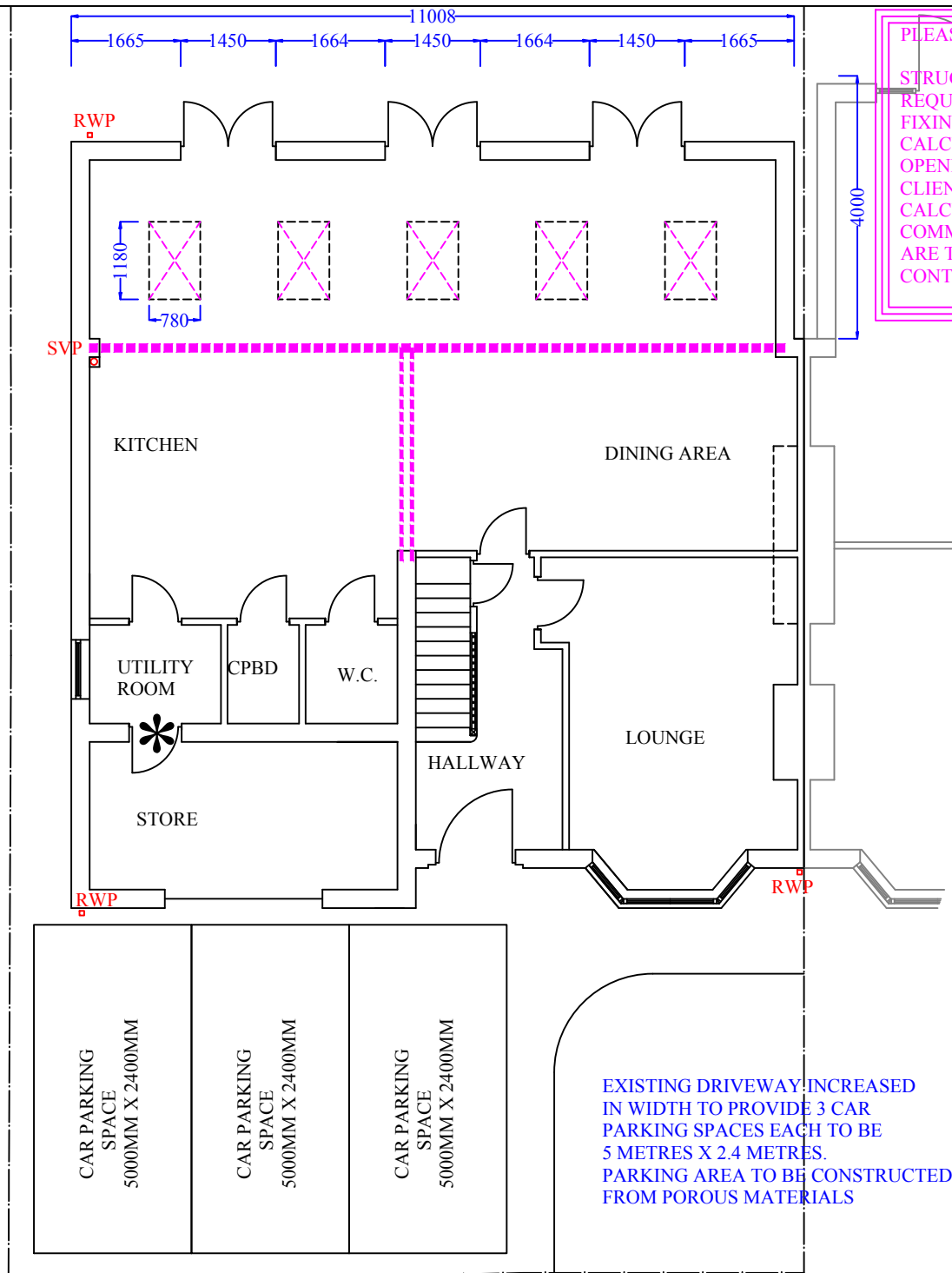

PROPOSED GROUND FLOOR PLAN VIEW

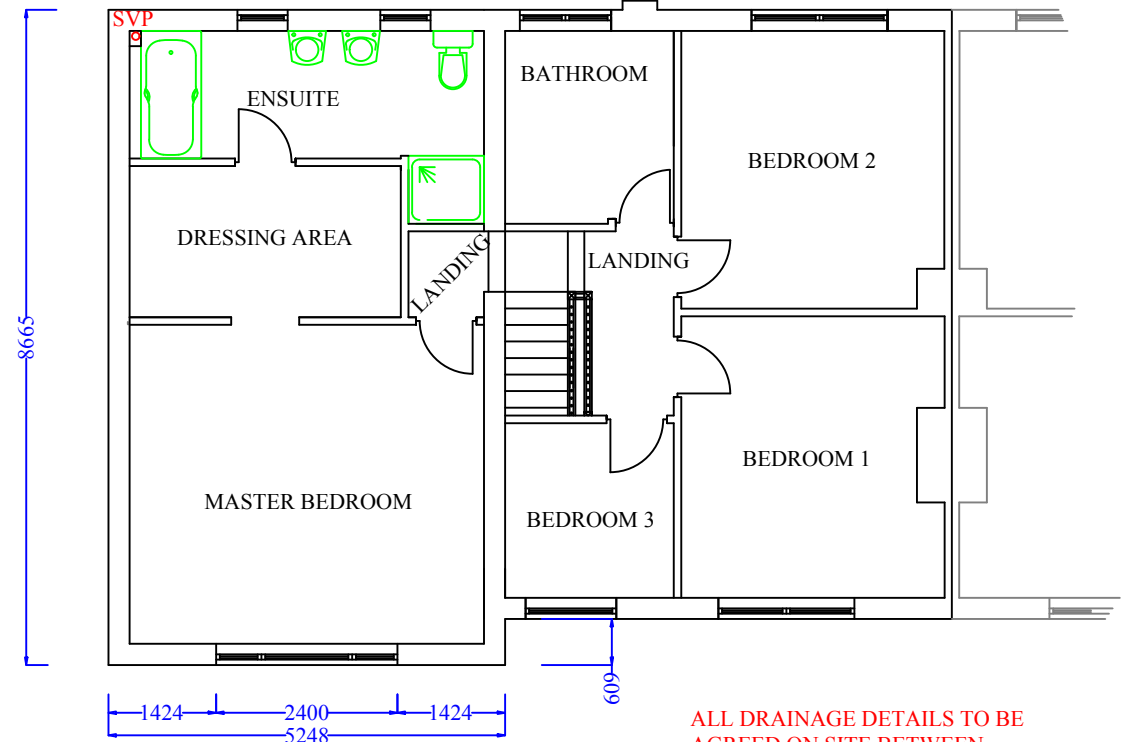

PROPOSED FIRST FLOOR PLAN VIEW

* FD30 DOOR TO BE FITTED WHERE MARKED. DOOR TO BE HUNG ON THREE HINGES & FITTED WITH A SUITABLE SELF CLOSING DEVICE. DOOR TO BE FITTED WITH AN INTUMESCENT STRIP TO GIVE 30 MINUTES FIRE RESISTANCE. SMOKE SEAL TO BE INSTALLED.

EXISTING DRIVEWAY INCREASED IN WIDTH TO PROVIDE 3 CAR PARKING SPACES EACH TO BE 5 METRES X 2.4 METRES. PARKING AREA TO BE CONSTRUCTED FROM POROUS MATERIALS

RAINWATER GUTTERING TO DISCHARGE INTO RODDABLE ACCESS TRAPPED GULLEYS.

ALL DRAINAGE DETAILS TO BE AGREED ON SITE BETWEEN THE BUILDER & LOCAL AUTHORITY BUILDING INSPECTOR.

ALL DRAINAGE PIPES TO BE PROTECTED BY THE FITMENT OF PRECAST CONCRETE LINTELS WHERE PIPES PASS THROUGH FOUNDATIONS.

ALL DRAINAGE PIPES TO BE BEDDED IN LOOSE FILLED DOLMITE TO ENCASE NEW PIPE WORK. PIPEWORK TO BE BACKFILLED WITH SOIL FROM PIPEWORK RUN TRENCH.

CLIENT: MR & MRS M HUNTER
ADDRESS:
16 NORTHFIELD ROAD
BILLINGHAM
TS22 5EL

LOCAL AUTHORITY:
STOCKTON ON TEES BOROUGH COUNCIL
TECHNICAL SERVICES DEPARTMENT
PLANNING DIVISION
MUNICIPAL BUILDINGS
CHURCH ROAD
STOCKTON ON TEES
TS18 1LD

PROPOSAL:
CONSTRUCTION OF A TWO STOREY SIDE/ FRONT EXTENSION, A SINGLE STOREY REAR EXTENSION AND A NEW FIRST FLOOR REAR ELEVATION BATHROOM WINDOW.

AGENT:
STUART PINCHES
THE PLANMAN
8 DRYDEN CLOSE
BILLINGHAM
STOCKTON ON TEES
TS23 3TT

01642 874906
07748 928974
s.pinch@ntlworld.com

DRAWING NO : 4 OF 4
DATE: 08/01/21
SCALE: 1:100 = A3 PAPER SIZE

THE PLANMAN OWNS THE COPYRIGHT OF THIS DRAWING. UNAUTHORISED, PARTIAL OR COMPLETE REPRODUCTION OF THIS DRAWING IN EITHER 2 OR 3 DIMENSIONAL FORM MAY RESULT IN LEGAL ACTION BEING TAKEN.