

Street Scene
SCALE 1:200

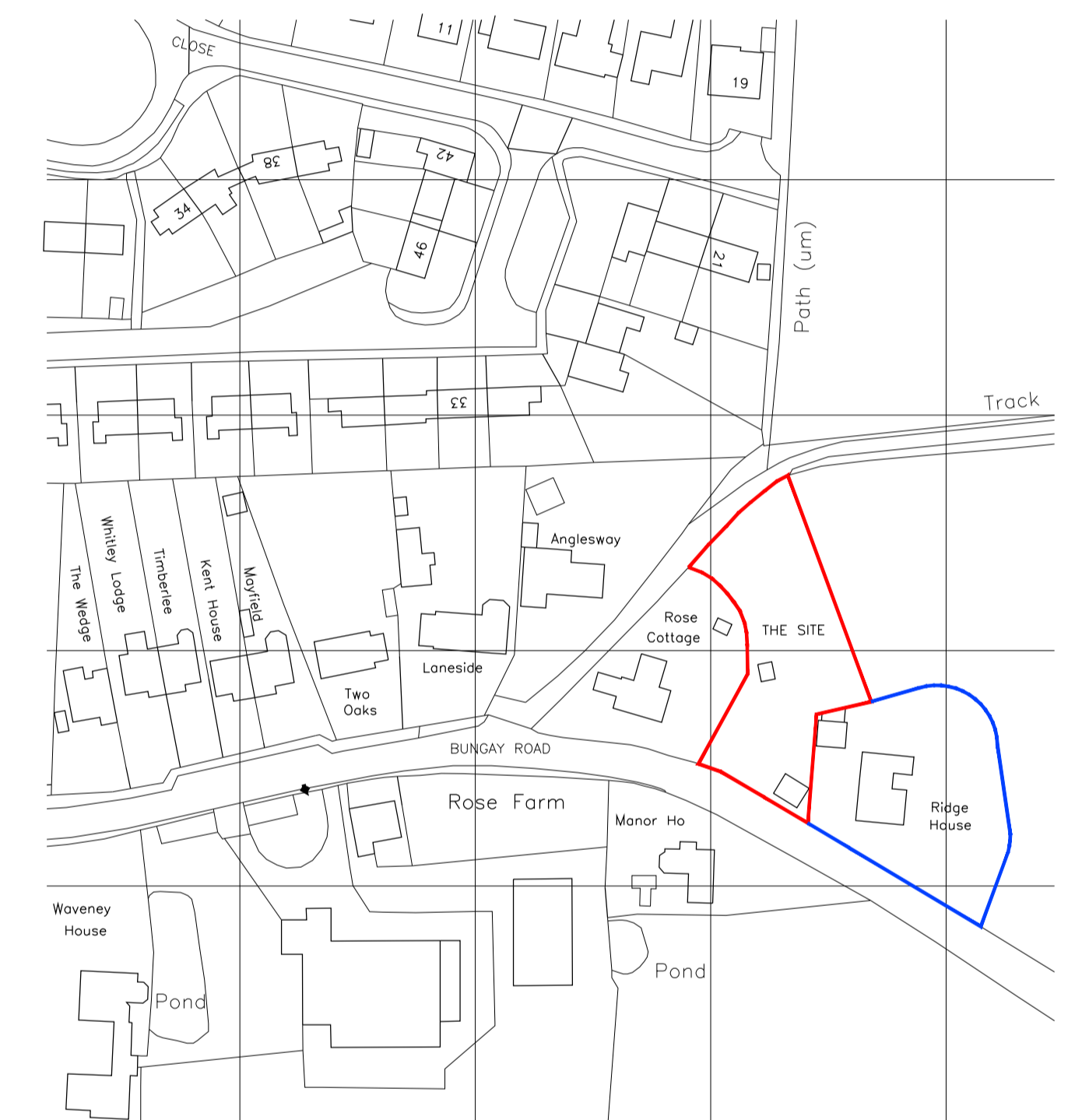

Block Plan
SCALE 1:200

- KEY**
- Grass
 - Patio
 - Driveway
 - Tarmac
 - Existing floor level as per site survey
 - Proposed level
 - Land grading direction
 - Proposed 2.4m by 43m visibility splay in accordance with Manual for Streets Table 7/1 for 30mph speed limit
 - Structures to be removed
 - Overhead electricity cables
 - Telegraph pole No X
 - Existing trees to be retained
 - Existing hedge to be retained
 - Existing hedge to be removed



Location Plan
Site area = 1286.4m²

SCALE 1:1250 (METRES)
0m 20m 60m

Ordnance Survey (c) Crown Copyright 2019. All rights reserved. Licence number 100022432

A	12/09/19	AS	Drawing updated
REV	DATE	BY	REVISION NOTES
Suite 2, Clare Hall, St Ives Business Park, Parsons Green, St Ives, Cambs, PE27 4WY			
© COPYRIGHT Tel: 01480 484848 Email: enquiries@planningandarchitecture.co.uk Web: www.planningandarchitecture.co.uk			
PROJECT Erection of new dwelling and a replacement double garage at Ridge House, Bungay RD, Scole, Norfolk, IP21 4DX			
CLIENT Mr Andy & Mrs Judith Philips			
DRAWING TITLE Proposed Block Plan, Location Plan and Street Scene			
DRAWN BY	AS	SCALE	1:200, 1:1250 @ A1
DATE	09/09/19	DWG. NO.	19.080.101
REV.			A