

EXISTING GROUND FLOOR PLAN

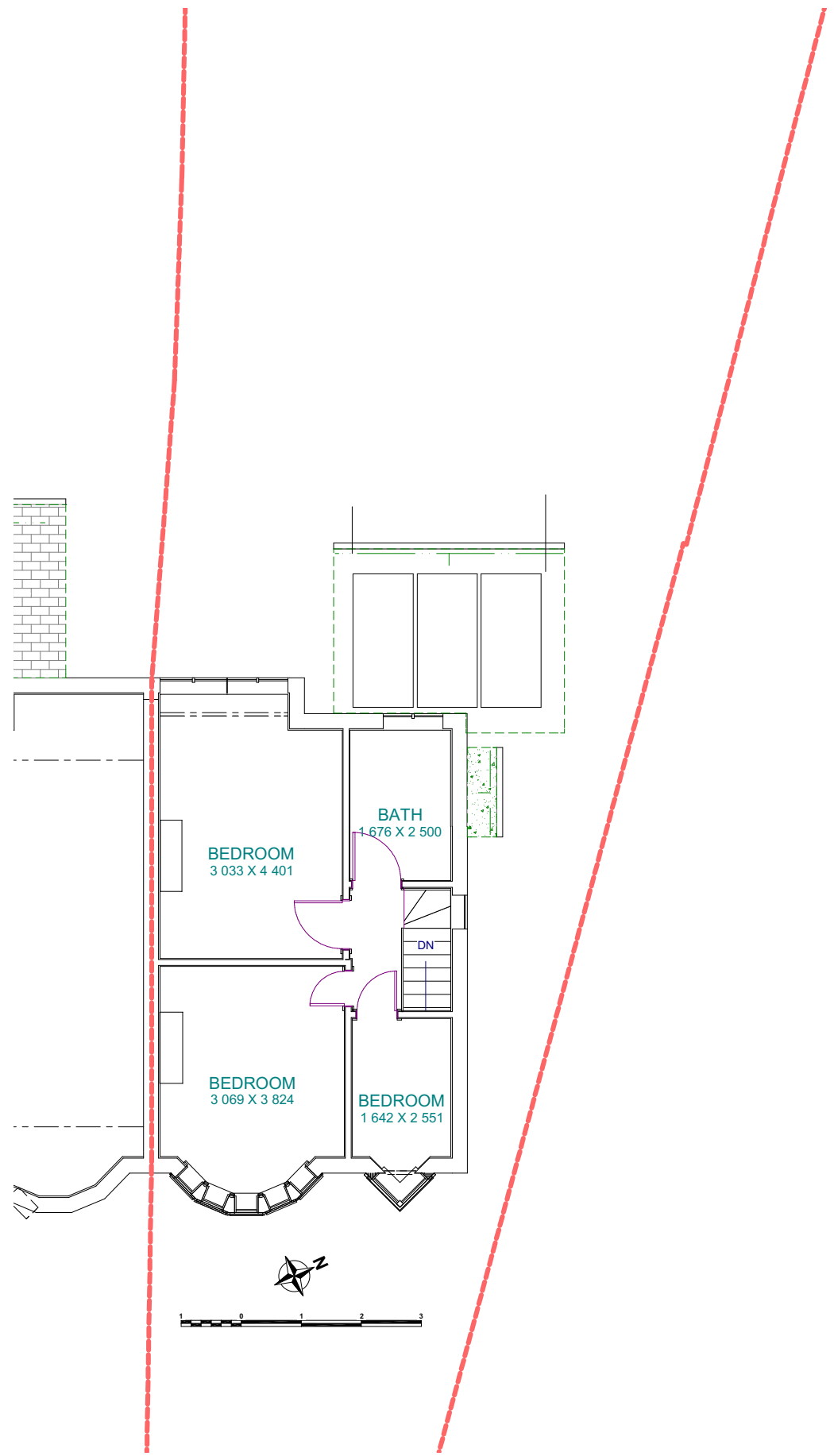

EXISTING FIRST FLOOR PLAN

Project Title:

Ground floor side and rear extension: 71 The Broadway, West Bromwich, B71 2QQ

Drawing Title:

Existing Floor Plans

Scale:

1:100

(Original sheet size = A3)

Date:

23-Dec-20

This plan is the copyright of JK Consultancy (Midlands) Ltd. It does not constitute a full working drawing. Whilst this drawing can be used as a base drawing for construction purposes, it is ESSENTIAL that all dimensions and levels are checked carefully before any work commences or any materials are ordered.