

SITE LOCATION PLANS

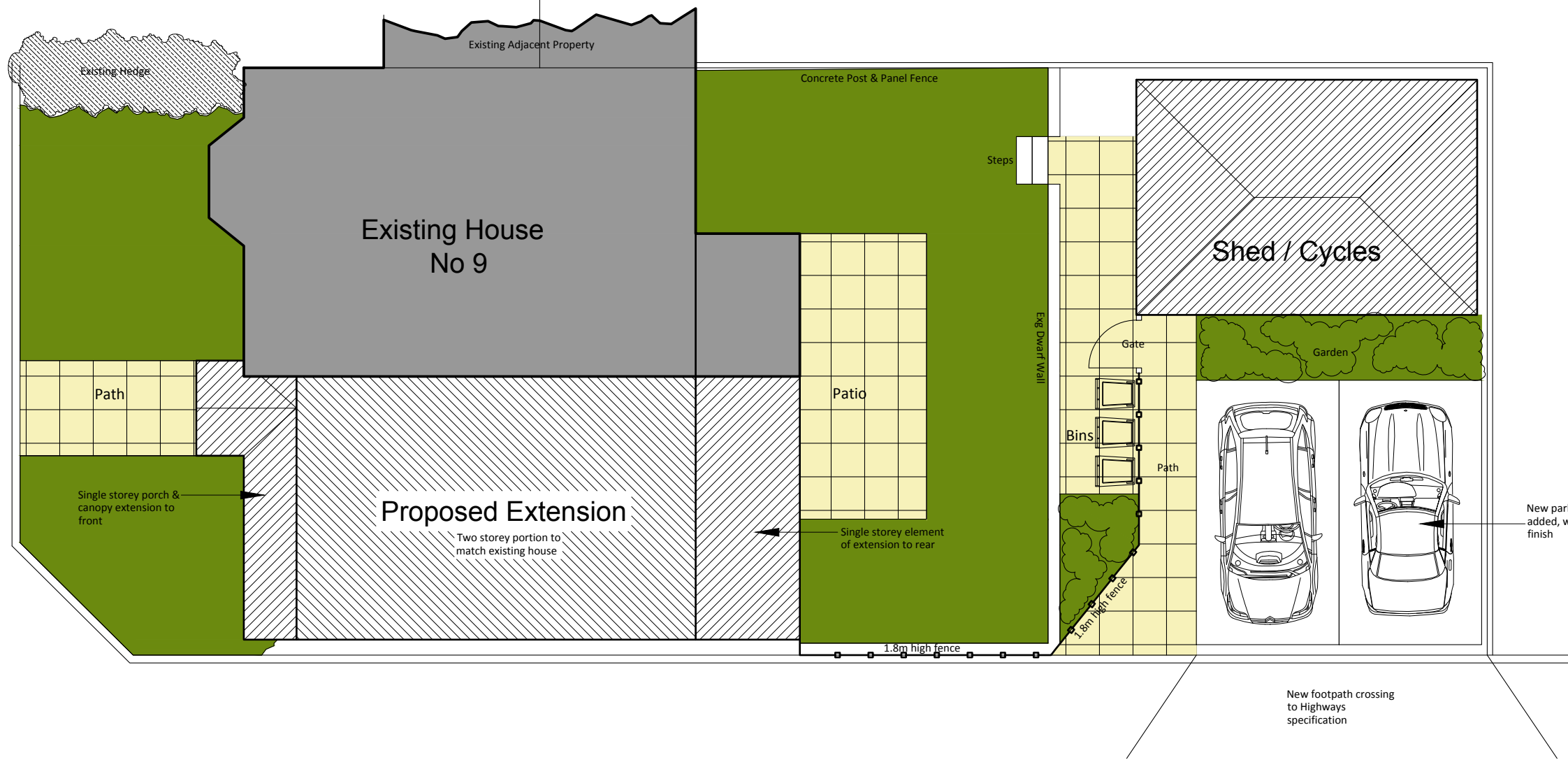

SITE PLAN - 1:100

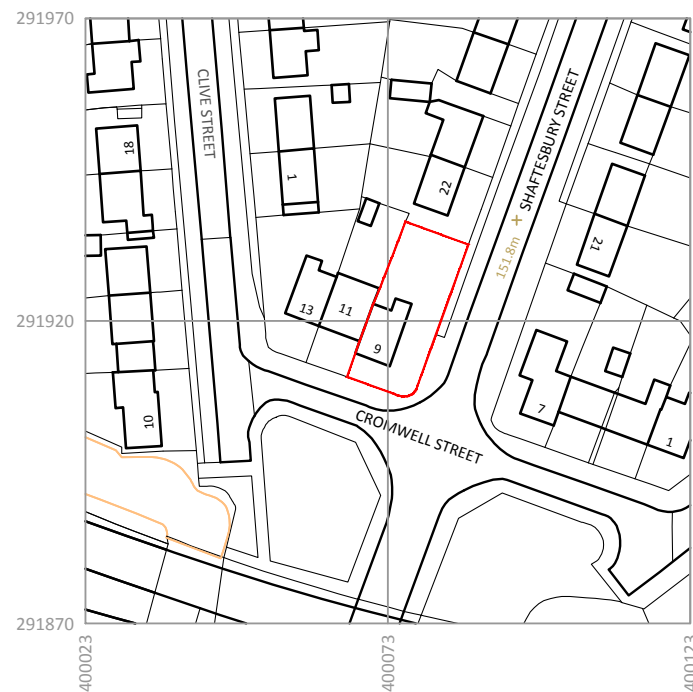

LOCATION PLAN - 1:1250

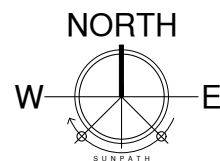

Produced on 16 December 2020 from the Ordnance Survey National Geographic Database and incorporating surveyed revision available at this date.
 This map shows the area bounded by 400023,291870 400023,291970 400123,291970 400123,291870
 Reproduction in whole or part is prohibited without the prior permission of Ordnance Survey.
 Crown copyright 2020. Supplied by copla ltd trading as UKPlanningMaps.com a licensed Ordnance Survey partner (100054135).
 Data licenced for 1 year, expiring 16 December 2021. Unique plan reference: v1c/549318/743853

PRINT TO FIT
A3

Rev	Amendment	Date
CLIENT: MR R TANDA		
PROPOSALS: Proposed Extensions at		
SITE ADDRESS: 9 Cromwell Street West Bromwich B71 1LL		
SITE PLANS		
SCALE: 1:200 / 1:1250		DRAWING No.:
DATE: Dec 2020		128/PD/01

The Green,
 Milford,
 Staffordshire
 ST17 0UR
 DOVEARCHDESIGN@GMAIL.COM
 Mobile : 07967 216955

Architectural Design Limited
 Architectural & Building Design Consultants

Dove

Written dimensions to be taken only.
 Minor inaccuracies may occur due to printing processes.