

SITE LOCATION
(Scale 1:50000)

Ordnance Survey map extract based upon Landranger map series with the permission of the controller of Her Majesty's Stationery Office Licence No. 0100023487 Crown copyright.

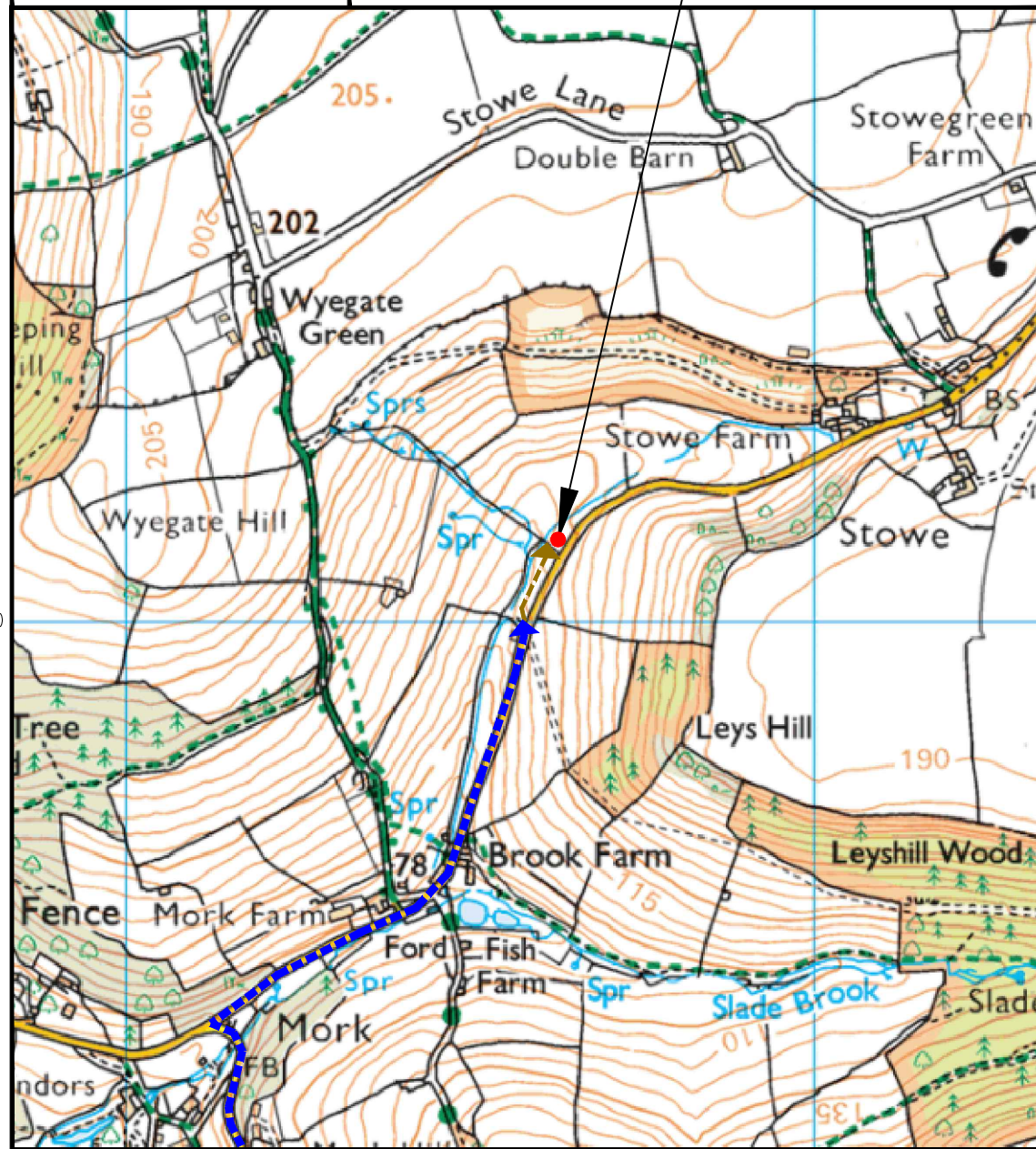

DETAILED SITE LOCATION
(Scale 1:10000)

Based upon Ordnance Survey map extract with the permission of the Controller of Her Majesty's Stationery Office. Crown copyright. Licence No. 100020449



ORIGINAL SCALE AT A3 - 1:10000 ALL DIMENSIONS IN MILLIMETRES

ALL DIMENSIONS ARE IN mm UNLESS NOTED OTHERWISE

N.G.R | E: 355630 N: 206109

CONCESSION REQUIRED | NO

DIRECTIONS TO SITE:
FROM St BRIAVELS, HEAD SOUTH ON B4228 TOWARD HORSEPOOL Ln FOR 56 FT AND TURN RIGHT ONTO HORSEPOOL Ln FOR 0.3 MILE AND TURN RIGHT ONTO CHICKADEE FOR 0.2 MILE AND CONTINUE ONTO COCKSHOOT HILL FOR 0.2 MILE AND CONTINUE ONTO MORK Rd FOR 0.8 MILE AND TURN RIGHT ONTO STOWE ROAD FOR 0.6 MILE AND DESTINATION WILL BE ON THE LEFT

A	Issued for Approval	WK	JS	01.12.20
REV	MODIFICATION	BY	CH	DATE

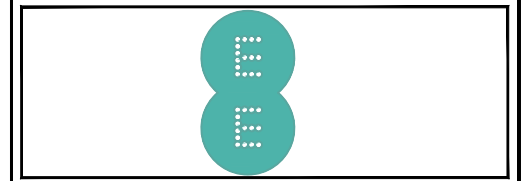

Cell Name		Opt.
MORK CLAY PIGEON SHOOTING CLUB		-
Cell ID No		
ESN No	Temp. Cell ID No	Site ID No
ESN40157	70893	1624679

Site Address / Contact Details
MORK
St BRIAVELS
LYDNEY
GLOS
GL15 6QH

Drawing Title: SITE LOCATION MAPS
Purpose of issue: **PLANNING**
Drawing Number: ESN40157/100

Surveyed By: DAEL		Original Sheet Size: A3		Issue:
Drawn: WK	Date: 01.12.20	Checked: JS	Date: 01.12.20	A

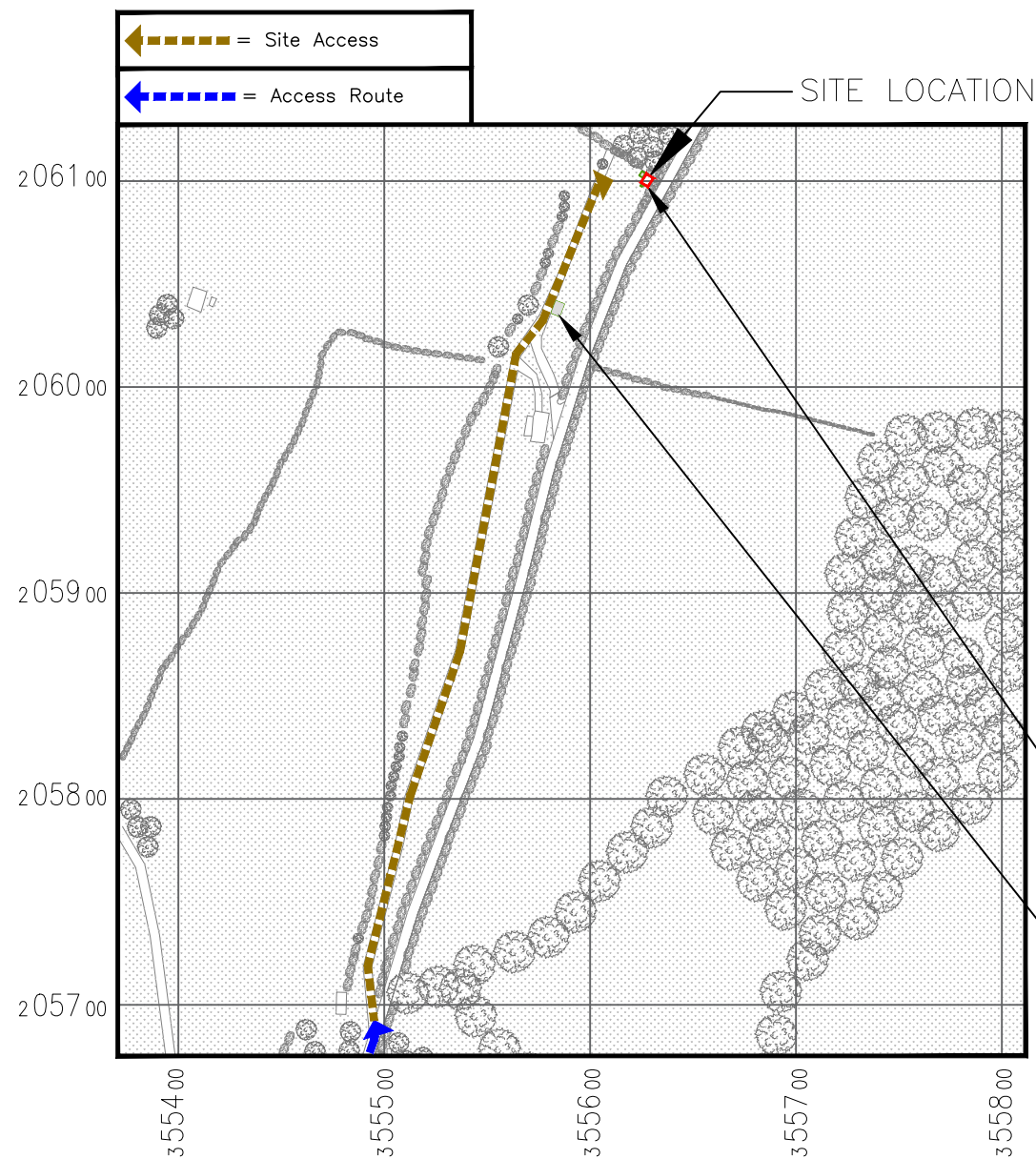
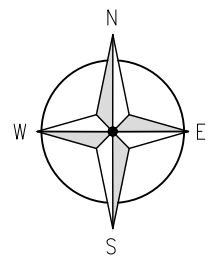

DETAILED SITE LOCATION
(Scale 1:3500)

Based upon Ordnance Survey map extract with the permission of the Controller of Her Majesty's Stationery Office. Crown copyright. Licence No. 100020449

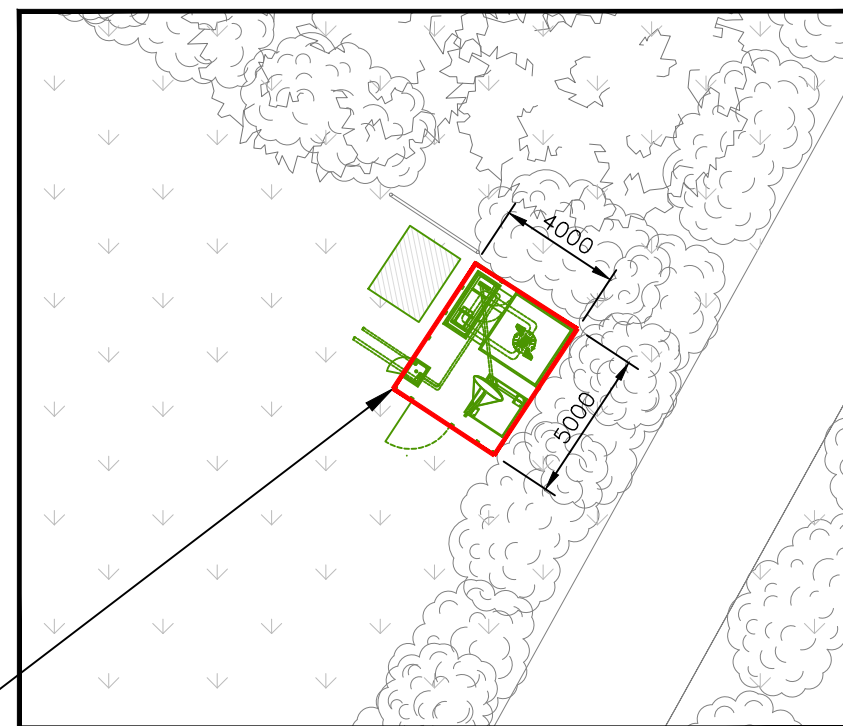

LEASE DEMISE PLAN
(Scale 1:250)

PROPOSED 20m² SITE DEMISE

PROPOSED 6x4m RRV/PARKING AREA

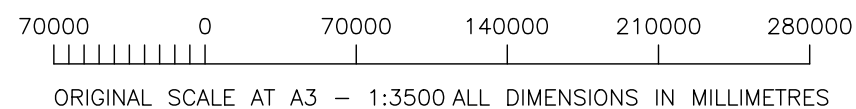

ALL DIMENSIONS ARE IN mm UNLESS NOTED OTHERWISE

N.G.R | E: 355630 N: 206109

CONCESSION REQUIRED | NO

DIRECTIONS TO SITE:
FROM St BRIAVELS, HEAD SOUTH ON B4228 TOWARD HORSEPOOL Ln FOR 56 FT AND TURN RIGHT ONTO HORSEPOOL Ln FOR 0.3 MILE AND TURN RIGHT ONTO CHICKADEE FOR 0.2 MILE AND CONTINUE ONTO COCKSHOOT HILL FOR 0.2 MILE AND CONTINUE ONTO MORK Rd FOR 0.8 MILE AND TURN RIGHT ONTO STOWE ROAD FOR 0.6 MILE AND DESTINATION WILL BE ON THE LEFT

A	Issued for Approval	WK	JS	01.12.20
REV	MODIFICATION	BY	CH	DATE



Cell Name	Opt.
MORK CLAY PIGEON SHOOTING CLUB	-

Cell ID No		
ESN No	Temp. Cell ID No	Site ID No
ESN40157	70893	1624679

Site Address / Contact Details	
MORK St BRIAVELS LYDNEY GLOS GL15 6QH	

Drawing Title: LEASE DEMISE LAYOUT

Purpose of issue: **PLANNING**

Drawing Number: ESN40157/101

Surveyed By: DAEL	Original Sheet Size: A3	Issue: A
Drawn: WK	Date: 01.12.20	Checked: JS
Date: 01.12.20	Date: 01.12.20	

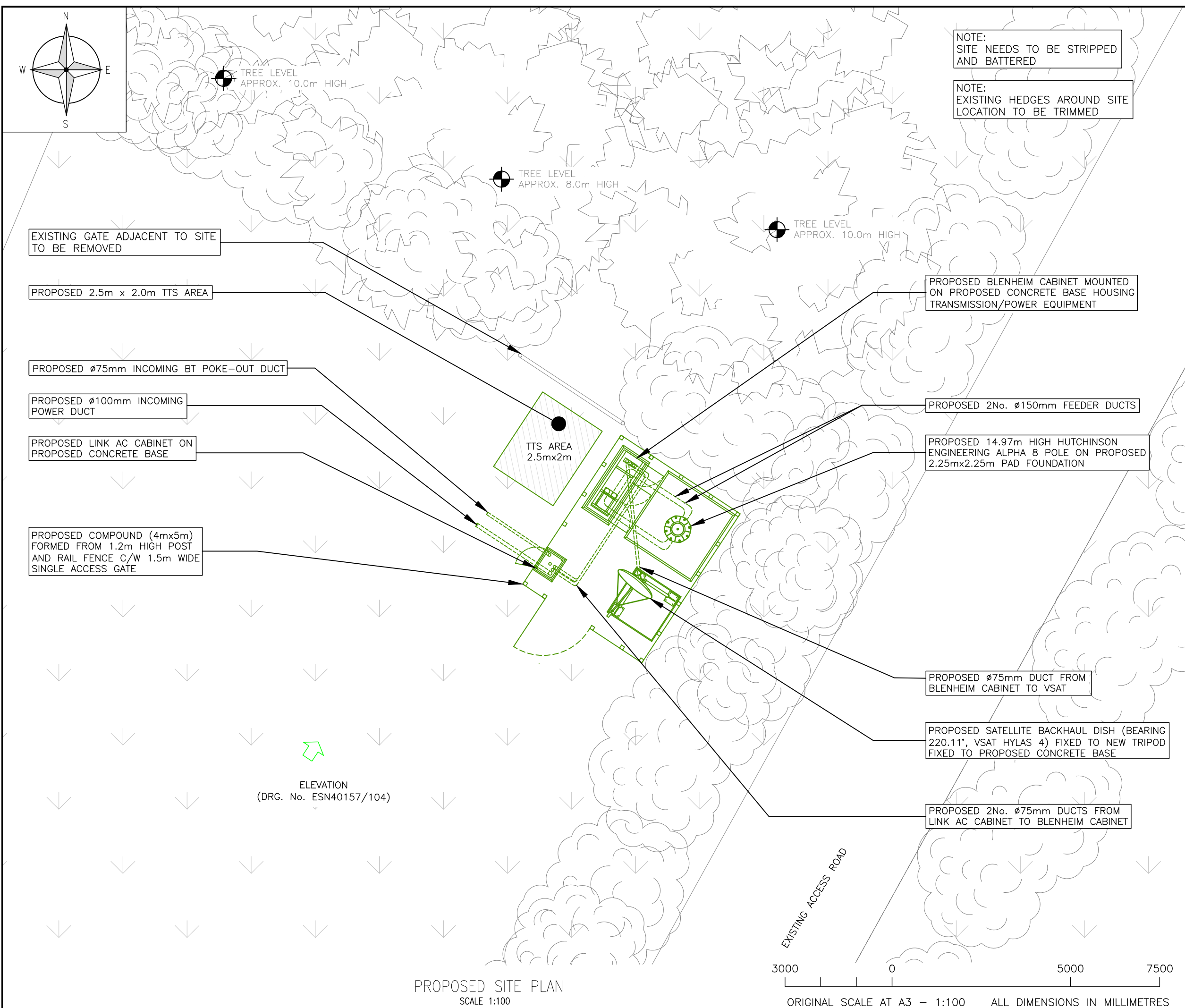

PROPOSED SITE PLAN
SCALE 1:100

3000 0 5000 7500
ORIGINAL SCALE AT A3 - 1:100 ALL DIMENSIONS IN MILLIMETRES

NOTE:
SITE NEEDS TO BE STRIPPED
AND BATTERED

NOTE:
EXISTING HEDGES AROUND SITE
LOCATION TO BE TRIMMED

ALL DIMENSIONS ARE IN mm UNLESS NOTED OTHERWISE

N.G.R | E: 355630 N: 206109
CONCESSION REQUIRED | NO

A	Issued for Approval	WK	JS	01.12.20
REV	MODIFICATION	BY	CH	DATE

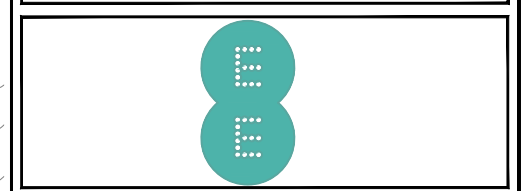

Cell Name	Opt.
MORK CLAY PIGEON SHOOTING CLUB	-

Cell ID No		
ESN No	Temp. Cell ID No	Site ID No
ESN40157	70893	1624679

Site Address / Contact Details
MORK
St BRIAVELS
LYDNEY
GLOS
GL15 6QH

Drawing Title: PROPOSED SITE PLAN

Purpose of issue: PLANNING

Drawing Number: ESN40157/102

Surveyed By: DAEL	Original Sheet Size: A3	Issue: A
Drawn: WK	Date: 01.12.20	Checked: JS
	Date: 01.12.20	

NOTE:
SITE NEEDS TO BE STRIPPED
AND BATTERED

NOTE:
EXISTING HEDGES AROUND SITE
LOCATION TO BE TRIMMED

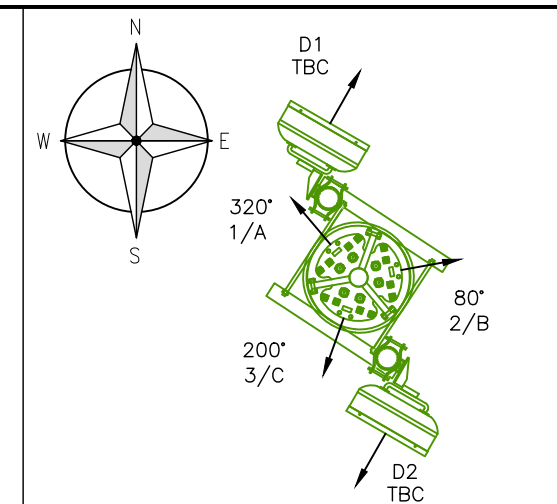

PROPOSED EE ANTENNA PLAN
SCALE 1:25

PROPOSED 3No. ALPHA AW3734 12
PORT ANTENNA, 3No. 1800 MHA's &
3No. 800 MHA's MOUNTED WITHIN
SHROUD (3 SECTOR SITE)

PROPOSED 2No. ϕ 300mm EE DISHES TO BE
MOUNTED ON SUPPORT POLES

PROPOSED 14.97m HIGH HUTCHINSON
ENGINEERING ALPHA 8 POLE ON PROPOSED
2.25m x 2.25m PAD FOUNDATION

TREE LEVEL
APPROX. 8.0m HIGH

PROPOSED BLENHEIM CABINET MOUNTED
ON PROPOSED CONCRETE BASE HOUSING
TRANSMISSION/POWER EQUIPMENT

PROPOSED LINK AC CABINET ON
PROPOSED CONCRETE BASE

EXISTING GATE ADJACENT TO SITE
TO BE REMOVED

TOP OF PROPOSED ANTENNAS/TOWER +14.97m AGL

C/L OF PROPOSED ANTENNAS +13.57m AGL

BOTTOM OF PROPOSED ANTENNAS +12.17m AGL

C/L OF PROPOSED DISH + 11.855m AGL

TREE LEVEL
APPROX. 10.0m HIGH

PROPOSED SATELLITE BACKHAUL DISH (BEARING
220.11°, VSAT HYLAS 4) FIXED TO NEW TRIPOD
FIXED TO PROPOSED CONCRETE BASE

PROPOSED COMPOUND (4m x 5m)
FORMED FROM 1.2m HIGH POST
AND RAIL FENCE C/W 1.5m WIDE
SINGLE ACCESS GATE

C/L OF PROPOSED SATELLITE DISH + 2.40m AGL

GL

PROPOSED SOUTH-WEST ELEVATION
SCALE 1:100



ORIGINAL SCALE AT A3 - 1:100 ALL DIMENSIONS IN MILLIMETRES

ALL DIMENSIONS ARE IN mm UNLESS NOTED OTHERWISE

N.G.R E: 355630 N: 206109

CONCESSION REQUIRED NO

A	Issued for Approval	WK	JS	01.12.20
REV	MODIFICATION	BY	CH	DATE



Cell Name	Opt.
MORK CLAY PIGEON SHOOTING CLUB	-

Cell ID No		
ESN No	Temp. Cell ID No	Site ID No
ESN40157	70893	1624679

Site Address / Contact Details
MORK St BRIAVELS LYDNEY GLOS GL15 6QH

Drawing Title:
PROPOSED SITE ELEVATION AND ANTENNA PLAN

Purpose of issue:
PLANNING

Drawing Number:
ESN40157/104

Surveyed By: DAEL	Original Sheet Size: A3	Issue: A
Drawn: WK	Date: 01.12.20	Checked: JS
	Date: 01.12.20	

ALL DIMENSIONS ARE IN mm UNLESS NOTED OTHERWISE

N.G.R | E: 355630 N: 206109

CONCESSION REQUIRED | NO

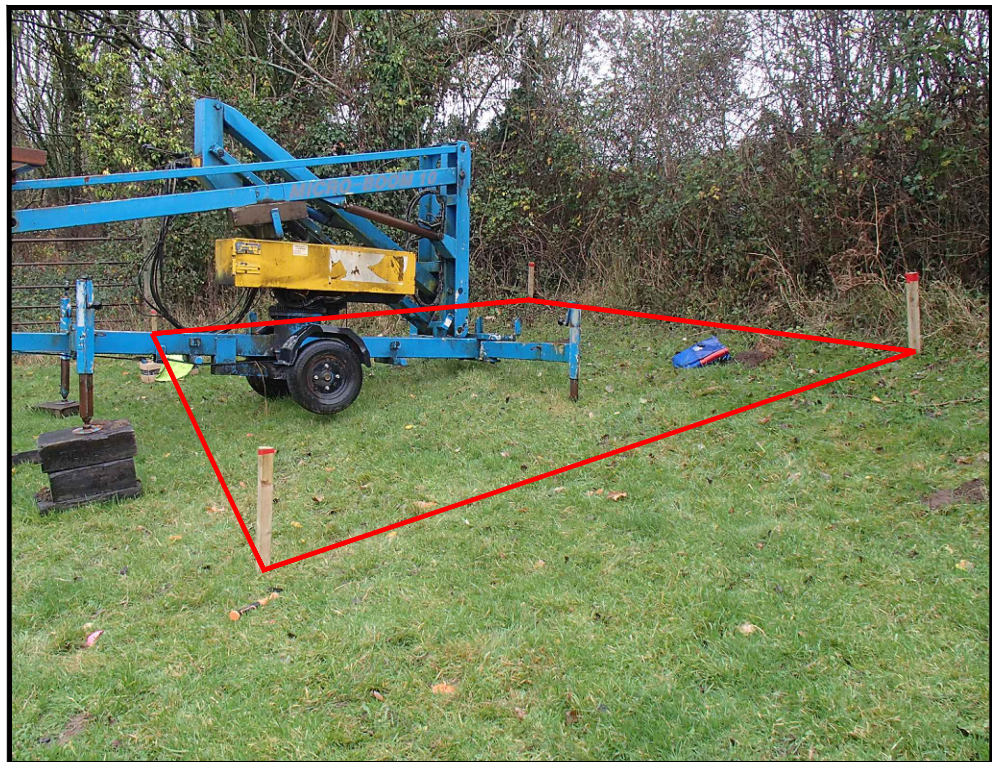

1. GENERAL SITE VIEW



2. GENERAL SITE VIEW



3. EXSITNG SITE ACCESS



4. HYLAS 4

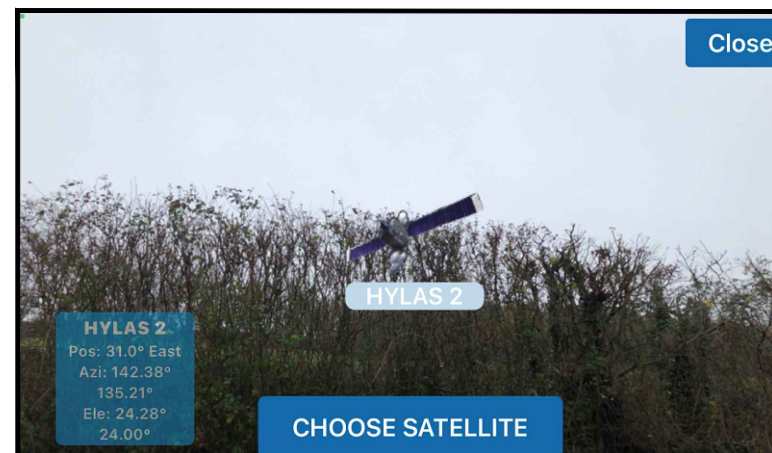

5. HYLAS 2

A	Issued for Approval	WK	JS	01.12.20
REV	MODIFICATION	BY	CH	DATE



Cell Name	Opt.
MORK CLAY PIGEON SHOOTING CLUB	-

Cell ID No		
ESN No	Temp. Cell ID No	Site ID No
ESN40157	70893	1624679

Site Address / Contact Details	
MORK St BRIAVELS LYDNEY GLOS GL15 6QH	

Drawing Title: PHOTOGRAPHS

Purpose of issue: PLANNING

Drawing Number: ESN40157/108

Surveyed By: DAEL	Original Sheet Size: A3	Issue: A
Drawn: WK	Date: 01.12.20	Checked: JS
	Date: 01.12.20	