

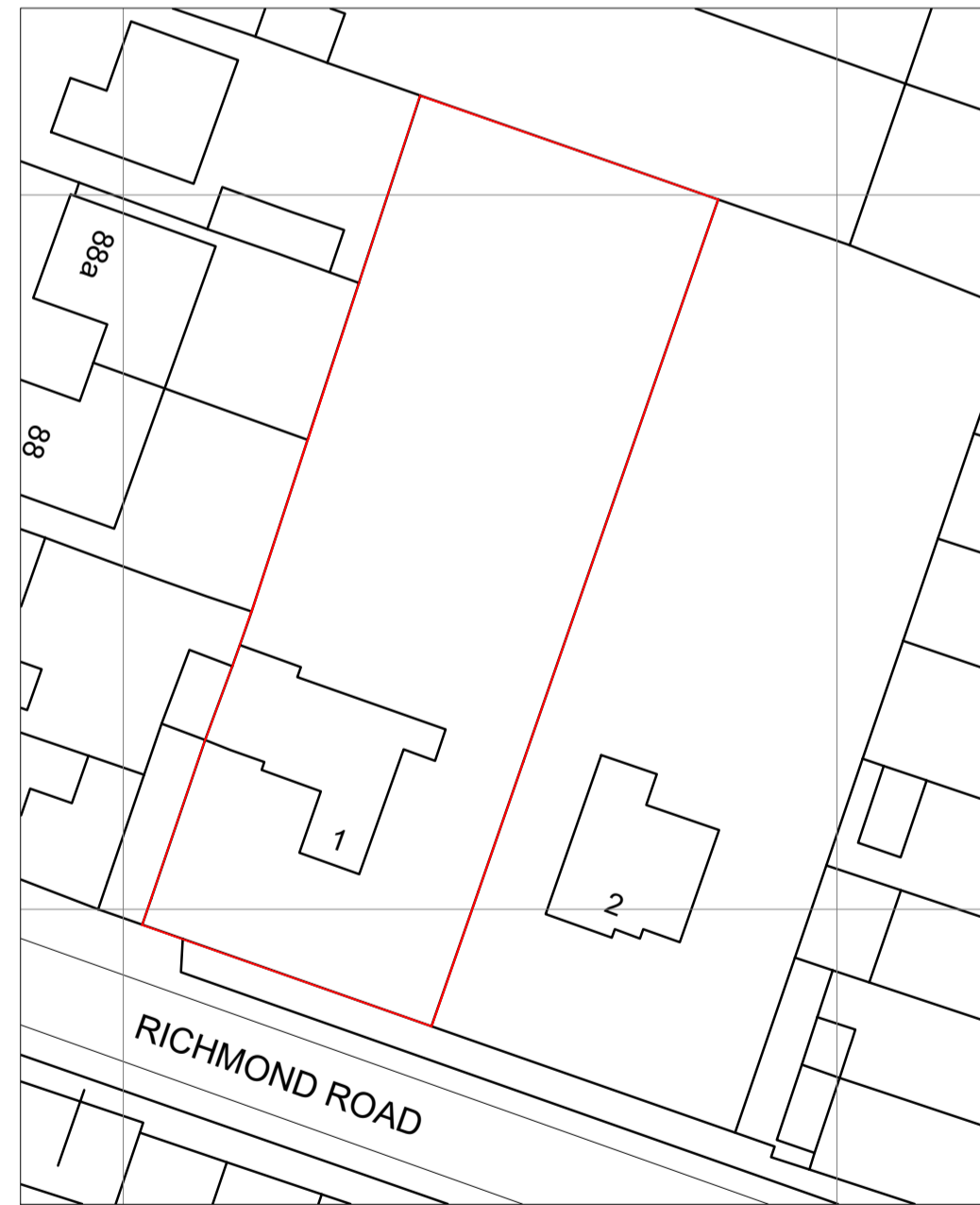

- Notes**
1. All materials to match existing.
 2. All dimensions shown are structural build sizes not finished sizes.
 3. Do not scale from this drawing (other than for Building Control purposes).
 4. The Contractor is to verify all dimensions before setting out, commencing work or placing orders.
 5. Any discrepancies to be reported to M3 Architectural Design Ltd.

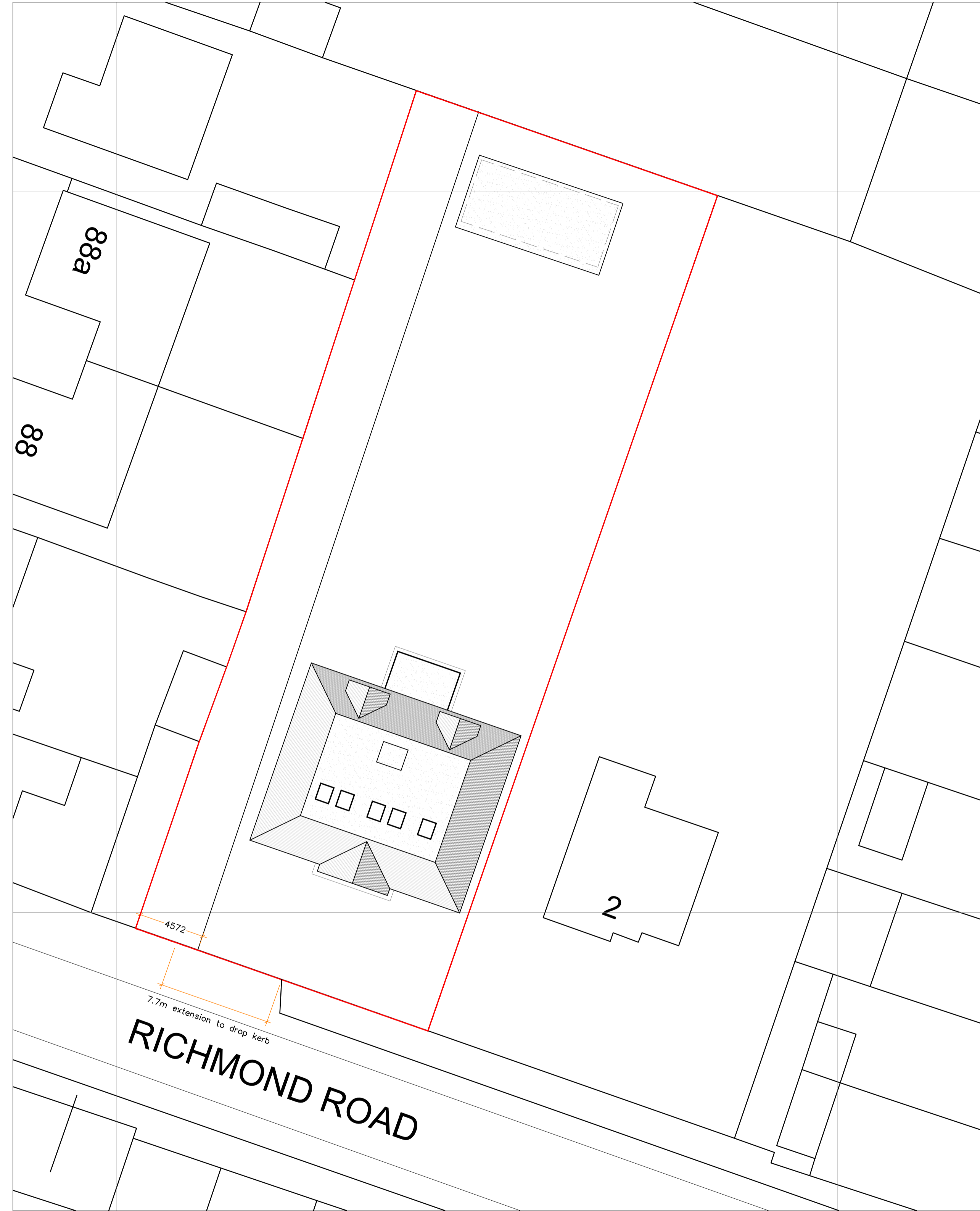

Site Location
Scale 1:500



Block Plan
Scale 1:200

SUPERSEDED

RECEIVED
23/12/2020
20/01082/FUL



F	01.12.20	Re-design of proposal
E	15.06.20	Amended to suit Client comments (27.10.20)
D	15.06.20	Amended to suit feedback from Highways Officer (08.06.20)
C	03.04.20	Amending to suit feedback. Email dated - 02.04.20
B	11.03.20	Drop kerb details added.
A	24.01.20	Shared driveway and parking adjusted.
Rev	Date	Description



Project

1 Richmond Road

Client

Drawing Title
Site Location and Block Plan

Date	Drawing No.	Rev
09.09.19	1634-010	F

Page Size	Scale
A1	AS SHOWN

M3 Architectural Design Ltd
Basepoint Centres Ltd
377-399 London Road Camberley GU15 3HL.

t:01276 300024
e: info@m3architecturaldesign.co.uk
w: www.m3architecturaldesign.co.uk

© 2019 M3 Architectural Design Ltd

