

PROPOSED EXTENSION & INTERNAL ALTERATIONS AT: 5 DUBFORD WALK, DUBFORD, ABERDEEN, AB23 8GN FOR: MR & MRS DOUGLAS & YVONNE TEMPLE

Crown copyright and database right. All rights reserved. Ordnance Survey licence no 100049616



SITE LOCATION PLAN

SCALE 1:1250 @ A2

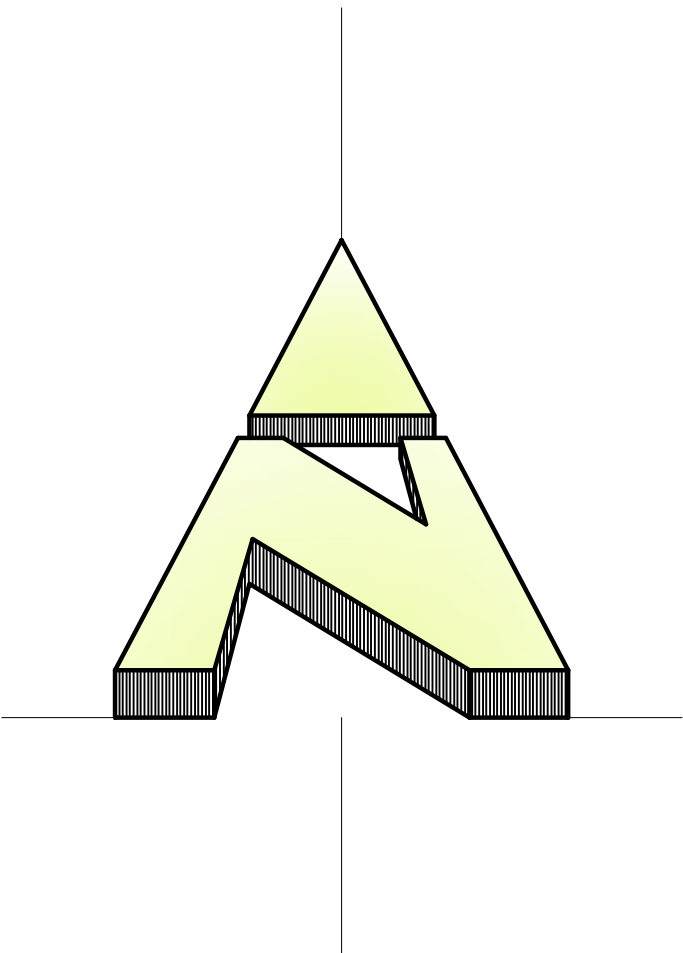

Crown copyright and database right. All rights reserved. Ordnance Survey licence no 100049616

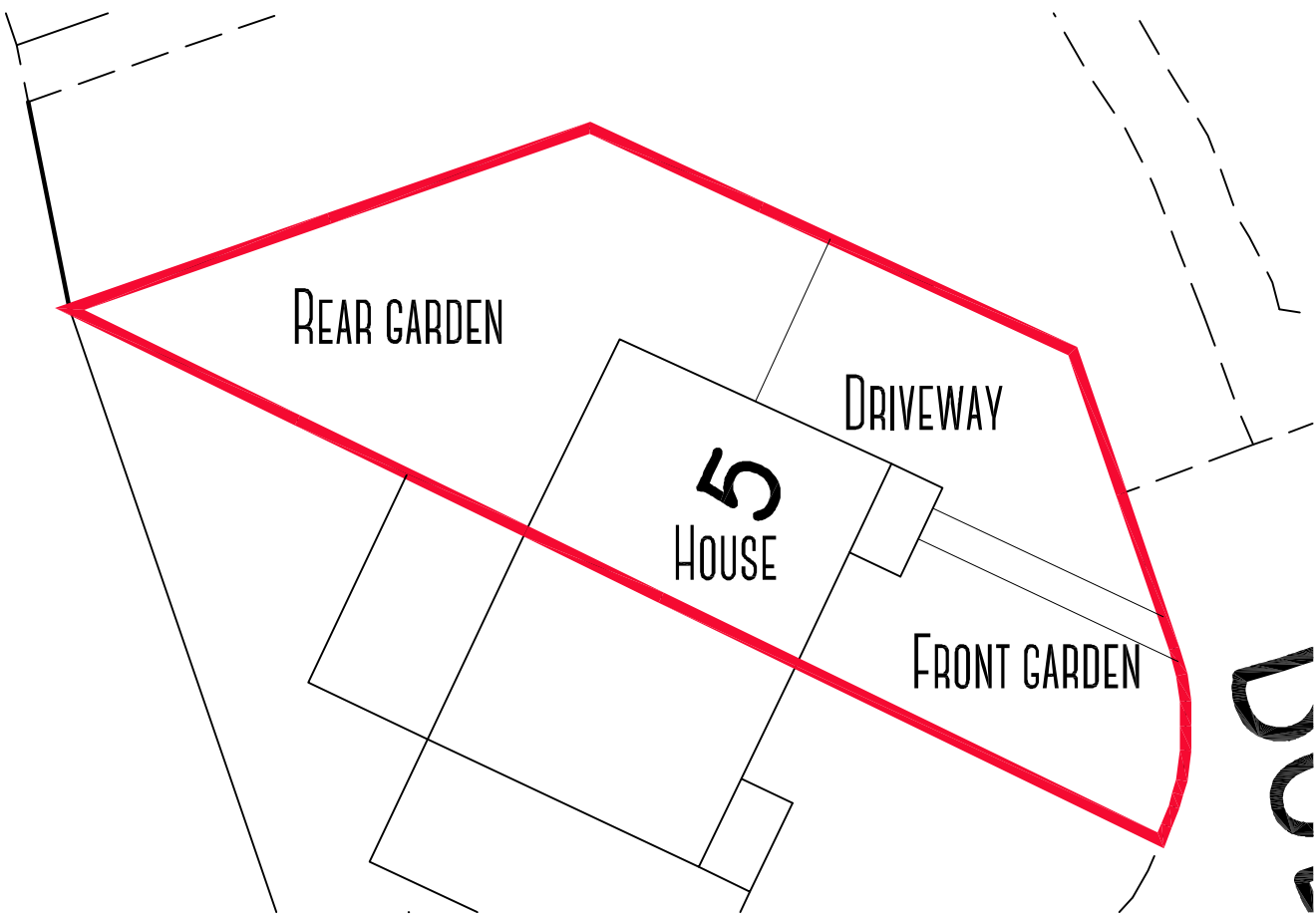

EXISTING SITE LAYOUT PLAN

SCALE 1:200 @ A2

Crown copyright and database right. All rights reserved. Ordnance Survey licence no 100049616

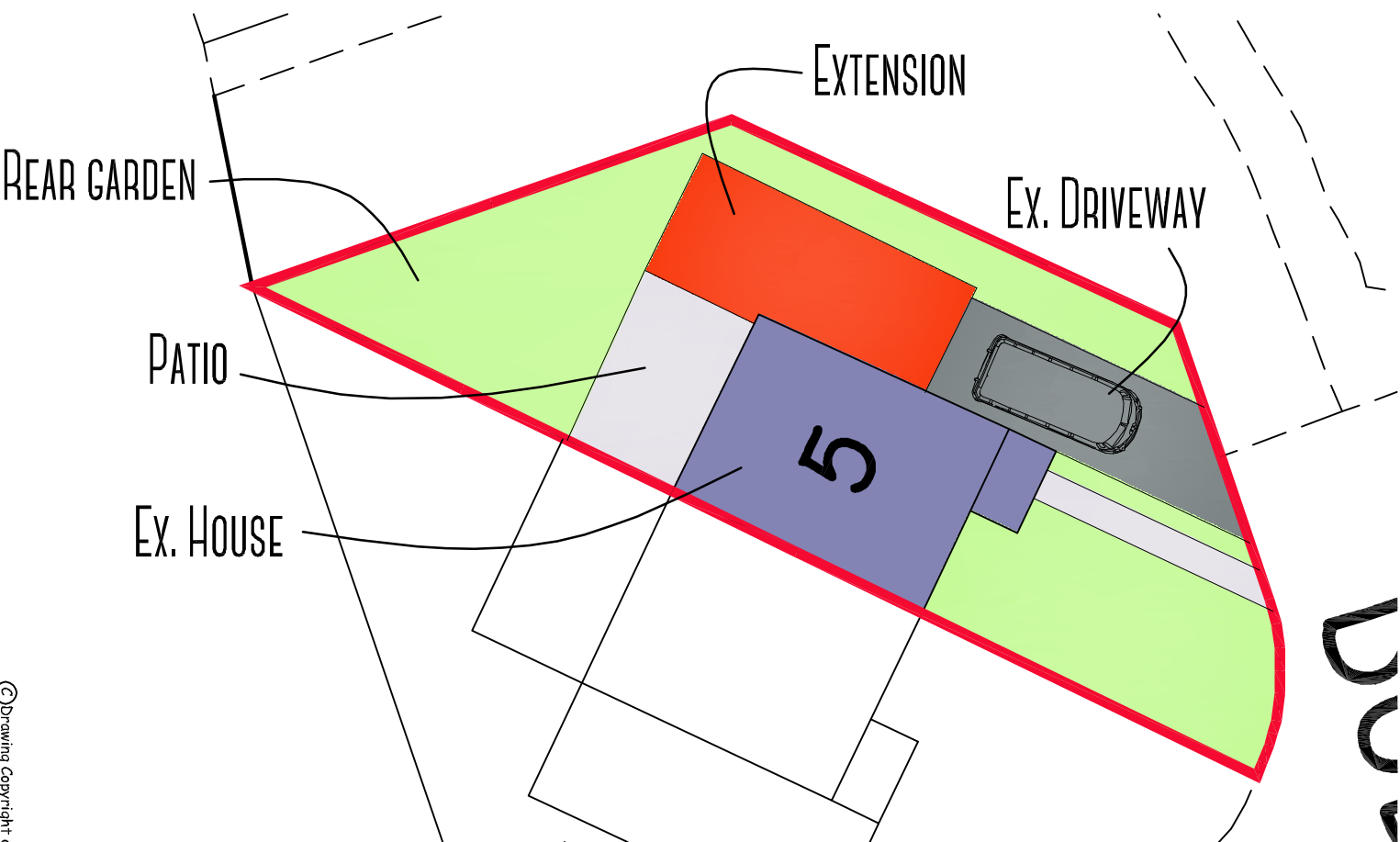

PROPOSED SITE LAYOUT PLAN

SCALE 1:200 @ A2

ALL SIZES ARE TO READ AS "OR THEREBY"

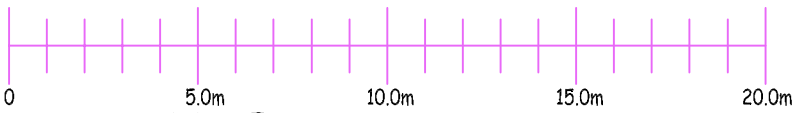

SCALE 1:200 @ A2

Amendments		Date
A	First issue	Nov 20

**kenmathieson**
ARCHITECTURAL DESIGN
& DEVELOPMENT CONSULTANT
LTD.
MANSARD HOUSE
15 Oldmeldrum Road
Bucksburn
Aberdeen
AB21 9AD
TEL: 01224 710357
FAX: 01224 710358
E-MAIL: info@kenmathieson.com

DOMESTIC, COMMERCIAL & INDUSTRIAL

Client Mr & Mrs Douglas & Yvonne Temple

Project Proposed Extension & Internal Alterations at 5 Dubford Walk, Dubford, Aberdeen, AB23 8GN

Title Site Layout & Location Plans

Scale	As Shown	Date	Nov 20	Drawn by	SM
-------	----------	------	--------	----------	----

JobNo	2516	DrgNo	SP01	Issue	A
-------	------	-------	------	-------	---

Limited Company Registered in Scotland No.229653