

Site Orientation

Position (x,y)
 The survey grid is a local grid coincident with Ordnance Survey National Grid at station 1STN. Computed using Leica Smartnet RTK network.
 Level (z)
 All Orthometric Heights are related to OSGM02 GPS Datum Computed using Leica Smartnet RTK Network

SURVEY STATIONS			
Name	Easting	Northing	Height
STN1	479679.428	148469.373	95.812
STN2	479696.916	148478.591	95.591

Notes

1. Surveyed boundary features are not necessarily legal boundaries.
2. All information contained in this drawing (including digital data) should be checked and verified prior to any fabrication or construction.
3. Copyright of all data produced by Vertex Surveys shall remain with Vertex Surveys unless otherwise specifically agreed.
4. All utilities have been identified to the best of the surveyors knowledge. The correct identification of the utility types can not be 100 percent guaranteed, therefore these should be independently verified prior to use in any design and building works. All pipe diameters and levels are assumed to be correct, however due to non entry to inspection chambers, these should be verified before any works commence. All drainage connections shown are sounded only. They have not been water tested. Services may be obscured by parked cars, leaf litter or building materials etc.
5. External eaves levels are surveyed to underside of fascia.

Legend:

		Above Ground Levels:	
Abbreviations:			

Trees & Shrubs

SPECIES ABBREVIATION

BE Beech	HZ Hazel	RH Rhododendron
CE Cedar	LA Larch	RO Rowan
CH Cherry	LB Laburnum	SAP Sapping
CCN Coniferous	LM Lime	SB Silver Birch
CY Cypress	LO Locust	SCN Sweet Chestnut
DE Dead	LJ Laurel	SHR Shrub
DEC Deciduous	MA Mistle	ST Stump
EU Eucalyptus	MG Magnolia	SY Sycamore
FR Fruit	NS Spruce	WG Wellingtonia
HA Hawthorn	PI Pine	WI Willow
HC Chestnut	PO Poplar	WN Walnut
HO Holly	PL Plane	

1. The tree species have been identified to the best of the surveyors knowledge. They have not been verified by an arborist and are not guaranteed if they are important they should be verified.
2. Tree heights (H) are estimated.
3. Trees with bole diameters below the specified minimum size may not have been surveyed.

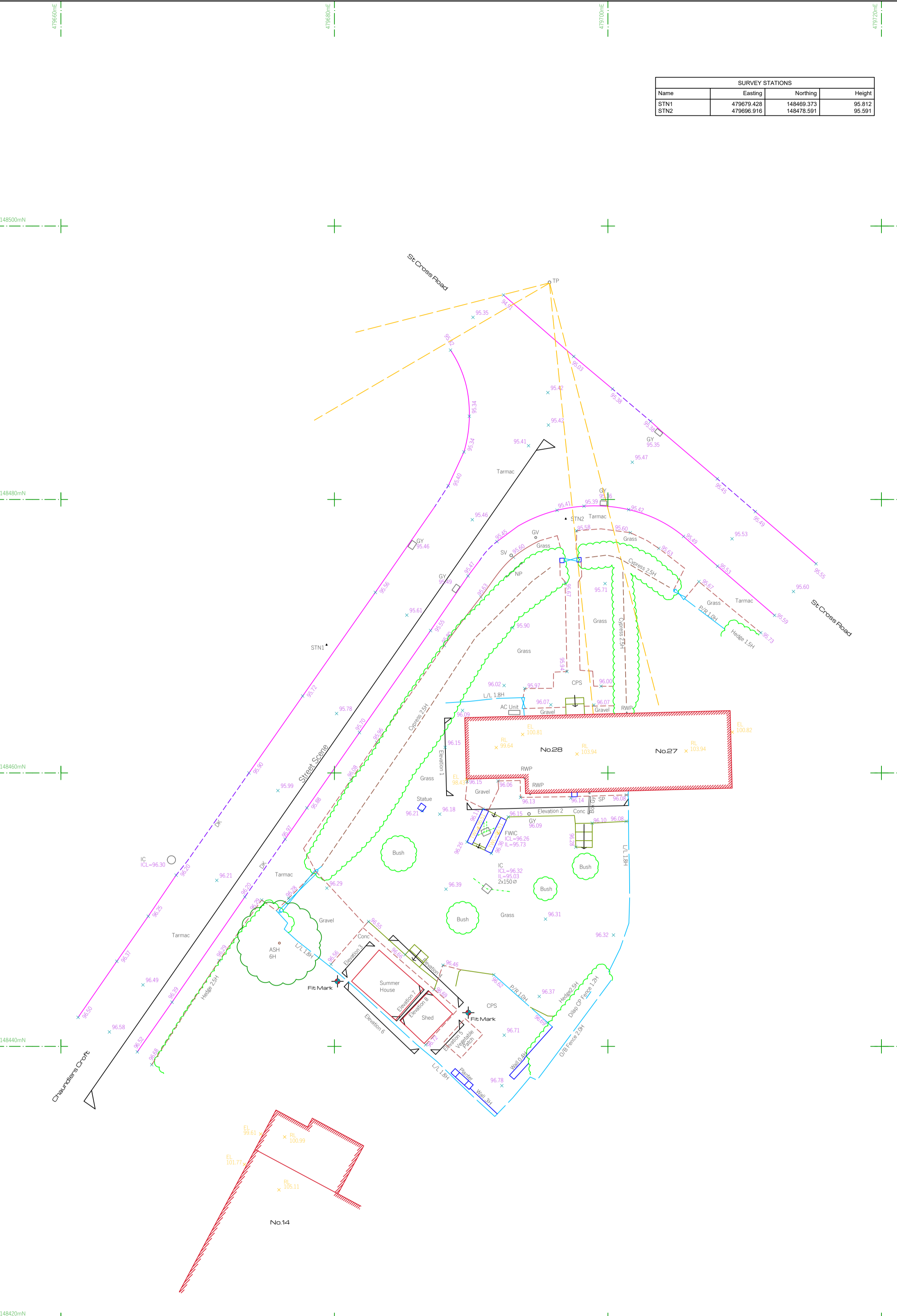

Out-Building Floor Plans

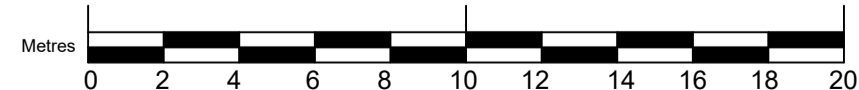
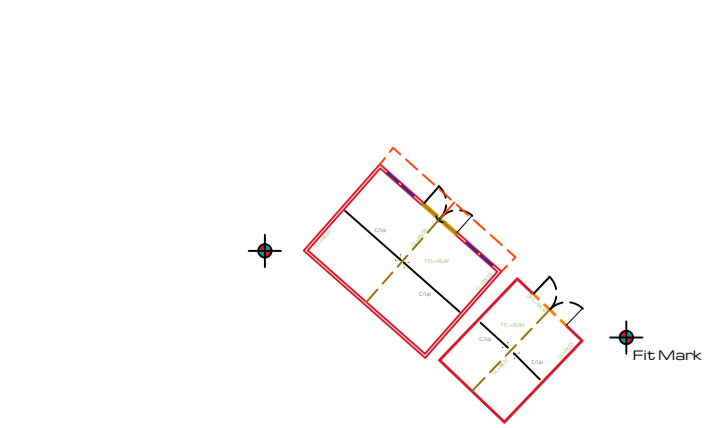

Rev. Suffix	Date	Initial	Revision Details

Surveyor: DH Drawn By: DH Checked & Issued By: AJH

Client: **Martin Littleboy**

Location: **28 St Cross Road Crondall, GU10 5PG**

Drawing Title: **Topographical Survey**

Job No: 2006071 Dwg No: 2006071-01

Sheet Size: A2 Sheets: 1 of 1

Scale: 1200 Date: July 2020

VERTEX Surveys
 Surveying | Consulting | Engineering

Vertex Surveys Limited
 5 Pathfields
 Shere T: 01483203181
 Guildford E: mail@vertexsurveysltd.com
 Surrey, GU5 9HP W: vertexsurveysltd.com

RICS
 Regulated by RICS