

68 Novar Gardens

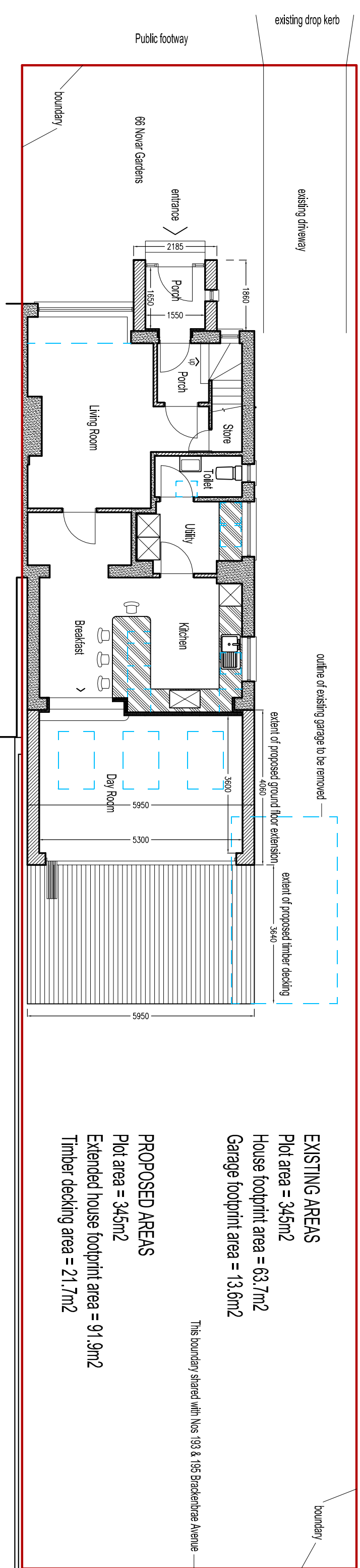

EXISTING AREAS

- Plot area = 345m²
- House footprint area = 63.7m²
- Garage footprint area = 13.6m²

This boundary shared with Nos 193 & 195 Brackenbrae Avenue

PROPOSED AREAS

- Plot area = 345m²
- Extended house footprint area = 91.9m²
- Timber decking area = 21.7m²

64 Novar Gardens

BLOCK PLAN 1 : 100 @ A3

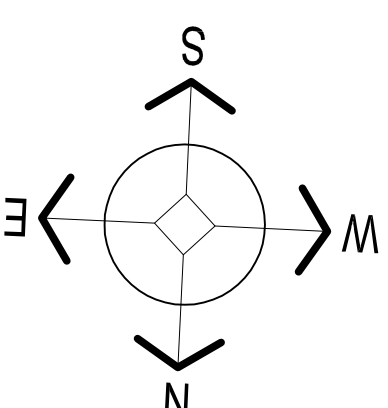

Revisions	
Client:	Mr & Mrs Raveil
Project:	Proposed House Alterations & Extension Development 66 Novar Gardens Bishopbriggs G84 2EL
Lex Wardrop MCAAT Architectural Consultant 11 Pine Court Dunne Slirling FK16 8LE	T. 01786 941273 M. 07833361496 E. lexwardrop@btinternet.com

