

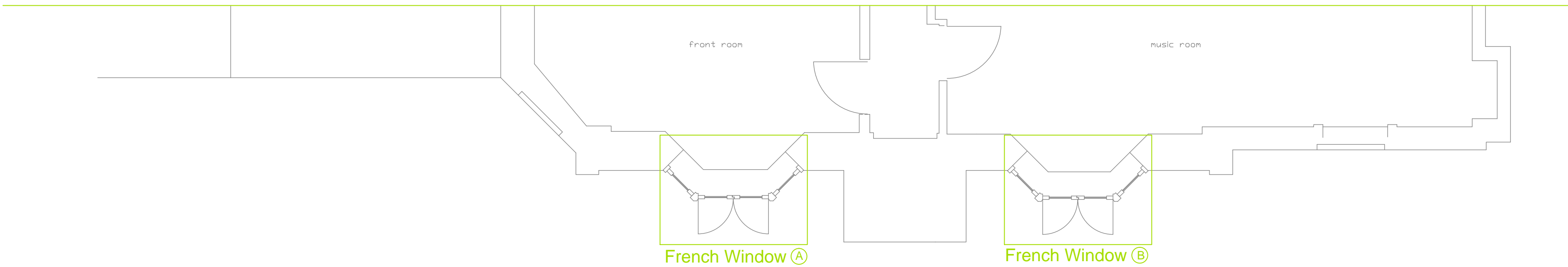

FRONT ELEVATION
AS EXISTING AND AS PROPOSED

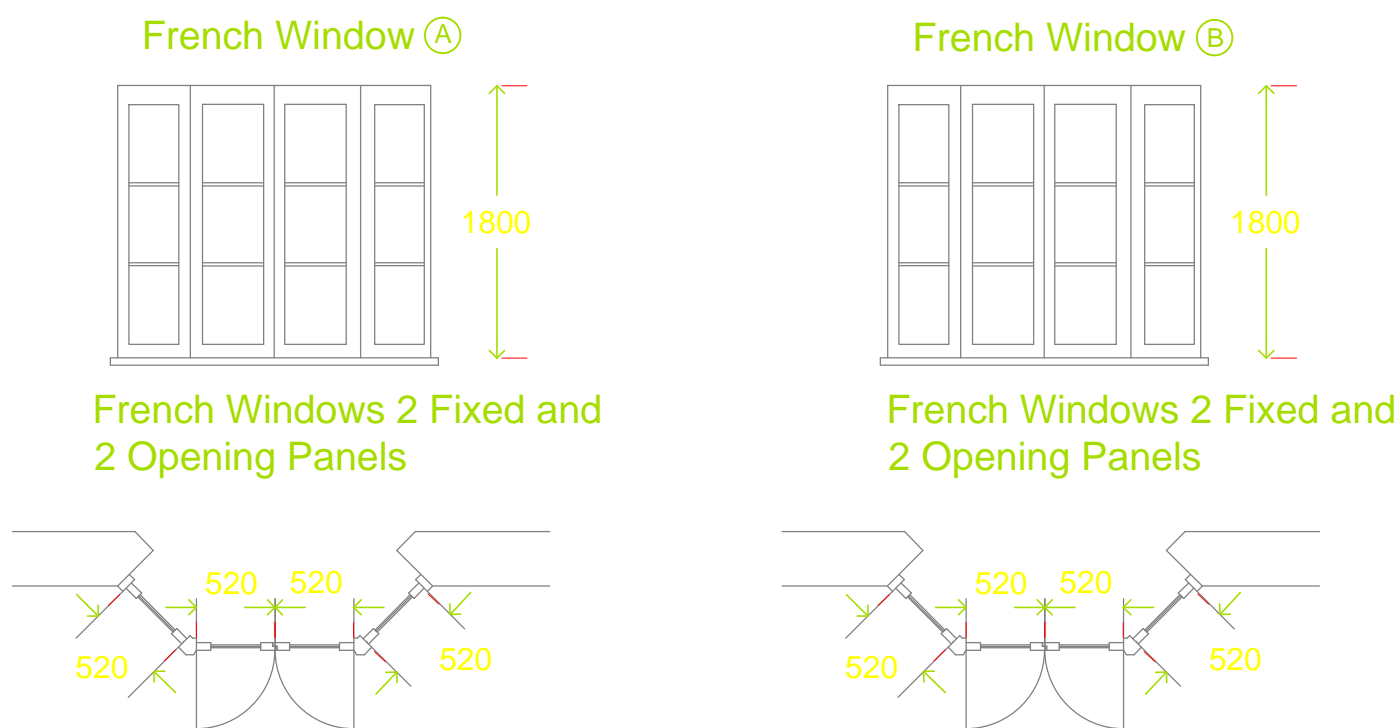

PART GROUND FLOOR PLAN (FRONT ONLY)
AS EXISTING & AS PROPOSED



FRONT WINDOW DETAILS
AS EXISTING & AS PROPOSED

SPECIFICATION NOTES

The Project is for the complete removal and replacement of the 2 sets of French Windows identified on the Drawing as Window A and Window B.

The Project to include site survey to confirm dimensions and arrangement of existing french window installation.

The Replacement French Windows shall very closely match the appearance of the existing French Windows in design and function.

Sizes indicated are approximate only and are subject to Site Survey.

French doors, window frames and cills to be treated softwood.

French doors, windows, cills and all exposed to view timber to be factory painted:
Window: gloss white as existing
Cills, Posts and Frames: gloss black as existing

Glazing to be double glazed argon filled to meet Part L Building Regulations. All glass to be clear.

French Windows to be fitted with toughened glass.

French Windows to have multi-point locking system with security locks with key way inside only.

Complete installation to have minimum 10 year comprehensive warranty.

All existing windows other than the 2 Sets of French Windows shall remain as exiting.

REV	MODIFICATIONS	DATE
-----	---------------	------

CARNELL
WARREN

CARNELL WARREN ASSOCIATES LTD
BUILDING SERVICES ENGINEERS
1-2 DUKE HOUSE, DUKE STREET
WOKING SURREY GU21 5BA
T 01483 730995 F 01483 726636
E admin@carnellwarren.co.uk



PROJECT
Beech Lodge
112 Worting Road
Basingstoke RG21 8UB

TITLE
APPLICATION FOR THE
REPLACEMENT OF
2 SETS OF FRENCH
WINDOWS

CLIENT
For:
Mr & Mrs Carnell

SCALE @ A1
1:50

DATE
01-01-21

DRN
LC

DRAWING NO.
BL/WIN/001

REV
A