

Luminaire parts list					
Index	Manufacturer	Part Code	Fitting	Luminous flux Lumen	Connected load
EX1	26 SERIES LED STREET LIGHT	SH05-40W	96xLED 3000K	5600	40W
EX2	KINGFISHER ECORAYS	SRL S OPTIC	LED 3000K	4040	40.5W
EX3	WHITECROFT SPECTREW	SPXA13HKG	1xLED 3000K	1119	14W

- * Denotes light shield mounted on luminaire to minimize light spill
- e Denotes 3Hr Emergency luminaire

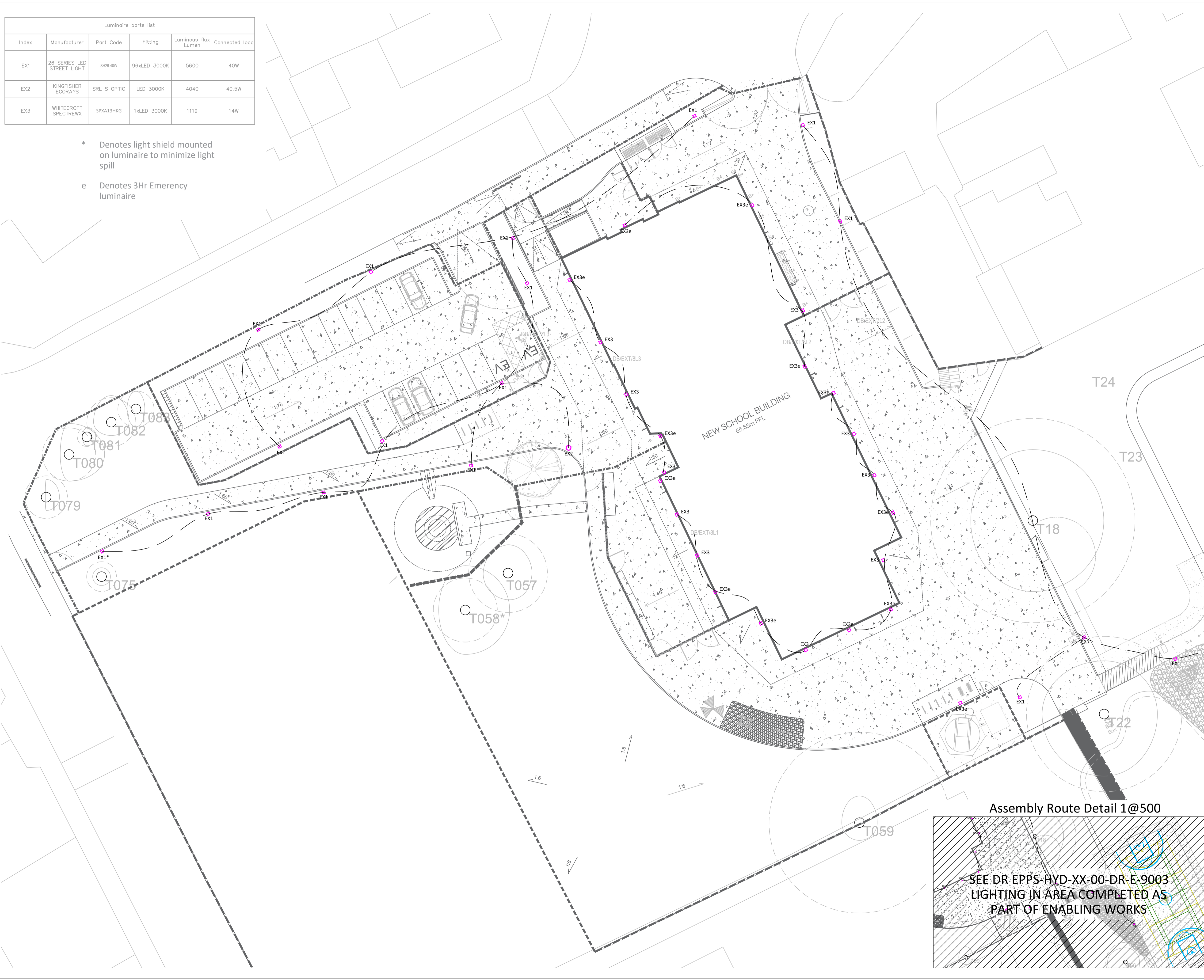

KEY PLAN

NOTES

1. ALL DIMENSIONS ARE TO BE CHECKED ON SITE BEFORE THE COMMENCEMENT OF WORKS, ANY DISCREPANCIES ARE TO BE REPORTED TO THE ARCHITECT & ENGINEER FOR VERIFICATION.
2. FIGURED DIMENSIONS ONLY ARE TO BE TAKEN FROM THIS DRAWING. THIS DRAWING IS TO BE READ IN CONJUNCTION WITH ALL RELEVANT ENGINEERS' AND SERVICE ENGINEERS' DRAWINGS AND SPECIFICATIONS. THIS DRAWING IS COPYRIGHT.
3. LUMINAIRES TO BE 3000K.
4. ALL LUMINAIRES TO BE TIME CLOCK, PHOTOCELL AND PIR CONTROLLED.
5. SEE M&E SPECIFICATION DOCUMENT FOR FURTHER DETAILS ON EXTERNAL LIGHTING CONTROL.
6. COLUMNS FOR EX1,2&3 LUMINAIRES TO BE 5M LONG.
7. THE ELECTRICAL WORKS SHALL BE CARRIED OUT IN ACCORDANCE WITH BS7671 IET WIRING REGULATIONS 18TH EDITION INCLUDING ALL CURRENT AMENDMENTS AND GUIDANCE NOTES.
8. EARTHING AND BONDING SHALL COMPLY WITH THE BS: 7671 STATUTORY REGULATIONS. WHERE CONTAINMENT IS HIDDEN OR INACCESSIBLE DRAW CORDS WILL BE REQUIRED.

REVISIONS

PO2	Revised Landscape	GP	20/01/21	ES	20/01/21	SH	20/01/21
PO1	STAGE 4a ISSUE	GP	13/11/20	ES	13/11/20	SH	13/11/20

REV	DRAWN BY	DATE	CHECKED BY	DATE	APPROVED BY	DATE

CLIENT
SOUTH GLOUCESTERSHIRE COUNCIL

MERCHANT'S HOUSE NORTH WAPPING ROAD
BRISTOL
BS1 4BW
01179459225
BRISTOLCENTRAL@HYDROCK.COM

PROJECT
ELM PARK PRIMARY SCHOOL

TITLE
ELECTRICAL SERVICES
EXTERNAL LIGHTING
LAYOUT

HYDROCK PROJECT NO. C-13890	SCALE @ A1 1:200	STATUS D2
STATUS DESCRIPTION SUITABLE FOR TENDER		REVISION P02
DRAWING NO. (PROJECT CODE-ORIGINATOR-ZONE-LEVEL-TYPE-ROLE-NUMBER) EPPS-HYD-XX-00-DR-E-9000		

