

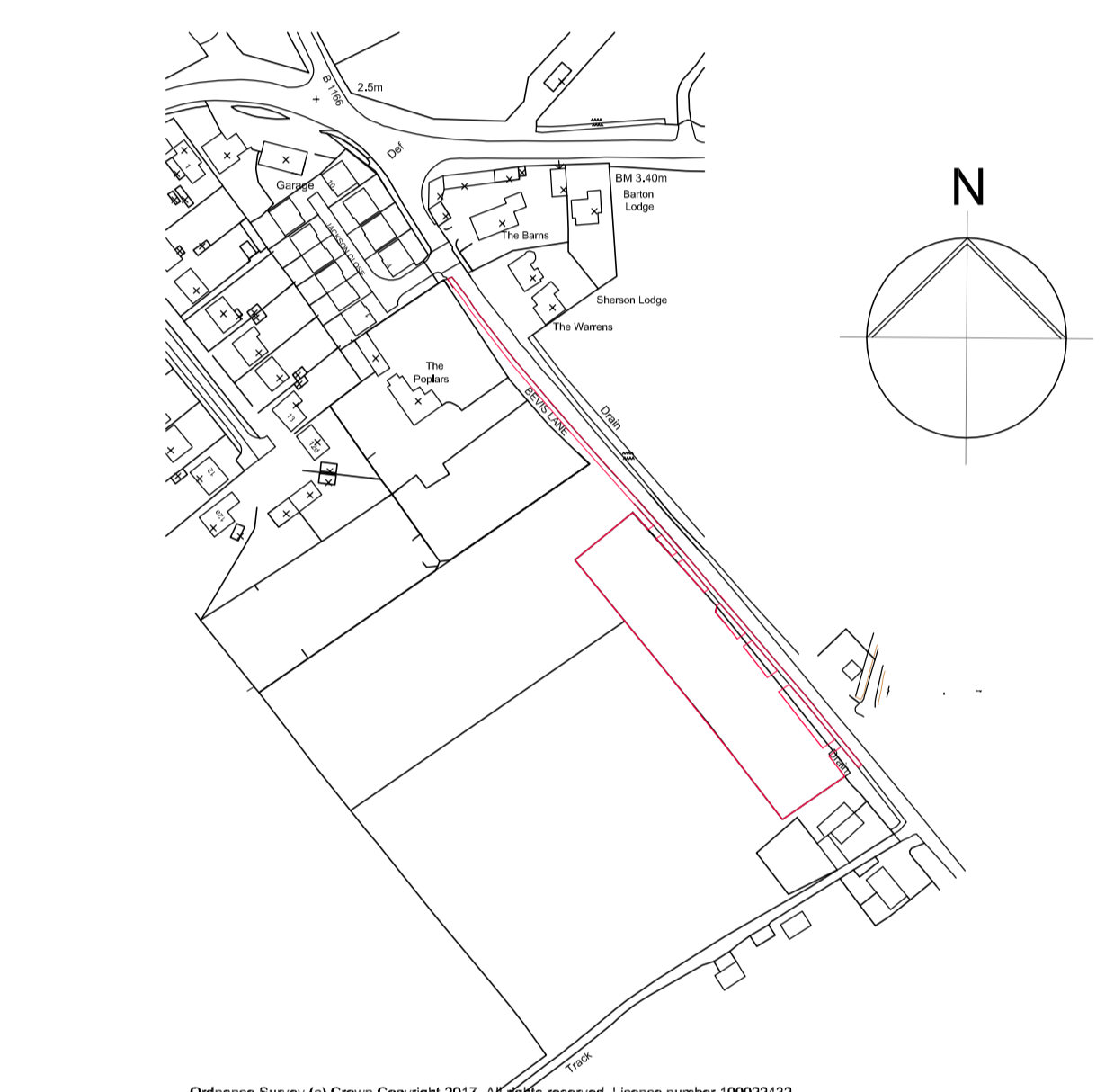

SITE PLAN 1:500



LOCATION PLAN 1:2500

SITE PLAN ILLUSTRATIVE ONLY

*Peter Humphrey Associates* Ltd.  
ARCHITECTURAL DESIGN AND BUILDING

PROJECT  
PROPOSED DEVELOPMENT

SITE  
BEVIS LANE  
WISBECH ST MARY

---

DRAWING  
PLANNING

---

CLIENT  
MR C WILLIAMS

---

DATE OCT 2020 SCALE As Shown JOB No. 6229-PL01

COPYRIGHT: THIS DRAWING MUST NOT BE ISSUED, LOANED OR COPIED WITHOUT THE CONSENT OF PETER HUMPHREY ASSOCIATES

*Peter Humphrey Associates*  
ARCHITECTURAL DESIGN AND BUILDING  
TELEPHONE: 01945 466 966  
FAX: 01945 466 433  
E-MAIL: info@peterhumphrey.co.uk  
30 OLD MARKET WISBECH CAMBS PE13 1NB

Wisbech District Council

Building Design Awards  
Category Winner 08/09/10  
Overall Winner 2010