

Existing Roof Plan
Scale 1:200

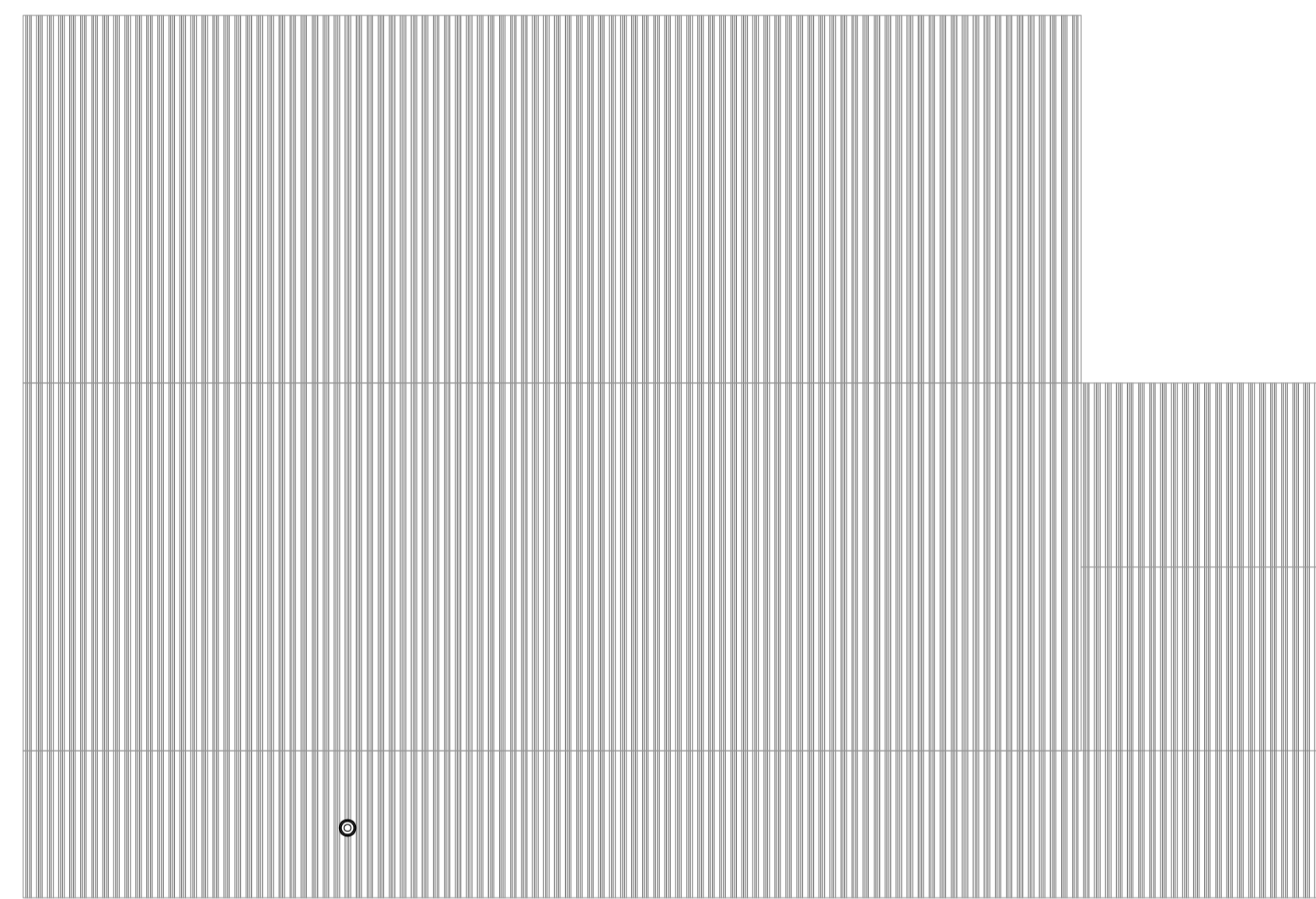

New biomass boiler flue to penetrate existing roof

Proposed Roof Plan
Scale 1:200



New biomass wood chip boiler located in plant room within existing building.
Wood chip fuel store located within existing building with access through roller shutter door for fuel delivery.

Plan of Building Showing Location of Existing Plant Room and Wood Chip Fuel Store within Existing Building

Scale 1:100

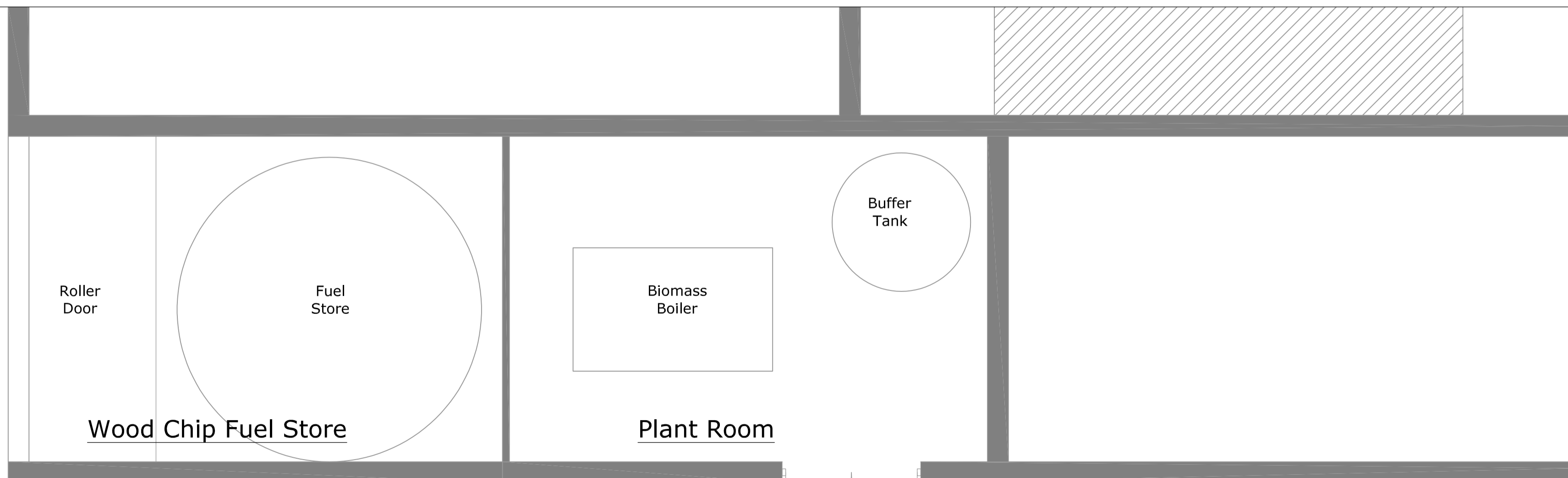

New biomass wood chip boiler located in plant room within existing building.

Wood chip fuel store located within existing building with access through roller shutter door for fuel delivery.

Detail Plan of Plant Room within Existing Building

Scale 1:50

NOTE

There are no changes to the internal or external walls, doors etc. to the building.

The plan indicates the installation of a wood chip biomass boiler, buffer tank and associated equipment to supply a new heating system to be installed within the existing building.

Revision - Date - Description -

DRAWING STATUS
Preliminary

Duncan Renewables
Unit 2
Rudgate Business Park
Rudgate
Tockwith
North Yorkshire
YO26 7RD

Tel: 01423 359600
Email: info@duncanrenewables.co.uk
Web: www.duncanrenewables.co.uk

PROJECT NAME
Service Timber 3 Planning

CUSTOMER NAME(S)
Service Timber

SITE ADDRESS
Service Timber
Timber Terminal
Brighton Airfield
Bubwith
YO8 6GJ

DRAWING TITLE
Building Plan - Plantroom & Wood Chip Store
Roof Plan - Existing & Proposed

DRAWING NUMBER
20028 / mech / M06

Drawn Peter James **Scale** 1:100 & 1:50 **Date** 16 Dec 2020