

MR MICHAL SUCH.

© THESE DRAWINGS ARE THE COPYRIGHT OF MARK GARFITT
NO PART OF THESE DRAWINGS ARE TO BE COPIED OR REPRODUCED
WITHOUT THE WRITTEN CONSENT OF THE DESIGNER.

DRAWING PREPARED FOR THE PURPOSES OF IDENTIFICATION ONLY.

DRAWING PREPARED BY:
"ARCHITECTURAL DESIGN SERVICES"
 MARK GARFITT,
 ARCHITECTURAL TECHNOLOGIST.
 Tel: 07789 996636
 Email: mark-ads@live.co.uk

CONSTRUCTION (DESIGN & MANAGEMENT) REGULATIONS 1994
APPLICABLE TO ALL PROJECTS EXCEPT WORK TO A PERSONS OWN HOUSE, OTHER
THAN THAT CARRIED OUT BY THE DEVELOPER.

THE CLIENT SHALL BE ADVISED THAT ALL PROJECTS LASTING FOR MORE THAN
THIRTY DAYS OR INCLUDE MORE THAN FOUR PEOPLE ENGAGED ON THE CONSTRUCTION
ON SITE AT ANY ONE TIME SHALL BE SUBJECT TO THE ABOVE REGULATIONS.

THE CLIENT SHALL TAKE ALL REASONABLE STEPS TO ENSURE THAT THE APPOINTED
CONTRACTORS HAVE THE COMPETENCE AND ADEQUATE RESOURCES SUFFICIENT TO
MANAGE THE CONSTRUCTION WORK AND COMPLY WITH THE ABOVE REGULATIONS.

IF THE PROJECT IS SUBJECT TO THE ABOVE REGULATIONS, THE CLIENT SHALL
APPOINT A PLANNING SUPERVISOR AND ENSURE THAT NOTICE IS SERVED ON
THE HEALTH & SAFETY EXECUTIVE AT TENDER ACCEPTANCE STAGE USING
FORM 10.

SERVICES:-
ELECTRICS ALL TO COMPLY WITH THE LATEST EDITION OF THE IEE REGULATIONS.
QUANTITY AND QUALITY OF FITTINGS TO BE AGREED WITH THE CLIENT PRIOR TO
COMMENCEMENT BY THE SUCCESSFUL CONTRACTOR. ANY ALTERATIONS TO THE
MANS TO BE CARRIED OUT WITH THE FULL CO-OPERATION OF THE LOCAL SERVICE
SUPPLIER. GAS AND HEATING WORK TO GAS SERVICE FROM METER POSITION TO
BE CARRIED OUT BY CORGI OR ACOPS REGISTERED HEATING ENGINEERS ONLY.

BUILDER TO CHECK AND TO CLARIFY ALL LEVELS, DIMENSIONS, DRAINAGE,
CONSTRUCTION AND SPECIFICATION PRIOR TO ANY WORKS ON SITE AND TO BRING TO
THE CLIENTS ATTENTION ANY VARIATIONS OR DEVIATIONS FOR WRITTEN CONFIRMATION
BEFORE BEING CARRIED OUT ON SITE.

DO NOT SCALE FROM THESE DRAWINGS - IF IN ANY DOUBT ALWAYS ASK FIRST
DRAWINGS PREPARED FOR THE PURPOSES OF OBTAINING TOWN & COUNTRY PLANNING
PERMISSION AND BUILDING REGULATION APPROVALS ONLY.

ALL MATERIALS SHALL BE FIXED, APPLIED OR MIXED IN ACCORDANCE WITH ALL OF THE
MANUFACTURERES INSTRUCTIONS, RECOMMENDATIONS AND SPECIFICATION. ALL
MATERIALS SHALL BE SUITABLE FOR THE PURPOSES THAT THEY ARE USED FOR.

THE CONTRACTOR SHALL TAKE INTO ACCOUNT EVERYTHING NECESSARY FOR THE
PROPER EXECUTION OF THE WORKS AND TO THE SATISFACTION OF THE LOCAL
AUTHORITY BUILDING INSPECTOR, WHETHER OR NOT INDICATED ON THE DRAWINGS
OR IN THE SPECIFICATION.

IT IS THE RESPONSIBILITY OF THE OWNER/CLIENT TO SERVE A NOTICE ON THE
ADJOINING OR ADJACENT NEIGHBOURS FOR THE PROPOSED WORKS UNDER
THE PARTY WALL ACT 1996. EXPLANATORY BOOKLETS CAN BE OBTAINED FREE OF
CHARGE FROM THE ODPM FREE LITERATURE, PO BOX 236, WEST YORKSHIRE,
LS23 7NB. TELEPHONE 0870-120-7405 E-mail: odpm@twoten.press.net

LOCAL AUTHORITY REF:	
CLIENT:	Mr Michal Such.
SITE ADDRESS:	49 Blyth Road WORKSOP NOTTS S81 0HP. Nottinghamshire
PROJECT:	Proposed Retention of Existing Carport and Gates.
SCALE:	1: 1250 @ A3
TITLE:	Location Plan.
DATE:	January 2021
Drawing Number 21-01 Ref: SUCH	

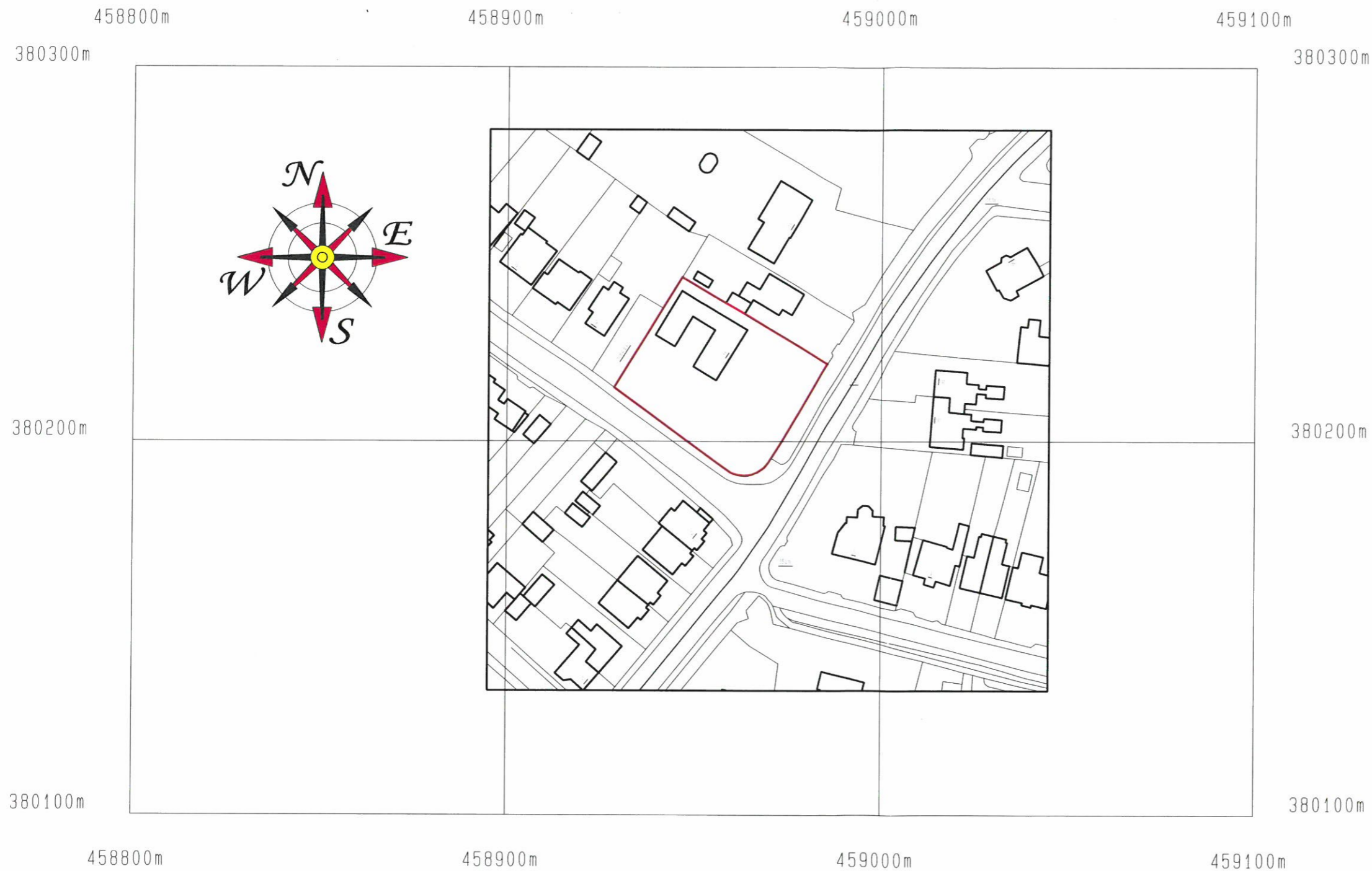

Crown Copyright and database rights 2020 OS Licence no. 100041041

