

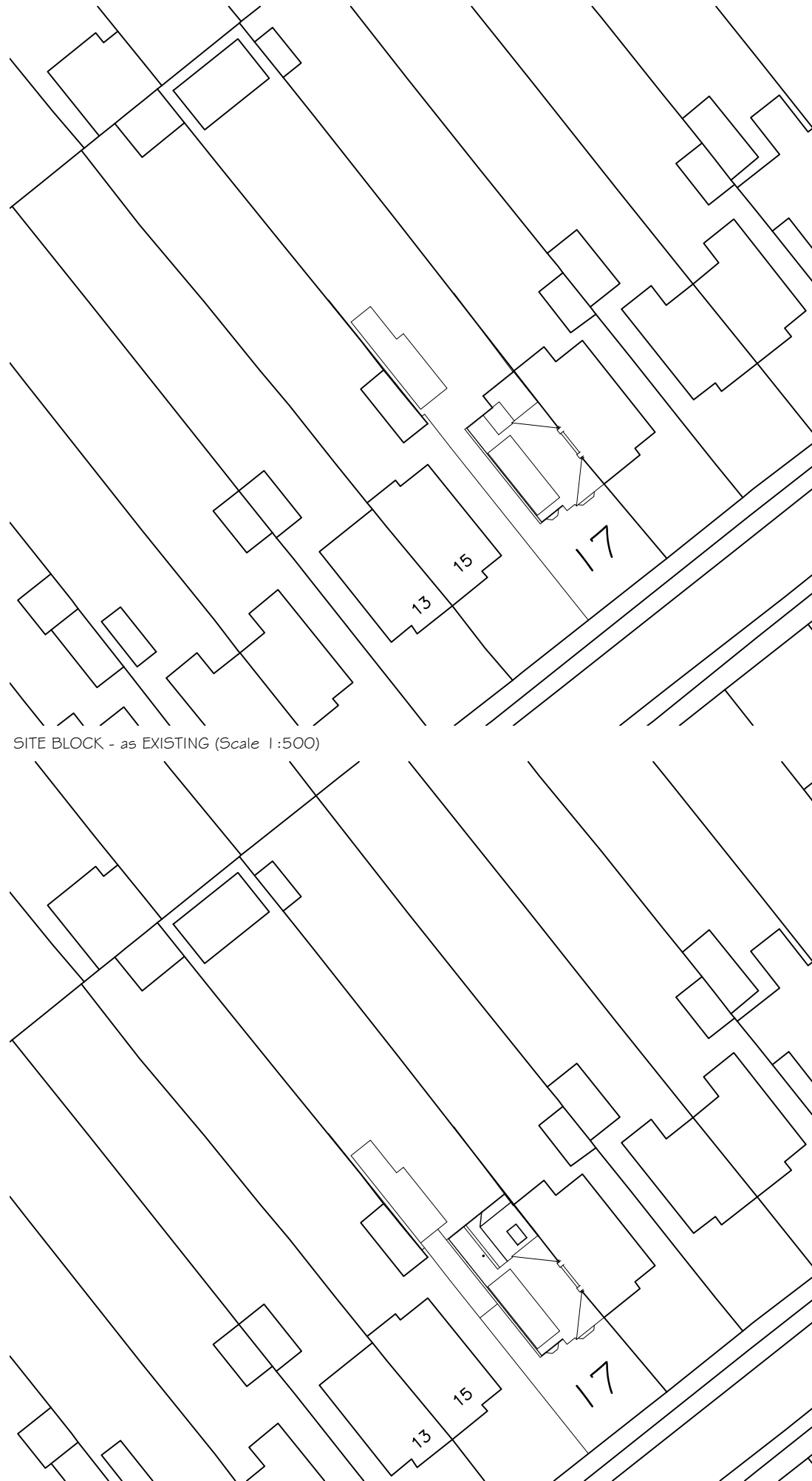

SITE LOCATION - as EXISTING
(Scale 1:1250)



SITE BLOCK - as EXISTING (Scale 1:500)

SITE BLOCK - as PROPOSED (Scale 1:500)

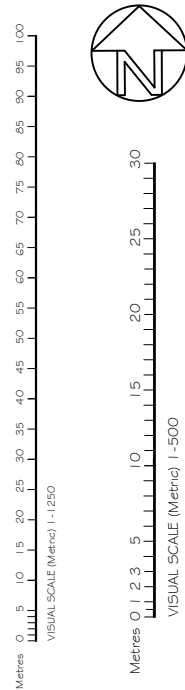

Notes

Do not scale for construction purposes.

Check all dimensions and levels on site before commencing work or preparing any shop drawings and report any discrepancies to avoid abortive work.

This drawing and design are the copyright of the DCH&P and must not be copied or reproduced either in whole or in part without prior permission from DCH&P.

All materials, components and workmanship are to comply with the requirements of the latest relevant British Standard Code of Practice and appropriate manufacturer's recommendations.

All work is to be carried out to the satisfaction of the Local Authority and to comply with the current Building Regulations.

This drawing is to be read in conjunction with the standard specification and preliminary items prepared by D C Hudson and Partner LLP together with the appropriate details.

CDM Regulations 2015

It is assumed the information contained in this drawing will be constructed and carried out by a competent contractor or skilled person, familiar with this type of work and provided they have the skills, knowledge, experience and the organisational capability necessary to carry out those roles, in a way that secures health and safety and CDM compliance.

A	Carport added	Jan 21
Rev.	Amendment	Date

Drawing Title

Location & Block Plans - as existing & Proposed

Project

PROPOSED SINGLE-STOREY REAR EXTENSION AT 17 PALMER ROAD ALLINGTON MAIDSTONE KENT ME16 0DL

Client

Mr J & Mrs L MOREAU

Scale

1:1250 & 1:500 @A3

Date

Mar 2020

D C HUDSON & PARTNER LLP

CHARTERED ARCHITECTS

The Doctors House
Royal British Legion Village
Hall Road
Aylesford
Kent ME20 7QX
Tel: (01622) 791189

E-mail: info@dchudson.co.uk
Web: www.dchudson.co.uk

Drawing Number	2172/01	Rev	A
----------------	---------	-----	---

THIS DRAWING IS COPYRIGHT