

# S-series

for three phase alternating current, 4 pole

RD35S-4D



## Description

Motor technology: AC  
 Rated voltage  $U_N$ : 3- 400 V ( $\Delta$ )  $\pm 10$  %\*  
 Rated frequency  $f_N$ : 50 Hz\*  
 Motor input power  $P_1$ : 5.50 kW\*  
 Rated current  $I_N$ : 8.70 A\*  
 Rated speed  $n_N$ : 1240 min<sup>-1</sup>\*  
 Thermal class: THCL155\*  
 Min. permitted ambient temperature  $t_{R(min)}$ : -20 °C  
 Max. permitted ambient temperature  $t_{R(max)}$ : 4 °C  
 Minimum pressing  $p_{SF(min)}$ : 380 Pa  
 Protection class: IP54  
 Motor protection: thermal contact  
 Impeller : Impeller made of galvanised sheet metal,  
 Motor: 1 coat paint, pebble grey  
 Conformity: ErP 2015, CE  
**ErP-data**  
 Efficiency  $\eta_{statA}$ : 49.5 %  
 Efficiency:  $N_{actual} = 53.1 / N_{target} = 44$ \*\*  
 \* Rated data  
 \*\*ErP 2015

## Characteristic curve

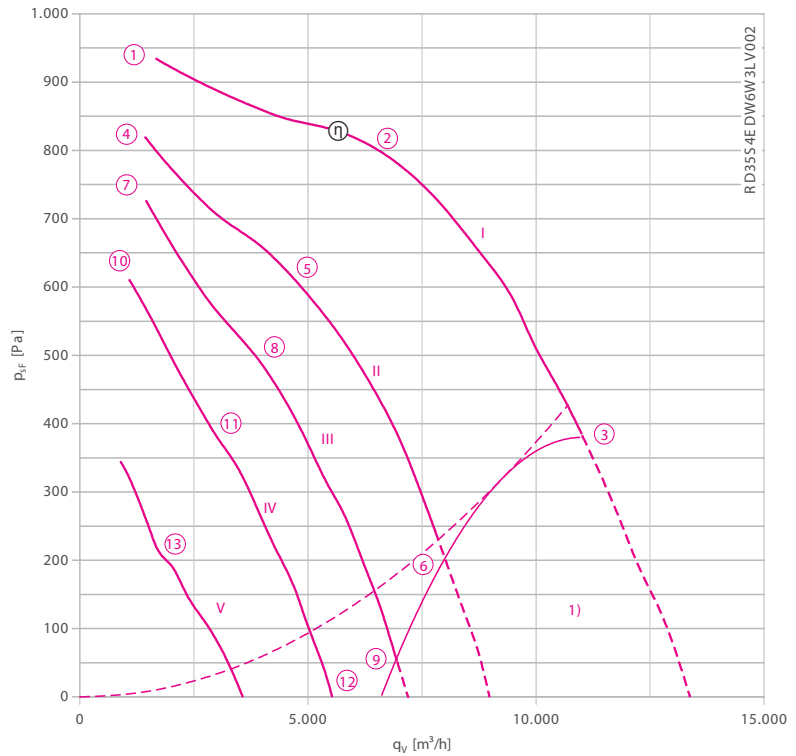

Measured in scroll from ZIEHL-ABEGG.

1) Do not operate in this area

- Connection diagram
- System components

1360-106XB

Page 367  
Page 262

## Dimensions [mm]

Fan with housing, double inlet  
without flange

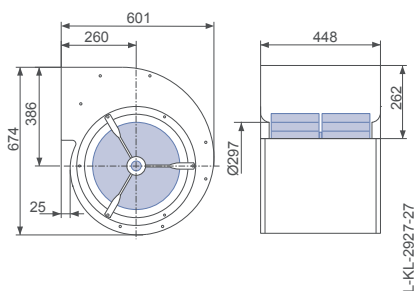

Fan with scroll, double inlet  
with flange

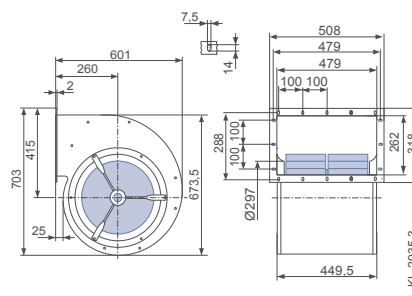



Performance data

Type	Characteristic curve	Voltage	Operating point	Current	Motor input power	Speed	Suction side sound power level
		U [V]		I [A]	P <sub>i</sub> [W]	n [min <sup>-1</sup> ]	L <sub>WAS</sub> [dB]
RD35S-4DW.6W.3L	I	400	①	3.10	1200	1450	
		400	②	5.60	3300	1350	91
		400*	③	8.70*	5500*	1240*	96
	II	230	④	2.90	1000	1370	
		230	⑤	5.00	1790	1240	86
		230	⑥	8.70	3100	930	86
	III	180	⑦	3.20	900	1290	
		180	⑧	5.60	1600	1060	83
		180	⑨	8.40	2300	730	80
	IV	140	⑩	3.50	770	1180	
		140	⑪	5.10	1100	970	77
		140	⑫	7.70	1580	490	82
	V	90	⑬	4.50	600	660	

\*rated data

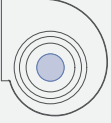
Fan ordering information

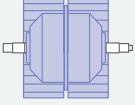
Design	RD (without flange)	RD (with flange)	RZ
Installation position	H	H	H
Electrical connection	Connecting cable axial 115 cm from axle end	Connecting cable axial 115 cm from axle end	Connecting cable axial 115 cm from axle end
			
<b>Type</b>	<b>RD35S-4DW.6W.3L</b>	<b>RD35S-4DW.6W.3L</b>	<b>RZ35P-4DW.6W.3L</b>
<b>Article no.</b>	<b>109616</b>	<b>122297</b>	<b>109617</b>
Weight [kg]	64.30	65.40	48.00

Control technology

<p>Frequency inverter Control 3~</p>  <p>➤ Page 302</p>	<p>Motor protection units 3~</p>  <p>➤ Page 344</p>	<p>Transformer-based controllers 3~</p>  <p>➤ Page 334</p>	<p>Electronic voltage controllers 3~</p>  <p>➤ Page 324</p>
--	--	---	--

Motorised impeller

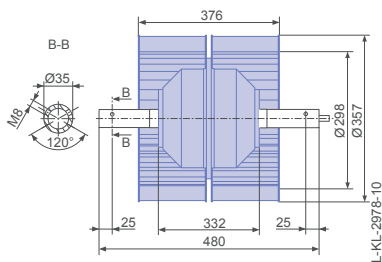

Used scroll

