

Application to determine if prior approval is required for a proposed: Erection, Extension or Alteration of a Building for Agricultural or Forestry use

Town and Country Planning (General Permitted Development) (England) Order 2015 (as amended) - Sch 2, Part 6, Class A/B/E

Privacy Notice

This form is provided by Planning Portal and based on the requirements provided by Government for the sole purpose of submitting information to a Local Planning Authority in accordance with the legislation detailed on this form.

Please be aware that once you have downloaded this form, Planning Portal will have no access to the form or the data you enter into it. Any subsequent use of this form is solely at your discretion, including the choice to complete and submit it to a Local Planning Authority in agreement with the declaration section.

Upon receipt of this form and any supporting information, it is the responsibility of the Local Planning Authority to inform you of its obligations in regards to the processing of your application. Please refer to its website for further information on any legal, regulatory and commercial requirements relating to information security and data protection of the information you have provided.

Local Planning Authority details:



Council Offices
Parkside
Station Approach
Burton Street
Melton Mowbray
LE13 1GH
Tel: 01664 502502
Email: developmentcontrol@melton.gov.uk

Publication on Local Planning Authority websites

Information provided on this form and in supporting documents may be published on the authority's planning register and website. Please ensure that the information you submit is accurate and correct and does not include personal or sensitive information. If you require any further clarification, please contact the Local Planning Authority directly.

1. Applicant Name and Address

Title: First name:

Last name:

Company (optional):

Unit: House number: House suffix:

House name:

Address 1:

Address 2:

Address 3:

Town:

County:

Country:

Postcode:

2. Agent Name and Address

Title: First name:

Last name:

Company (optional):

Unit: House number: House suffix:

House name:

Address 1:

Address 2:

Address 3:

Town:

County:

Country:

Postcode:

3. Site Address Details

Please provide the full postal address of the application site.

Unit: House number: House suffix:

House name:

Address 1:

Address 2:

Address 3:

Town:

County:

Postcode (optional):

Description of location or a grid reference.
(must be completed if postcode is not known):

Easting: Northing:

Description:

4. The Proposed Building

Please indicate which of the following are involved in your proposal

A new building An extension An alteration

Please describe the type of building:

Please state the dimensions:

| | | |
|-----------------|-------|--------|
| Length | 214.4 | metres |
| Height to eaves | 8 | metres |
| Breadth | 33.5 | metres |
| Height to ridge | 10 | metres |

Please describe the walls and the roof materials and colours:

| | |
|--------------------------|-------------------------|
| Walls - Materials: | BOX PROFILE |
| Walls - External colour: | GREEN |
| Roof - Materials: | FIBRE CEMENT |
| Roof - External colour: | SLATE TO MATCH EXISTING |

Has an agricultural building been constructed on this unit within the last two years? Yes No

| | | |
|--|----------------------|---------------------|
| If Yes: What is the overall ground area: | <input type="text"/> | metres ² |
| What is its distance from the proposed new building: | <input type="text"/> | metres |

Would the proposed building be used to house livestock, slurry or sewage sludge? Yes No

If Yes will the building be more than 400 metres from the nearest house excluding the farmhouse? Yes No

Would the ground area of the proposed agricultural building exceed 1000 sq metres? Yes No

Has any building, works, pond, plant/machinery, or fishtank been erected within 90 metres of the proposed development within the last 2 years? Yes No

5. Agricultural and Forestry Developments

What is the total area of the entire agricultural unit? Square metres/Hectares (delete as appropriate).

What is the area of the parcel of land where the development is to be located? Please tick only one box:
 1 hectare or more Less than 1 hectare but at least 0.4 hectare Less than 0.4 hectare

How long has the land on which the proposed development would be located been in use for agriculture for the purposes of a trade or business? Years: Months:

Is the proposed development reasonably necessary for the purposes of agriculture? Yes No

If Yes, please explain why:

Is the proposed development designed for the purposes of agriculture? Yes No

If Yes, please explain why:

Does the proposed development involve any alteration to a dwelling? Yes No

Is the proposed development more than 25 metres from a metalled part of a trunk or classified road? Yes No

Is the proposed development within 3 kilometres of an aerodrome? Yes No

What is the height of the proposed development? metres Not applicable

Would the proposed development affect an ancient monument, archaeological site or listed building or would it be within a Site of Special Scientific Interest or a local nature reserve? Yes No

If Yes please provide details:

6. Planning Application Requirements - Checklist

Please read the following checklist to make sure you have sent all the information in support of your proposal. Failure to submit all information required will result in your application being deemed invalid. It will not be considered valid until all information required by the Local Planning Authority (LPA) has been submitted.

The original and 3 copies* of a completed and dated application form:

The correct fee:

The original and 3 copies* of a plan which identifies the land to which the application relates drawn to an identified scale and showing the direction of North:

*National legislation specifies that the applicant must provide the original plus three copies of the form and supporting documents (a total of four copies), unless the application is submitted electronically or, the LPA indicate that a smaller number of copies is required. LPAs may also accept supporting documents in electronic format by post (for example, on a CD, DVD or USB memory stick). You can check your LPA's website for information or contact their planning department to discuss these options.

7. Declaration

I/we hereby apply for planning permission/consent as described in this form and the accompanying plans/drawings and additional information. I/we confirm that, to the best of my/our knowledge, any facts stated are true and accurate and any opinions given are the genuine opinions of the person(s) giving them.

Signed - Applicant:

[Redacted Signature]

Or signed - Agent:

[Redacted Signature]

Date (DD/MM/YYYY):

07/01/2021

(date cannot be pre-application)

8. Applicant Contact Details

Telephone numbers

Country code: National number:

Extension number:

[Redacted Contact Details]

9. Agent Contact Details

Telephone numbers

Country code: National number:

Extension number:

[Redacted]

[Redacted]

[Redacted]

Country code:

Mobile number (optional):

[Redacted]

[Redacted]

Country code:

Fax number (optional):

[Redacted]

[Redacted]

Email address (optional):

[Redacted]

10. Site Visit

Can the site be seen from a public road, public footpath, bridleway or other public land? Yes No

If the planning authority needs to make an appointment to carry out a site visit, whom should they contact? (Please select only one)

Agent

Applicant

Other (if different from the agent/applicant's details)

If Other has been selected, please provide:

Contact name:

[Redacted]

Telephone number:

[Redacted]

Email address:

[Redacted]

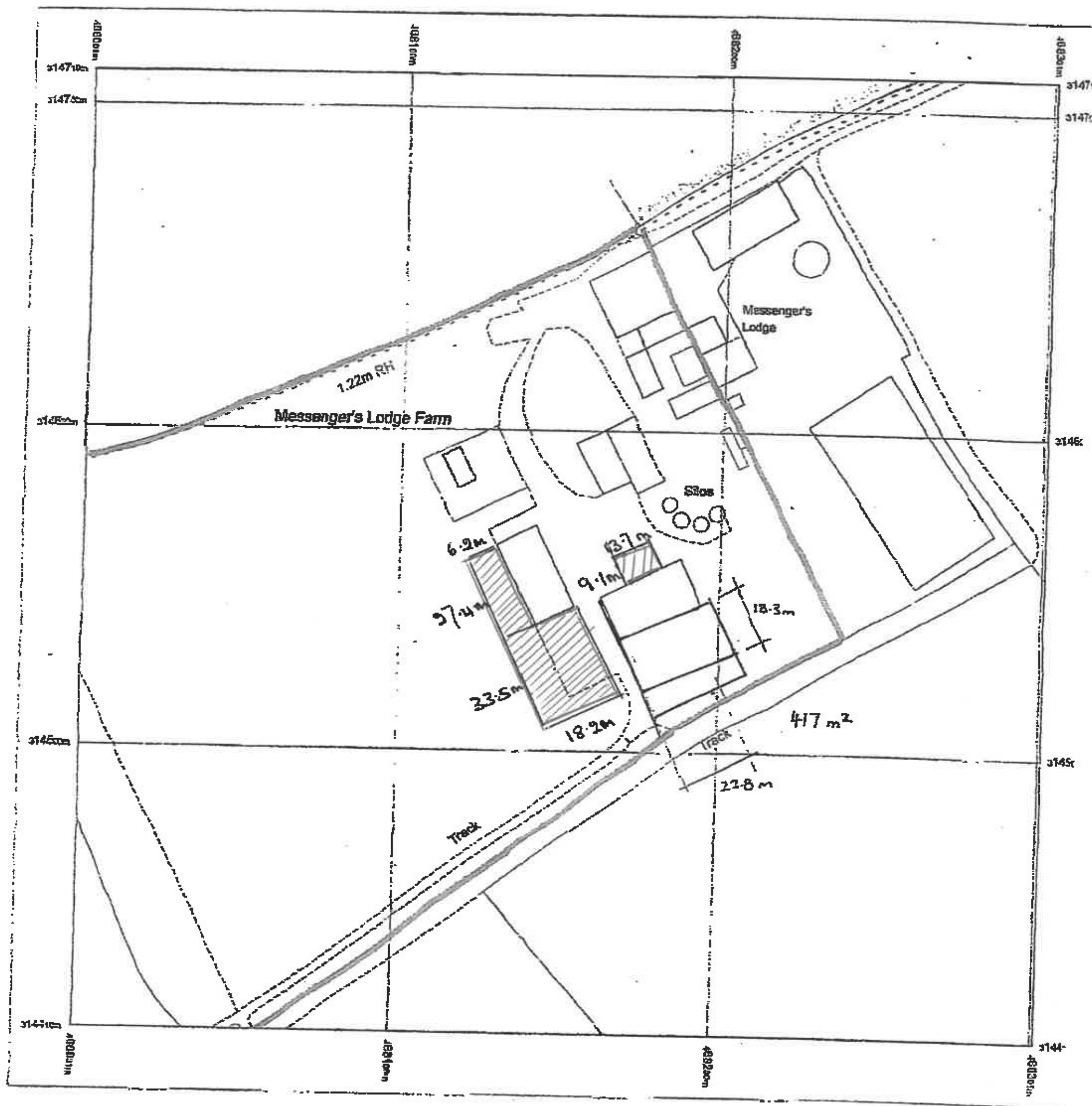

Produced 21.03.2011 from the Ordnance Survey National Geographic Database and incorporating surveyed revision available at this date. © Crown Copyright 2011.

Reproduction in whole or part is prohibited without the prior permission of Ordnance Survey.

Ordnance Survey, the OS Symbol and OS Sitema are registered trademarks of Ordnance Survey, the national mapping agency of Great Britain.

The representation of a road, track or path is no evidence of a right of way.

The representation of features as lines is no evidence of a property boundary.

Part or all of this OS Sitema is enlarged from mapping produced at one or more of the following scales: 1:250, 1:2500, 1:10000.



Supplied by: Meridian Maps
 Servid number: 08590000
 Centre coordinates: 488154 314530.5

Further information can be found on the OS Sitema Information leaflet or the Ordnance Survey web site: www.ordnancesurvey.co.uk

Messengers Lodge Farm
 Rotherby Lane
 GADDESBY
 Leicester
 LE4 7WN