

Property Referred To;

Property Referred To;

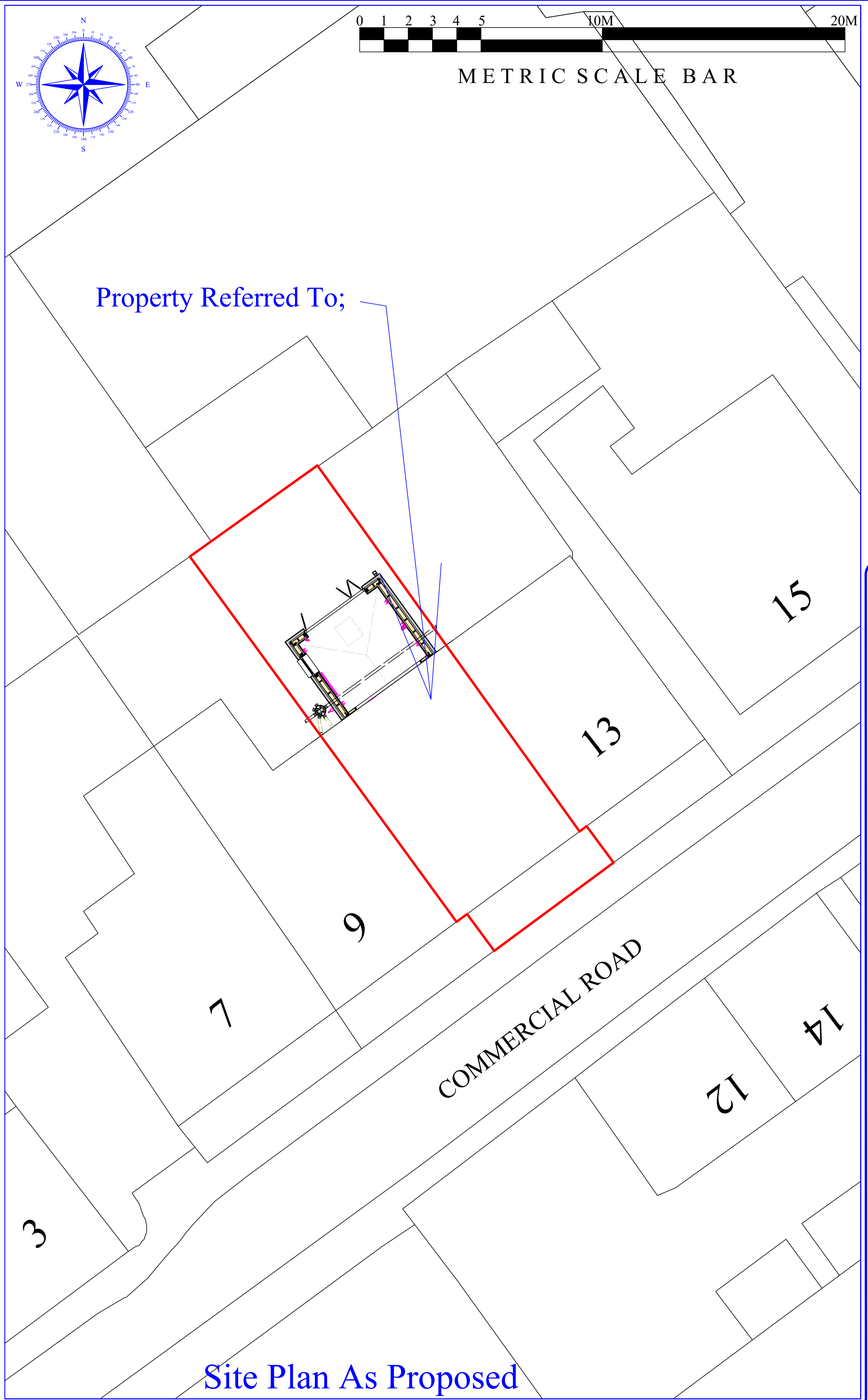
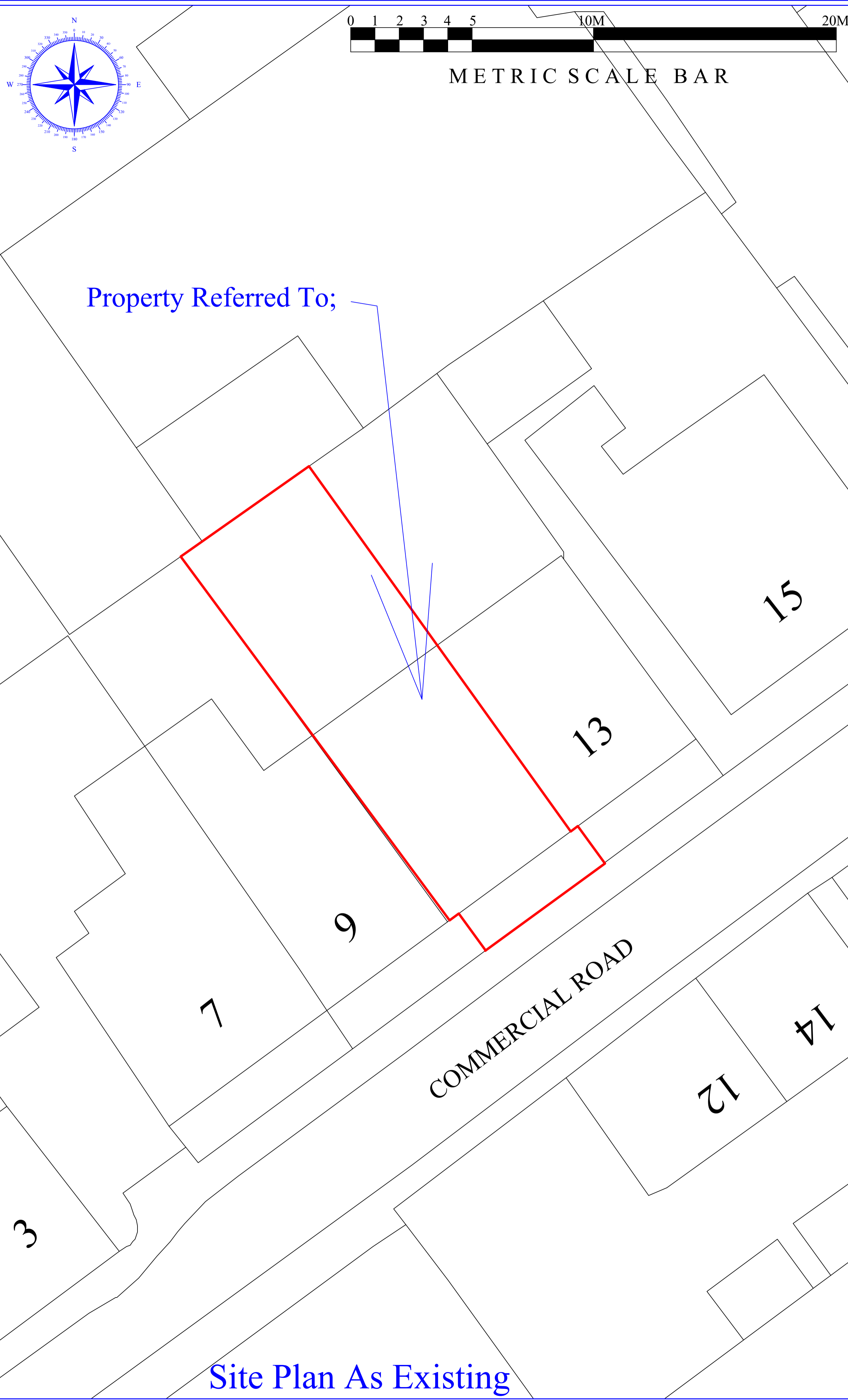

Site Plan As Existing

Site Plan As Proposed

©YEOMAN ARCHITECTURE LIMITED
 Copyright of this plan is retained by YEOMAN ARCHITECTURE LIMITED
 No part should be copied or reproduced without the express permission of the copyright holder.

ALL DIMENSIONS MUST BE CHECKED ON-SITE AND NOT SCALED FROM THIS DRAWING. ANY DISCREPANCIES MUST BE REPORTED TO YEOMAN ARCHITECTURE LIMITED. Whilst every effort has been made to ensure the accuracy of this plan and specifications, Contractors should make their own full assessment of the site conditions therein, always prior to commencement of works on-site.

No.	Revision / Amendment List:	Date:

YEOMAN ARCHITECTURE LIMITED is a Registered Professional Practice with the Chartered Institute of Architectural Technologists

YEOMAN
Architecture

Suite 6
5 Kings Mount
Ramparts Business Park
Berwick Upon Tweed
Northumberland
TD15 1TQ

Telephone: 01289 303960
E-Mail: yeomandesign@aol.com

Yeoman Architecture Limited
Registered in England & Wales. Company Number: 10953490

Client: Mr Simon Laidlaw & Ms Megan Bradley

Project Address: 11 Commercial Road
Spittal
Berwick Upon Tweed
Northumberland
TD15 1RQ

Project: Proposed Single Storey
Rear Extension and Attic Conversion

Sheet Title: First and Second Layout and Sectional Plan

Scale: 1:100mm @ A1 Size

Date: 27th January 2021

Designed by: James Cromarty
Direct Mobile No: 0772 969 0520



Drawing No: A104
Plan Ref: SL/201/20