

This drawing and the copyright is the property of MDArchitecture Limited and is not to be disclosed to or copied in any way to any third party without the written consent of MDArchitecture Limited.

The use of this data by the recipient acts as an agreement of the following statements. Do not use this data if you do not agree with any of the following statements.

All drawings are based upon site information supplied by third parties and as such their accuracy cannot be guaranteed. All features are approximated and do not constitute a guarantee of accuracy, service enquiries and confirmation of the legal boundaries.

Use figured dimensions in all cases. Check all measurements on site. Report any discrepancies in writing to the Architect before proceeding.

Notes:

- 1 Reconstituted Cotswold stone roof tiles to match existing
- 2 Polyester powder coated aluminium framed double glazed skylights
- 3 Five glass flat roof, laid to falls, with Cotswold stone gravel covering
- 4 Metal coping
- 5 Painted timber fascia and soffits
- 6 Painted roughcast reinforced wall to match existing
- 7 Polyester powder coated aluminium framed double glazed roof folding doorset
- 8 Solid oak oak door and frame
- 9 Powder coated profiled sheet roofing over oak sub frame
- 10 Painted metal rain water goods to match existing
- 11 Faced terrace

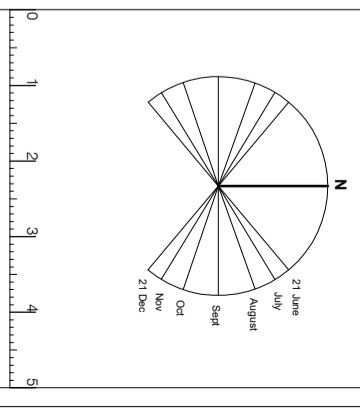
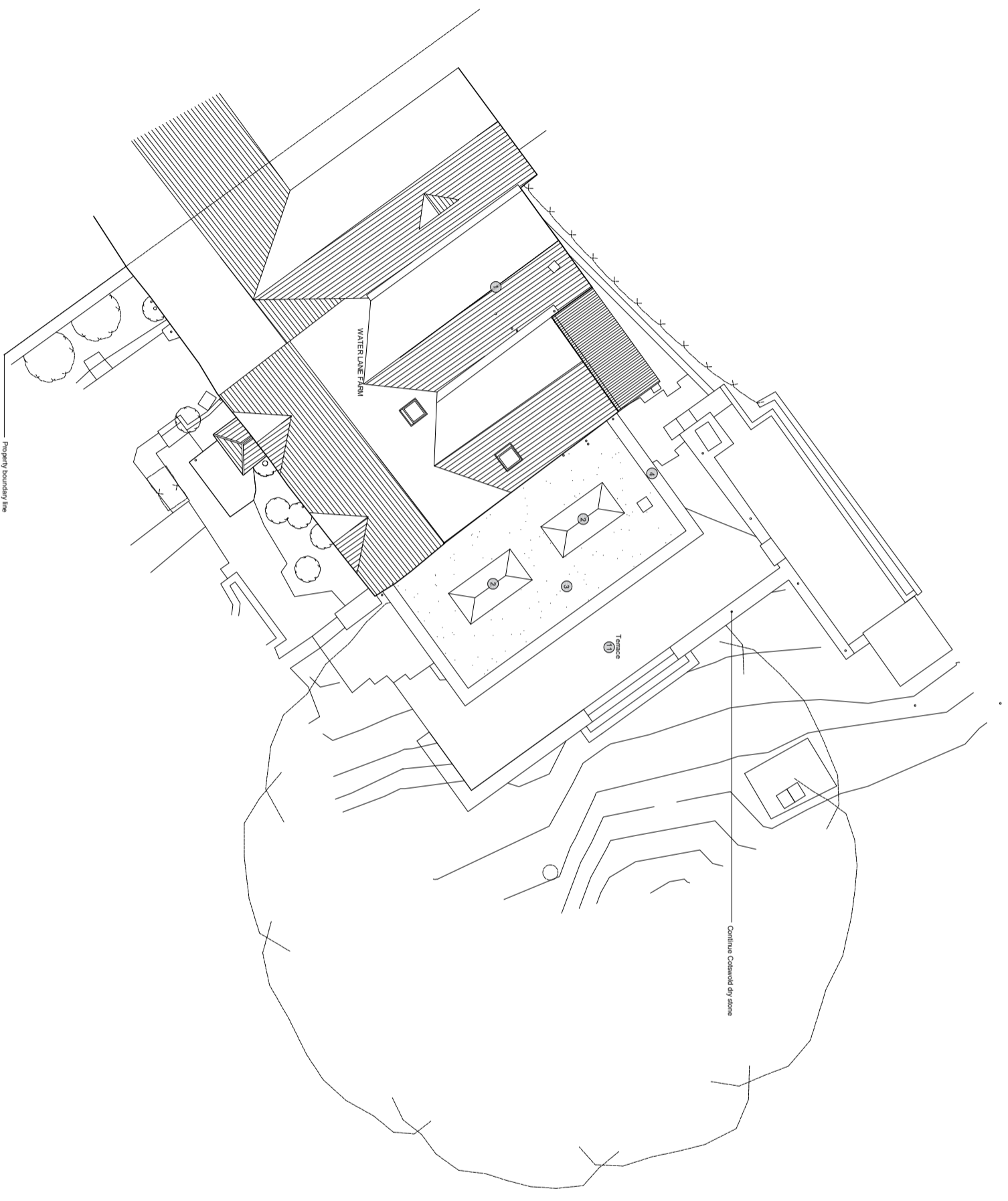

Rev.	Date:	Notes:
-	-	-
-	-	-
-	-	-
-	-	-
-	-	-
-	-	-
-	-	-
-	-	-
-	-	-
-	-	-
-	-	-

architecture^{no}
 MDArchitecture Limited
 31 Dixie Street, Cirencester, Gloucestershire, GL7 2PP
 t: 01295 252333
 e: admin@mdarchitecture.co.uk

Project:
 Refurbishment & Extension Works at
 Water Lane Farm, Water Lane, Selsley,
 Stroud, GL5 5LW

Drawing:
 Site and Roof Plan as Proposed

Job & Drawing Number:
P252-1.2

Scale: 1:100@A1
First Issue Date: ---/---/11
Revision: -
Revision Date: