

THE DESIGN AND LAYOUT IN THIS DRAWING ARE THE COPYRIGHT OF CAD ARCHITECTS LTD. AND MAY NOT BE AMENDED OR ADAPTED FOR ANY PURPOSE WITHOUT THE EXPRESS WRITTEN APPROVAL OF CAD ARCHITECTS LTD.  
 THE DRAWING IS TO BE USED SOLELY FOR THE INTENDED PURPOSE AND THE ARCHITECT ACCEPTS NO RESPONSIBILITY FOR ANY ERRORS OR OMISSIONS ARISING THROUGH UNAUTHORISED USE.  
 CONTRACTORS MUST CHECK ALL DIMENSIONS ON SITE. ONLY FIGURED DIMENSIONS ARE TO BE WORKED FROM. TAKE SITE DIMENSIONS FOR ALL FABRICATION WORK. REFER ALL DISCREPANCIES AND REQUIREMENTS FOR ADDITIONAL INFORMATION TO THE ARCHITECT FOR CLARIFICATION OF INSTRUCTION BEFORE PUTTING WORK IN HAND.

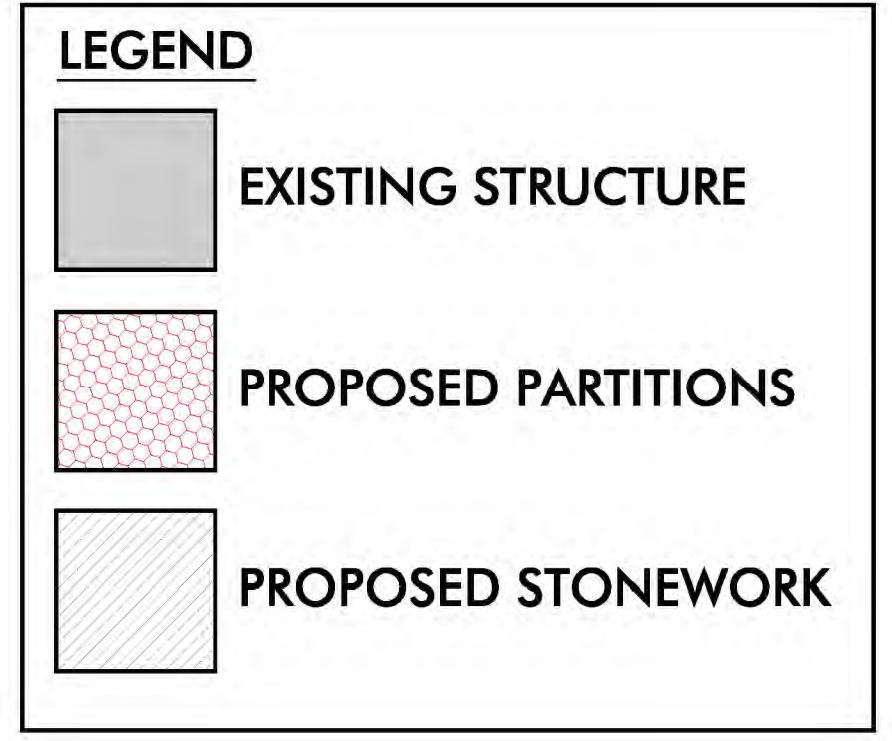

FIRST FLOOR PLAN

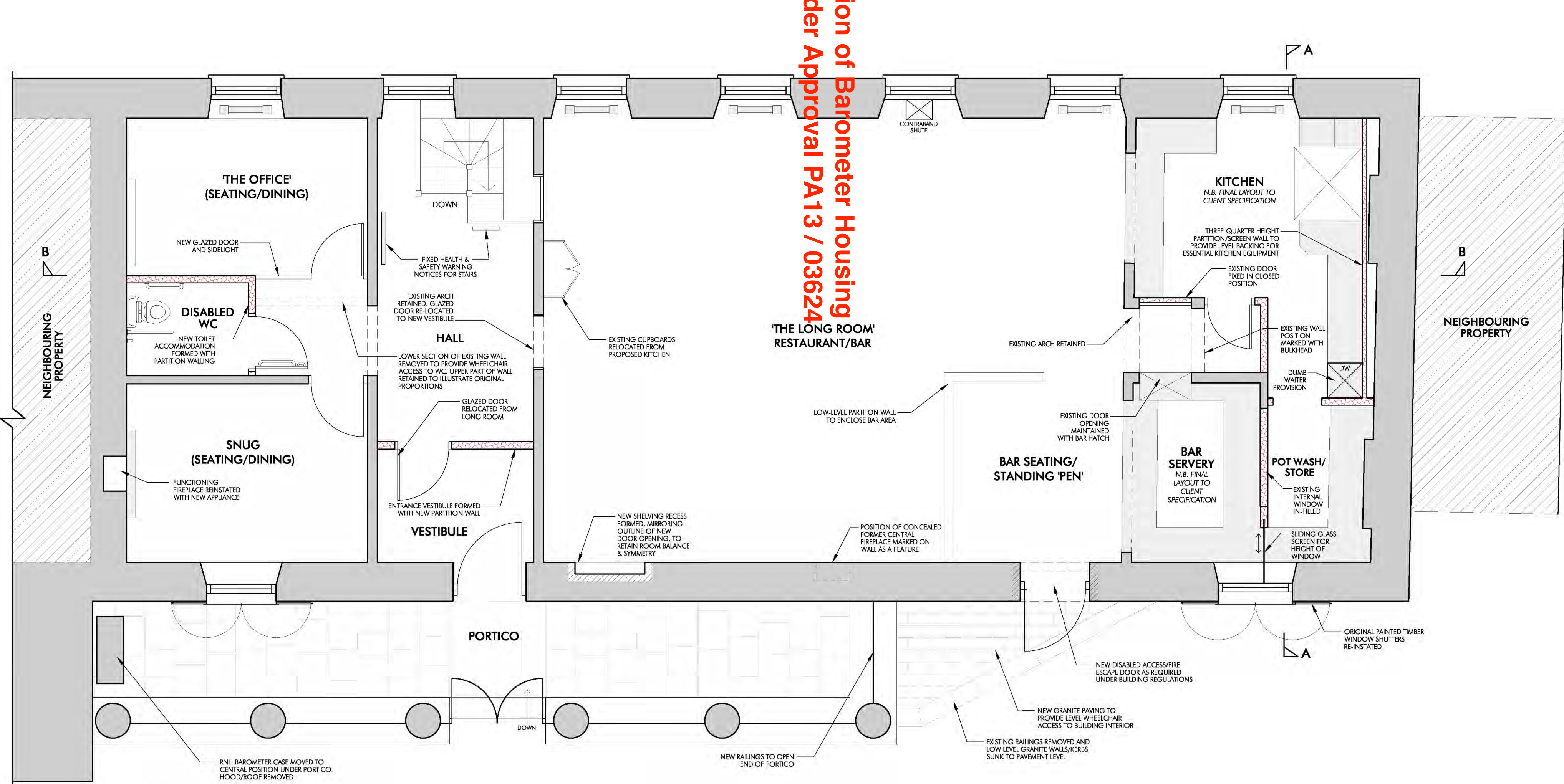
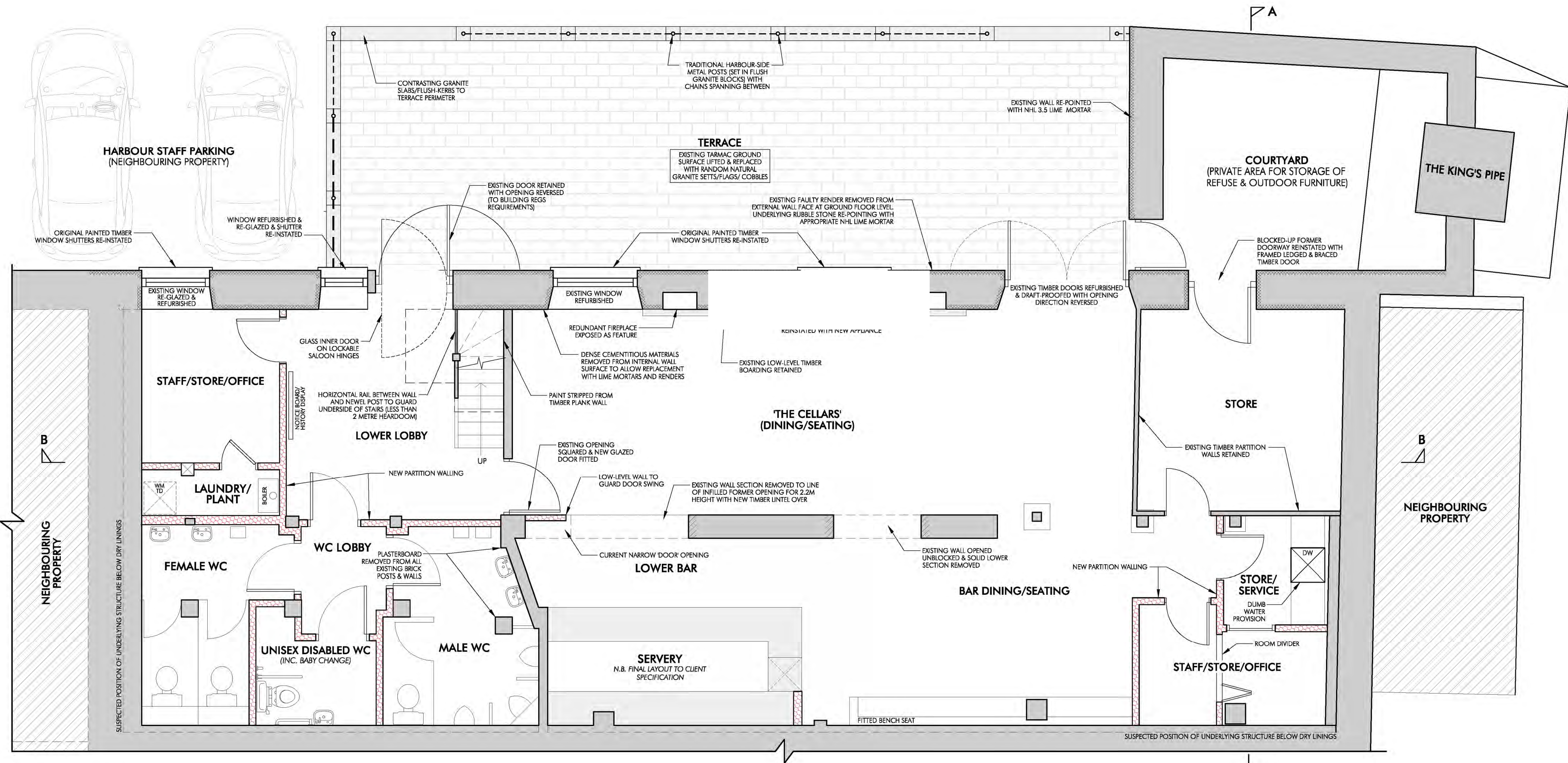

GROUND FLOOR PLAN

**REVISION B**

B	FURTHER PLANNING AMENDMENTS	21.08.2013	SM
A	PLANNING AMENDMENTS (FOLLOWING MEETING WITH LPA 24.05.2013)	30.05.2013	SM
REVISION	NOTE	DATE	INS

**CAD ARCHITECTS**  
 CAD ARCHITECTS LIMITED  
 COMMERCIAL ROAD, PENRYN CORNWALL, TR10 9AG  
 T +44(0)1326 371 344  
 studio@cadarchitects.co.uk www.cadarchitects.co.uk

PROPOSED CHANGE OF USE  
 CUSTOM HOUSE  
 ARWENACK STREET, FALMOUTH  
 CLIENT: THE STABLE BAR & RESTAURANTS LTD  
 DATE: APRIL 2013  
 SCALE: 1:50 @ A1  
 DRAWN: MD  
 CHECKED: B

DATE	DESCRIPTION	REVISION
PLANNING	2016.C.15	B