

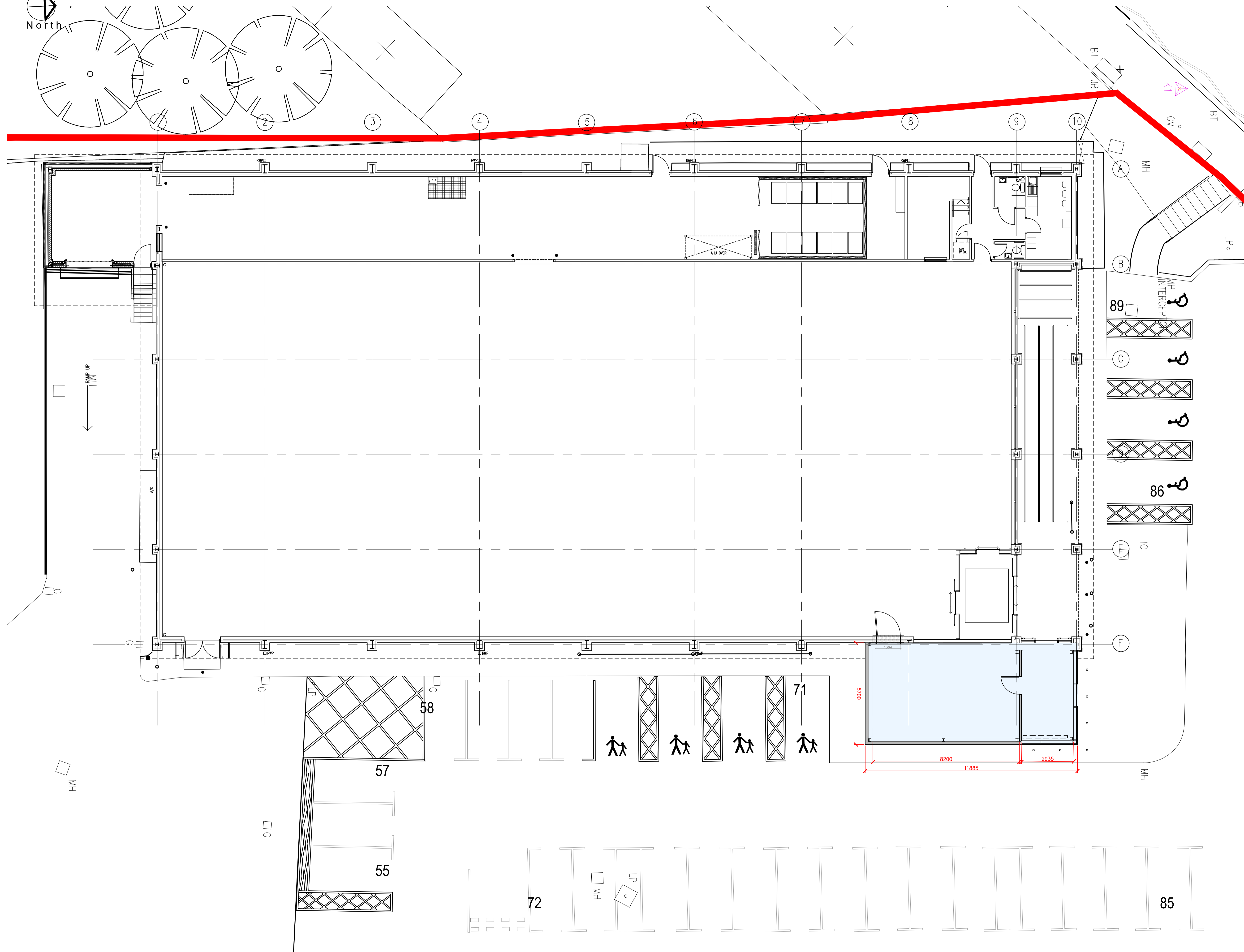

North

1. Do not scale this drawing - if in doubt ask.  
 2. All sizes to be checked on site prior to construction.  
 3. This drawing is the copyright of the author.



PROPOSED FLOOR PLAN | 1:100

smith design associates

Chartered Architects  
 16 Lynedoch Crescent, Glasgow G3 6EQ  
 client: Lidl GmbH UK

project: Proposed Retail Unit Extension  
 Main Street, BALLIESTON  
 drawing: Proposed Floor Plan original size: A1

scale: 1:100  
 date: 03.12.20  
 status: PLANNING

job no.: G2910-04 AL(0)014  
 drawing no.:  
 revision: