

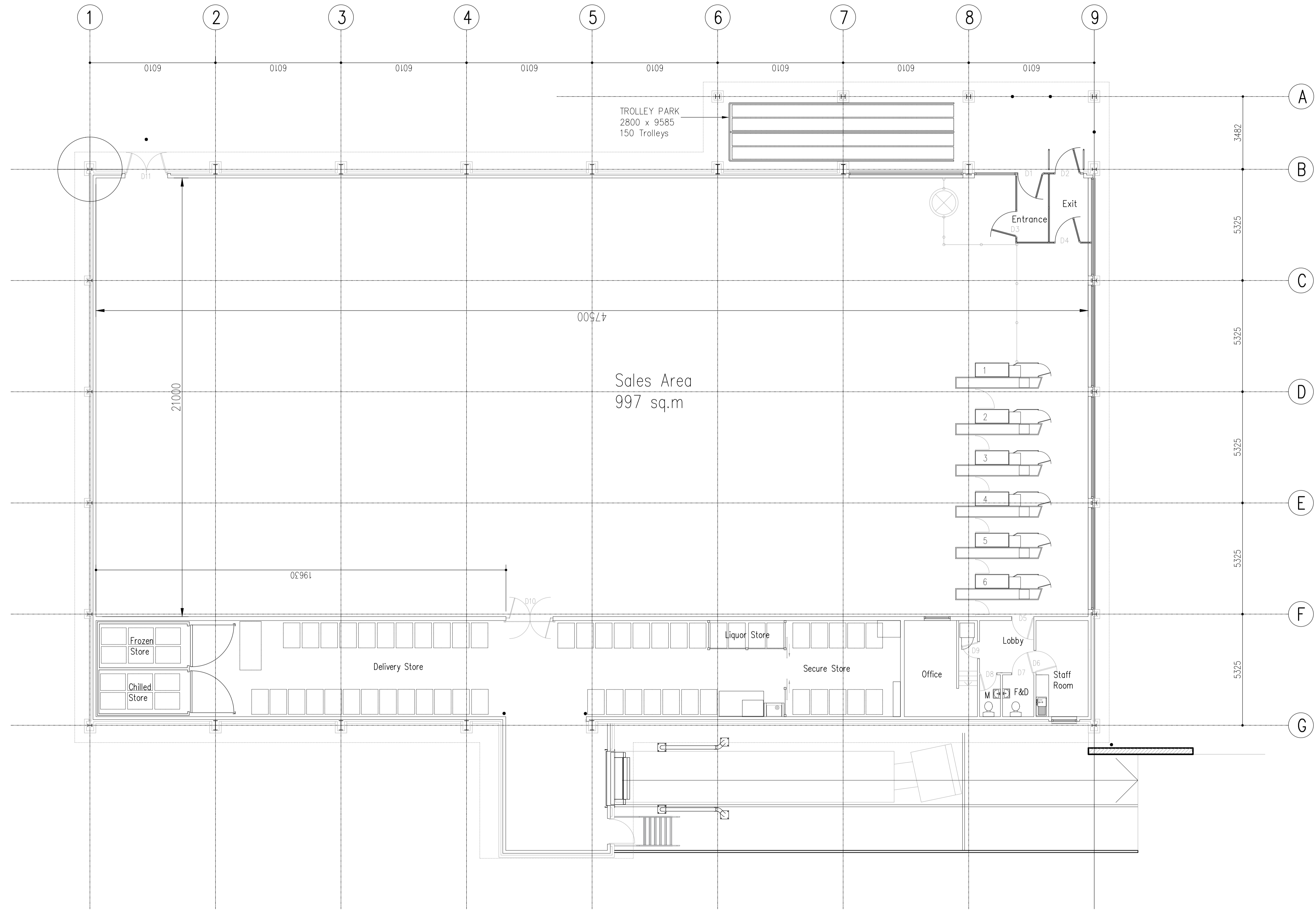

1. Do not scale this drawing - if in doubt ask.  
 2. All sizes to be checked on site prior to construction.  
 3. This drawing is the copyright of the author.



**smith design associates**  
 www.smithdesign.co.uk

Chartered Architects  
 16 Lynedoch Crescent, Glasgow G3 6EQ  
 client: Lidl GmbH UK

project: Proposed Retail Unit Extension  
 Crookston Road, GLASGOW

drawing: Existing Floor Plan original size: A1

scale: 1:100 drawn: RP

date: 04.12.20 checked: -

status: PLANNING passed: -

job no.: G2910-05 AL(0)004 drawing no.: - revision: -

