

Supply and install new external paving stones around the new extension as indicated by blue hatching.

line of neighboring extended property

modular ramp by others

400mm wall with 1.8m fence behind

1.8m fence

1.8m fence

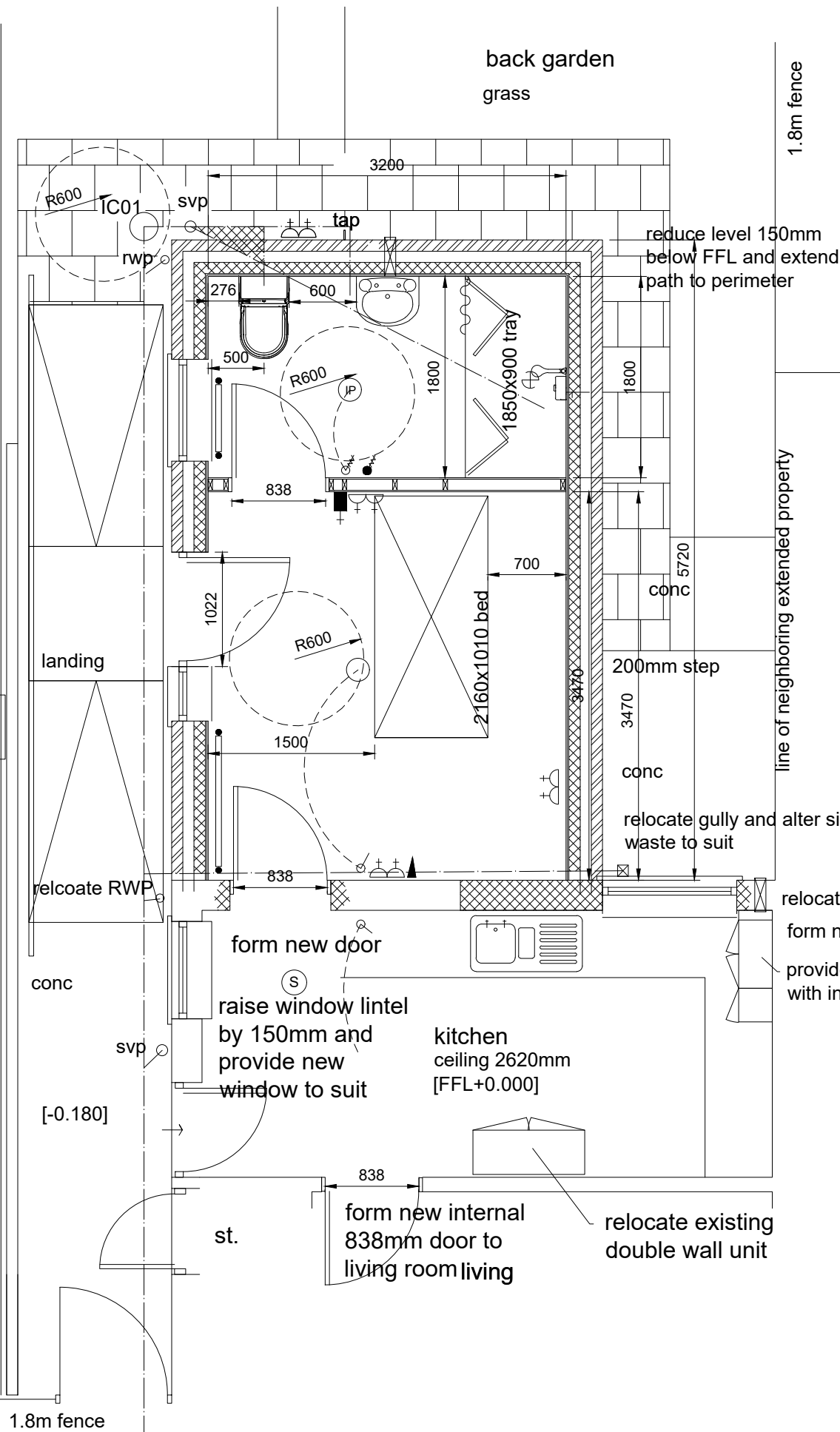

proposed plan

1.8m fence

line of neighboring extended property

relocate gully and alter sink waste to suit

relocate extractor

form new window opening, provide new 600mm wall un with infill

relocate existing double wall unit

form new internal 838mm door to living room living

st.

raise window lintel by 150mm and provide new window to suit

form new door

svp

[-0.180]

conc

relocate RWP

landing

reduce level 150mm below FFL and extend path to perimeter

back garden grass

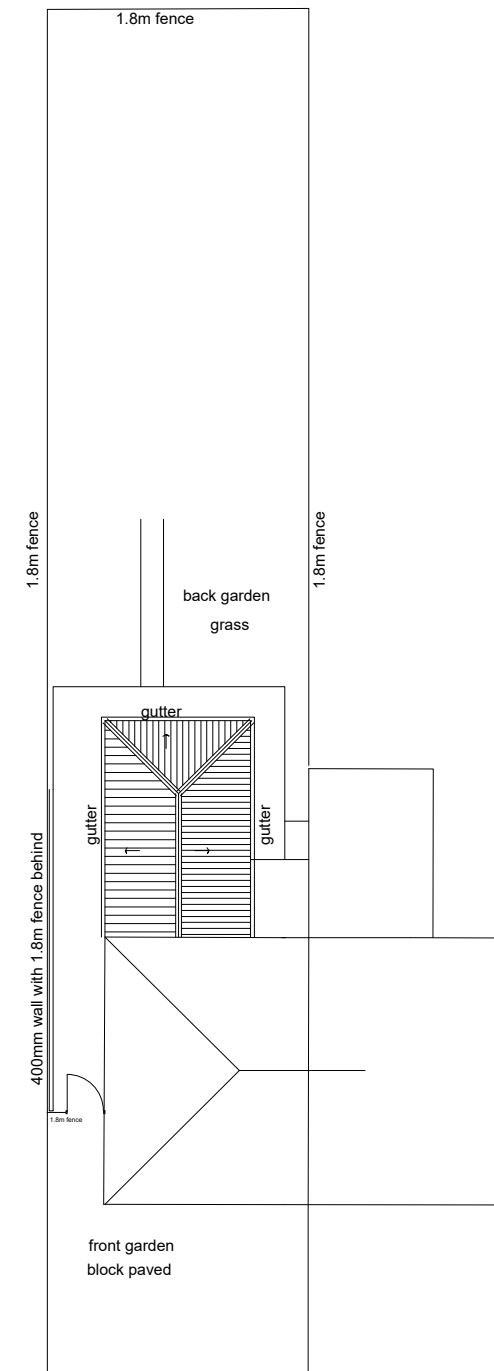

proposed site plan
scale 1:200

- Key:
- existing radiator
 - proposed radiator
 - mains feed interlinked heat / smoke detector
 - light switch
 - pull cord shower switch
 - pull cord light switch
 - light IPX 4 rated suitable for shower room linked to extract fan
 - light fitting
 - mechanical extract fan with isolation spur
 - fused spur to extract fan
 - 13amp double socket
 - TV point linked to existing aerial

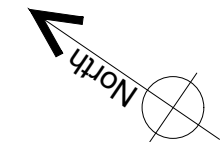

cummings
Architects Limited

17 Killingworth Drive • Sunderland • SR4 8QQ • Tel: 07985442755
e-mail: info@cummingsarchitects.co.uk

PROJECT
55 The Leas, Darlington, DL1 3DA

DRAWING TITLE
proposed plan

DATE	SCALE	JOB NO.	DRAWING NO.	REV.
12.10.20	50@ A3	20143	02	*

Drawing and design copyright of Cummings Architects Limited. Cummings Architects LTD. accepts no liability to third parties arising out of the unlawful reproduction or use of this drawing. Dimensions to be confirmed on site before work commences & ordering of materials. Any discrepancies must be reported to Architect before any work is undertaken. This drawing is to be read in conjunction with relevant consultants information and specifications.



A Member of the Royal Institute of British Architects

