

**SUBJECT TO BUILDING CONTROL APPROVAL**

**NOTES:**  
 PS1 DENOTES 400 x 100 x 215 mm DEEP CONCRETE PADSTONE  
 INDICATES SPAN OF 50 x 150 mm C24 TIMBER RAFTERS AT 400 mm CENTRES  
 ALL NEW CEILING JOISTS TO BE 50 x 100 C16 TIMBERS AT 400 mm CENTRES

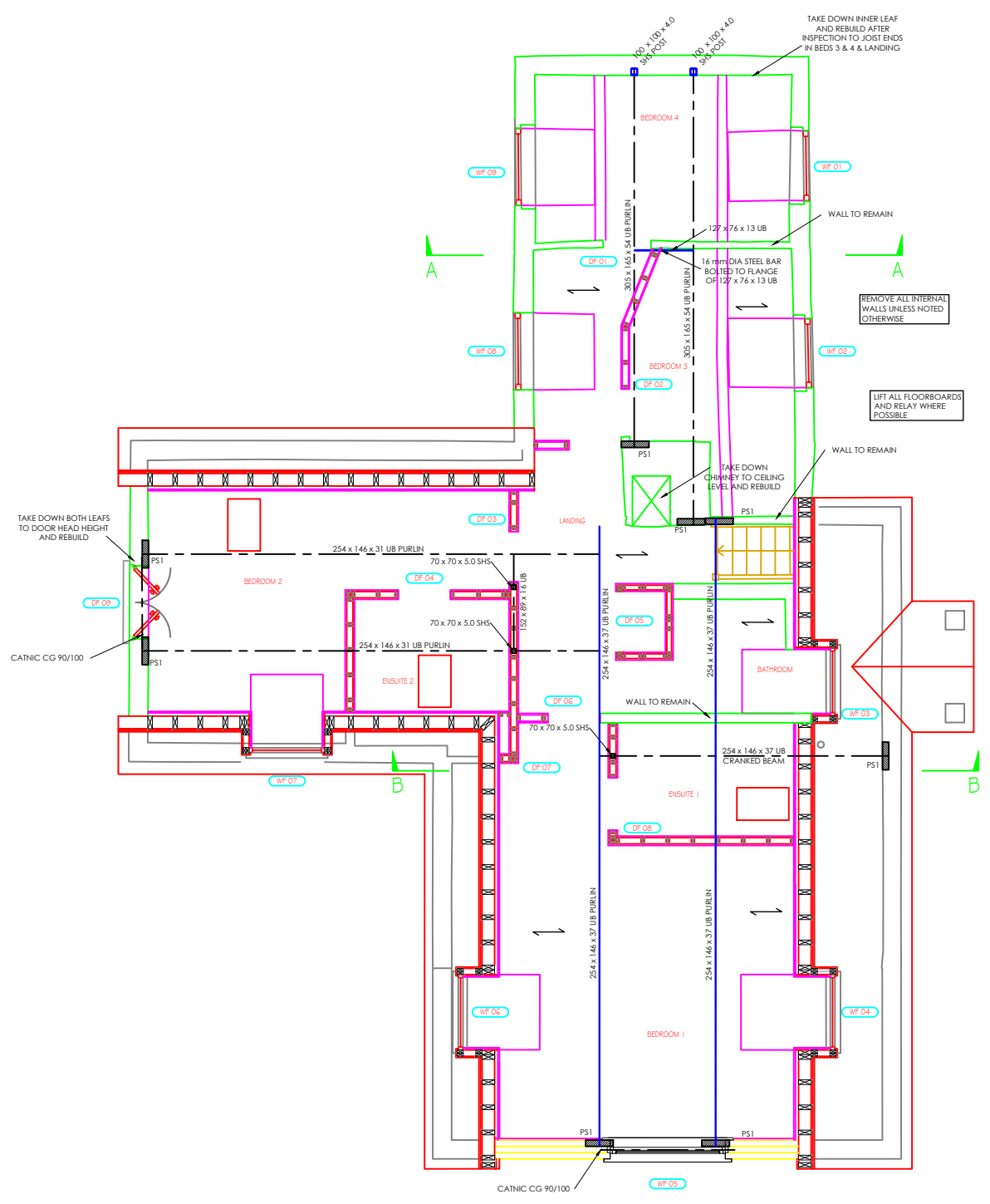

**FIRST FLOOR PLAN**

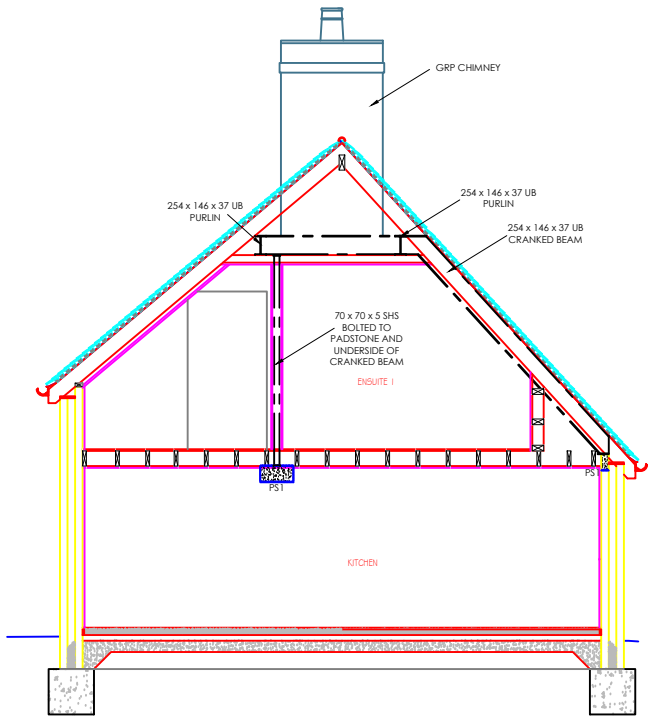

**SECTION B-B**

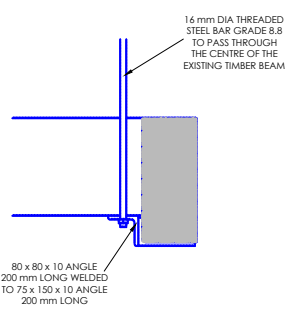

**DETAIL A**

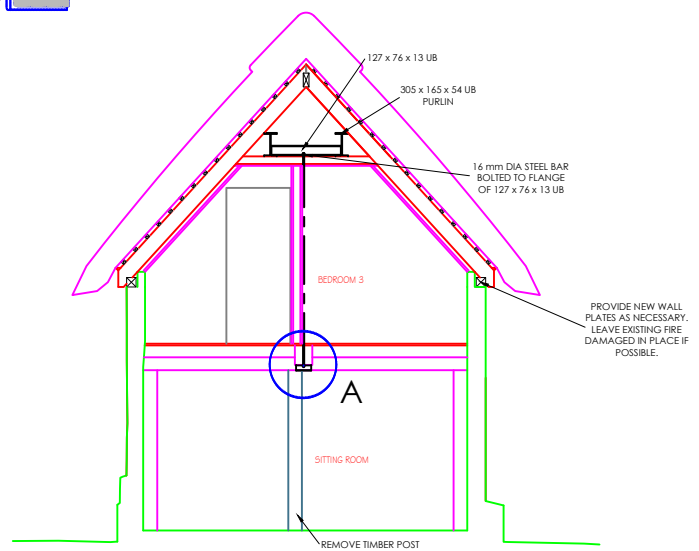

**SECTION A-A**

- NOTES**
- THIS DRAWING IS THE COPYRIGHT OF THE CONSULTANT AND MUST NOT BE USED OR REPRODUCED WITHOUT THEIR PERMISSION.
  - THIS DRAWING IS TO BE READ IN CONJUNCTION WITH ALL RELEVANT ARCHITECTURAL AND M&E DRAWINGS AND THE SPECIFICATIONS.
  - THE CONTRACTOR IS RESPONSIBLE FOR THE ACCURACY OF ALL DIMENSIONS AND THE CORRECT SETTING OUT OF THE WORK ON SITE.
  - THE CONTRACTOR SHALL PROVIDE ALL NECESSARY BRACING AND SAFEGUARDS TO ENSURE THE STABILITY OF THE STRUCTURE AND ALL ASSOCIATED PARTS AT ALL TIMES DURING CONSTRUCTION, AND SHALL ENSURE THAT ALL WORKS ARE CARRIED OUT IN STRICT ACCORDANCE WITH THE CONSTRUCTION (DESIGN & MANAGEMENT) REGULATIONS.
  - MINIMUM MASONRY STRENGTHS:**  
 100mm BRICKWORK - TO MATCH EXTG - 20N/mm<sup>2</sup>  
 100mm BLOCKWORK - TOPCRETE STANDARD - 7.3N/mm<sup>2</sup>
  - STEELWORK**  
 ALL ROLLED SECTION STRUCTURAL STEELWORK TO BE OF MILD STEEL GRADE S355. ALL OTHER STEELWORK TO BE OF MILD STEEL GRADE S275. CONNECTORS TO BE ISO ZINC COATED HEXAGONAL BOLTS AND NUTS TO B.S.4190. WELDING SHALL BE 6mm FILLET; METAL ARC TO THE APPROPRIATE BRITISH STANDARDS.
  - ALL STEELWORK SHALL BE PREPARED USING UNIT OR SHOT BLASTING, SURFACE FINISH TO BE 2ND QUALITY.  
  
 ALL STEEL WORK ABOVE GROUND IS TO BE PROTECTED BY ZINC RICH PREFABRICATION PRIMER FOLLOWED AFTER BY ONE COAT OF ZINC RICH PRIMER, ONE UNDERCOAT AND ONE GLOSS COAT BOTH OF MICACEOUS IRON OXIDE PAINT. ALTERNATIVE PREPARATIONS, PRIMING AND FINISHING MAY BE USED ON THE WRITTEN APPROVAL OF THE S.E..  
  
 ALL STEELWORK BELOW GROUND SHALL BE LEFT UNPAINTED AND ENCASED IN 100mm DENSE CONCRETE.
  - THE STEELWORK CONTRACTOR IS TO DESIGN ALL CONNECTIONS AS SHOWN ON DRAWINGS. SHOP DRAWINGS TO BE SUBMITTED IN DUPLICATE TO S.E. ALLOWING 14 DAYS FOR APPROVAL PRIOR TO COMMENCING FABRICATION.
  - ALL STRUCTURAL STEELWORK AND COMPONENTS TO BE MANUFACTURED IN ACCORDANCE WITH THE REQUIREMENTS OF EXECUTION CLASS EXC2 TO BS EN 1090-2
  - ALL EXPOSED OR EXTERNALLY SITUATED STEELWORK TO BE HOT-DIP GALVANISED TO BS EN ISO 1461. ALTERNATIVE CORROSION PROTECTIVE MEASURES MAY BE USED ON THE WRITTEN APPROVAL OF THE S.E.
  - ALL PROPRIETARY STRUCTURAL ELEMENTS ARE SPECIFIED ON AN 'OR APPROVED EQUIVALENT' BASIS AND ARE TO BE INSTALLED IN STRICT ACCORDANCE WITH THE MANUFACTURERS DETAILS AND RECOMMENDATIONS.
  - USE FIGURED DIMENSIONS ONLY. SUBJECT TO SITE SURVEY AND ALL NECESSARY CONSENTS. ALL DIMENSIONS TO BE CHECKED BY USER AND ANY DISCREPANCIES OR OMISSIONS TO BE REPORTED TO THE S.E. BEFORE WORK COMMENCES.
  - THE CONSTRUCTION (DESIGN AND MANAGEMENT) HEALTH AND SAFETY 2015 REGULATIONS APPLY TO THIS PROJECT. THE CLIENT MUST ENSURE THAT SUITABLE ARRANGEMENTS ARE IN PLACE BEFORE WORKS COMMENCE.
  - THROUGHOUT THE WORKS THE CLIENT / PRINCIPAL DESIGNER / CONTRACTOR IS RESPONSIBLE FOR ENSURING THAT THE REQUIREMENTS OF THE HEALTH AND SAFETY CDM REGULATIONS ARE COMPLIED WITH. THE ENGINEER BELIEVES THAT THERE ARE NO FORESEEABLE UNUSUAL RISKS THAT MAY ARISE DURING CONSTRUCTION, MAINTENANCE, OR USE THAT A COMPETENT CONTRACTOR COULD NOT FORESEE, UNLESS NOTED OTHERWISE. IF DEMOLITION OCCURS A R&D ASBESTOS SURVEY IS RECOMMENDED.

REV		DATE
CLIENT	MR & MRS MACISAAC	
PROJECT	THE MALHOUSE, BEAUWORTH	
TITLE	FIRST FLOOR PLAN	
	2 P S DESIGN Tel: 07787 577991 Email: kevinpalmer957@gmail.com	
SCALE	1:100@A3	DATE SEP '20
DRAWN	JP	CHKD KP
DWG NO	0037/02	