

General Notes:

Do not scale from these drawings. The Contractor is responsible for checking all dimensions on site prior to commencement of the works with any errors being reported to FBI CAD & DESIGN solutions as soon as possible.

Any construction work carried out prior to receiving all necessary approvals is entirely at the householders / clients risk.

All building work to be carried out to the satisfaction of the Local Authority Building Control Officer and in accordance with the current Building Regulations and as such additional unforeseen building works may be required on site.

The Contractor shall inspect all adjoining properties which may be affected by the works prior to commencement or works and record and report with the owner any defects.

The Contractor shall be entirely responsible for the security, strength and stability of the building during the course of the works.

Drawings produced for the purpose of obtaining Building Regulations approvals only and do not constitute full working drawings.

All drawings are the copyright of FBI CAD & DESIGN solutions. This drawing may not be copied by any third parties without prior permission.

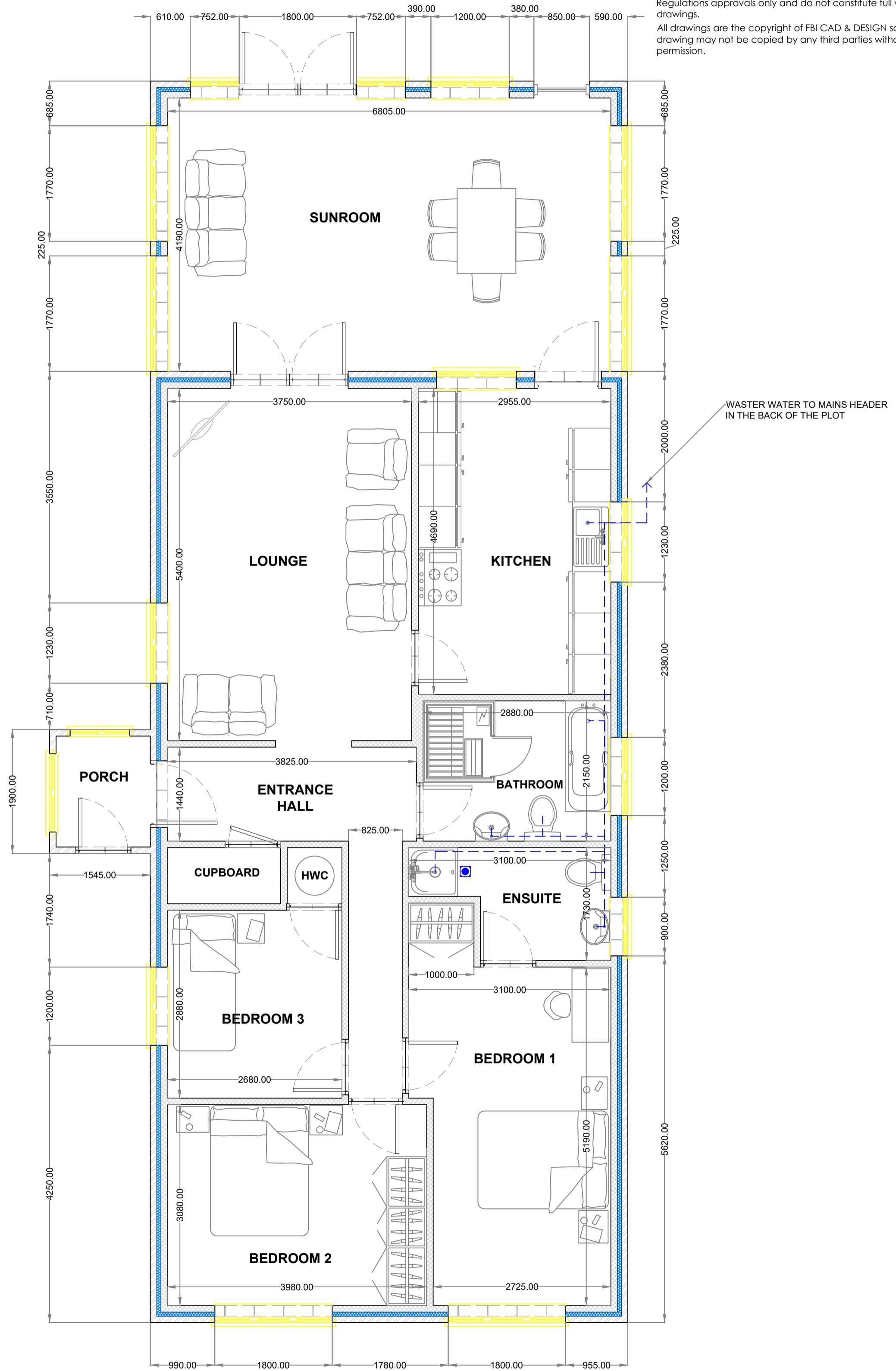

EXISTING PLAN VIEW SCALE 1:50

THIS DRAWING SHOULD BE READ
IN CONJUNCTION WITH
CONSTRUCTION NOTATION
DOCUMENT PTS 121

FBI CAD & Design Solutions "Far Beyond Imagination" "Your Dream is Our Passion"	
Email address: pt.soffley@sky.com	Phone: 01366 377075 07900 954472
Title: Knock down Existing Sunroom to Build New One	
Drawn By: Paul Soffley	
Address: 11 Foresters Avenue, Hilgay, PE38 0JU	
Date: January 2021	PTS 121
Planning Issue: Drawing 7 Rev 1	