

TYPICAL SEMI-DETACHED HOUSE

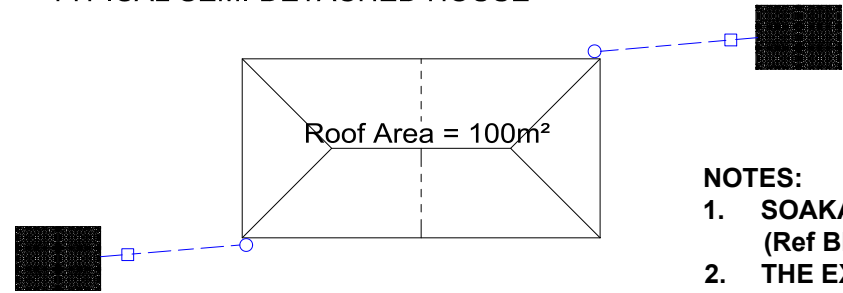

NOTES:

1. SOAKAWAYS SHOULD BE SITED AT LEAST 5m AWAY FROM THE BUILDING. (Ref BE EN 7520)
2. THE EXACT SIZE AND SHAPE OF THE SOAKAWAYS ARE TO BE DETERMINED ONCE ALL NECESSARY CALCULATIONS HAVE BEEN PRODUCED AS DESCRIBED IN BRE Digest 365- SOAKAWAY DESIGN
3. MAXIMUM INSTALLATION DEPTH 1.5m
4. LOADING CAPACITY 17.5Tonnes/m2 VERTICALLY 4.9Tonnes/m2 LATERALLY
5. □ = 250Ø SILT TRAP

General Notes:

Do not scale from these drawings. The Contractor is responsible for checking all dimensions on site prior to commencement of the works with any errors being reported to FBI CAD & DESIGN solutions as soon as possible.

Any construction work carried out prior to receiving all necessary approvals is entirely at the householders / clients risk.

All building work to be carried out to the satisfaction of the Local Authority Building Control Officer and in accordance with the current Building Regulations and as such additional unforeseen building works may be required on site.

The Contractor shall inspect all adjoining properties which may be affected by the works prior to commencement or works and record and report with the owner any defects.

The Contractor shall be entirely responsible for the security, strength and stability of the building during the course of the works.

Drawings produced for the purpose of obtaining Building Regulations approvals only and do not constitute full working drawings.

All drawings are the copyright of FBI CAD & DESIGN solutions. This drawing may not be copied by any third parties without prior permission.

GROUND LEVEL

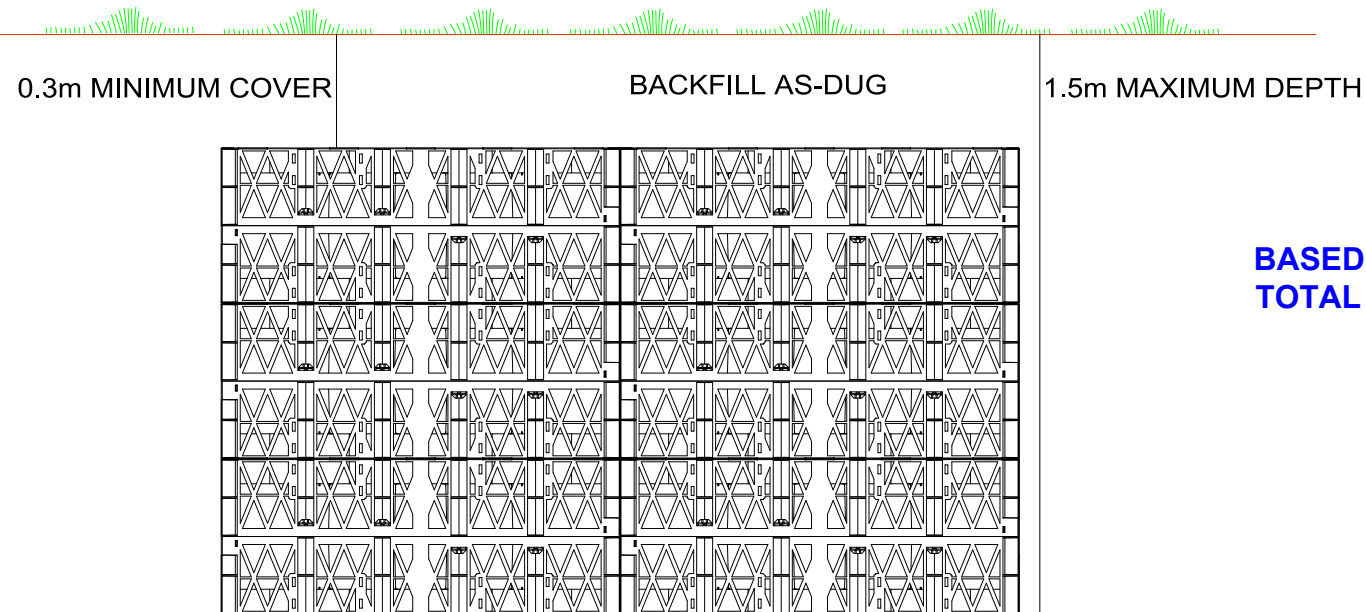

BASED ON THE DESIGN FOR 11 FORESTERS AVENUE, HILGAY
TOTAL SURFACE AREA OF NEW PITCHED ROOF = 20m2

GROUND LEVEL

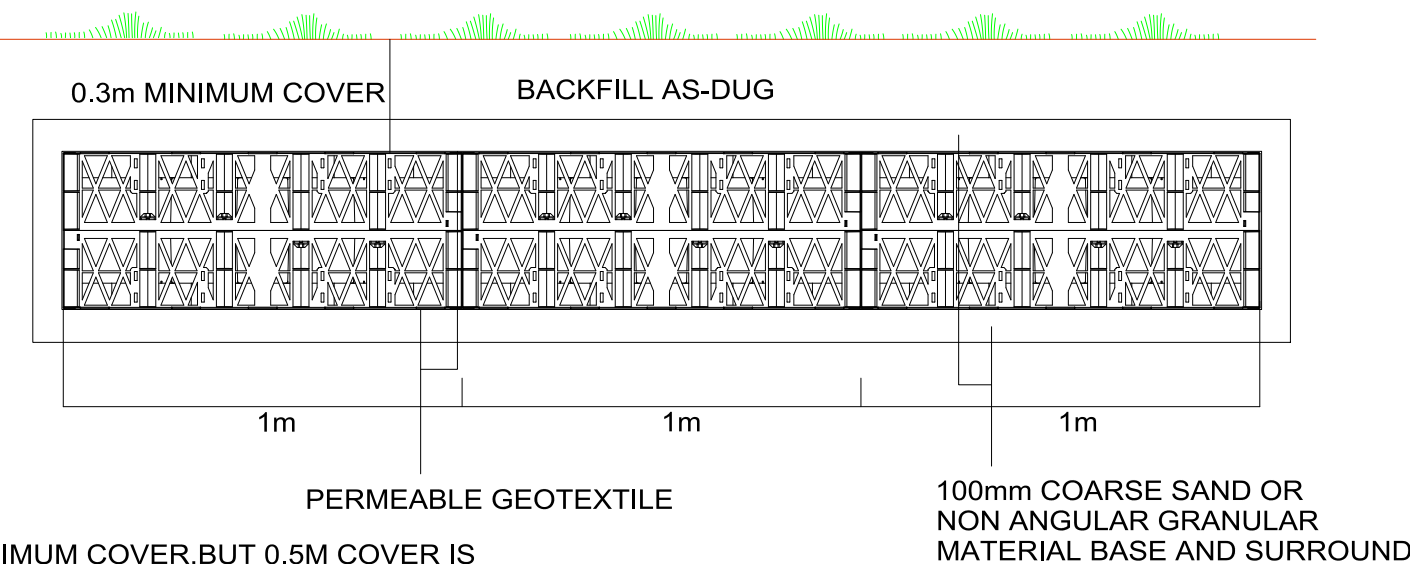

NOTE:
0.3m MINIMUM COVER, BUT 0.5M COVER IS RECOMMENDED TO PREVENT ACCIDENTAL DAMAGE.

THIS DRAWING SHOULD BE READ IN CONJUNCTION WITH CONSTRUCTION NOTATION DOCUMENT PTS 121

FBI CAD & Design Solutions

"Far Beyond Imagination"
"Your Dream is Our Passion"

Email address: pt.softley@sky.com Phone: 01366 377075
07900 954472

Title: Knock down Existing Sunroom to Build New One

Drawn By: Paul Softley

Address: 11 Foresters Avenue, Hilgay, PE38 0JU

Date: January 2021 PTS 121

Planning Issue: Drawing 16 Rev 0