

Key — Boundary Wall and fence  New Extension 14.4 sq.m.  Existing Extension 9 sq.m.



Notes The brickwork of the existing extension will remain as is, with the roof being replaced with a new pitched slate roof joining up with the roof from the side extension

The existing Conservatory will remain as is

The New extension will be 6000mm long and 2400mm wide with Red brick and slate roof to match the original. When Joined to the existing extension this will be a total of 23.4 sq.m

The roof will be a wrap around slate roof pitched away from the house from a maximum height at 2750mm running down to 2200mm. There will be a hip running from Point A.- B.

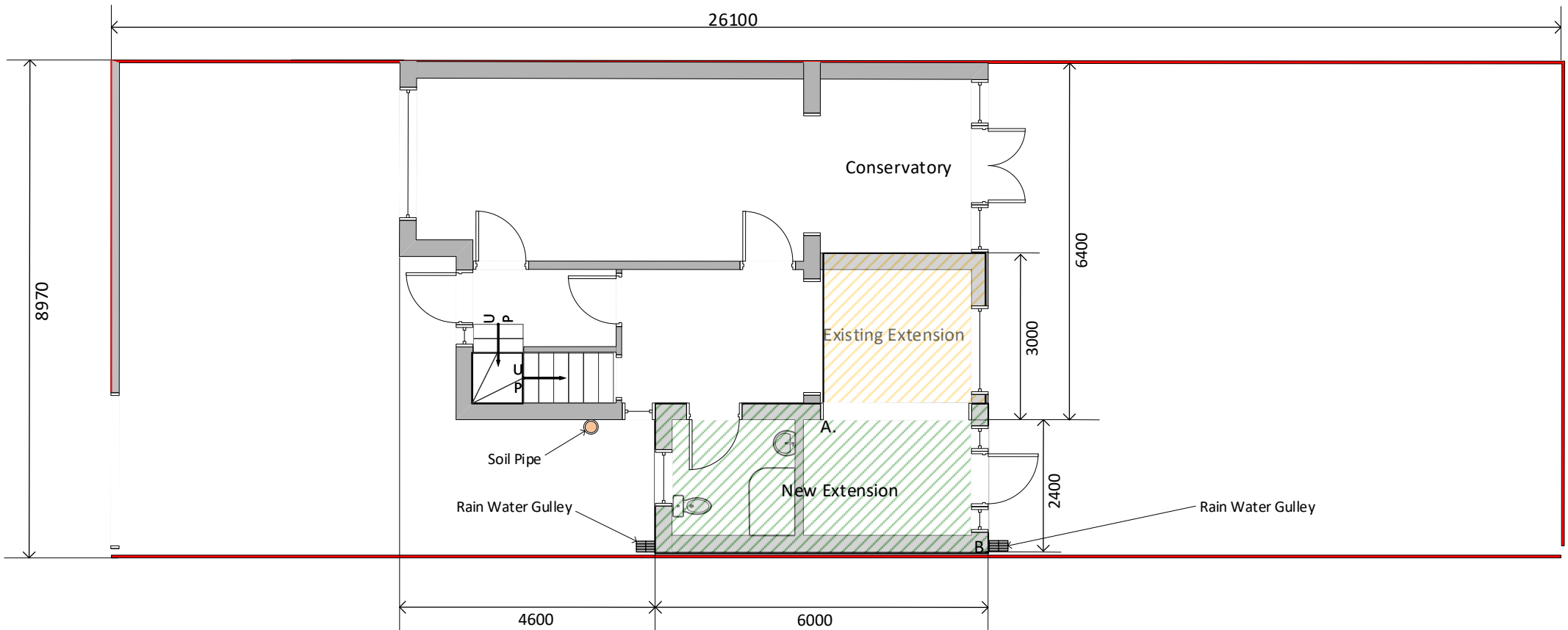

<p><b>Drawing Proposal</b> Erection of a Single Story Side / Rear Extension</p>	<p><b>Drawing Name</b> Proposed Floor Plans</p>	<p><b>Premises Address</b> 45 Salmesbury Avenue Blackpool FY2 0PR</p>	<p><b>SCALE</b> 1-100 AT A4</p>
<p><b>Drawing Details</b> The purpose of this drawing is for the submission of a Pre Planning Application All Measurements have been drawn in millimetres. This drawing is not be used for the intention of any building, shop fitting or construction purposes.</p>	<p><b>Drawing Title</b> PFP-FY20PR-02</p>		