

Key  Boundary Wall and fence

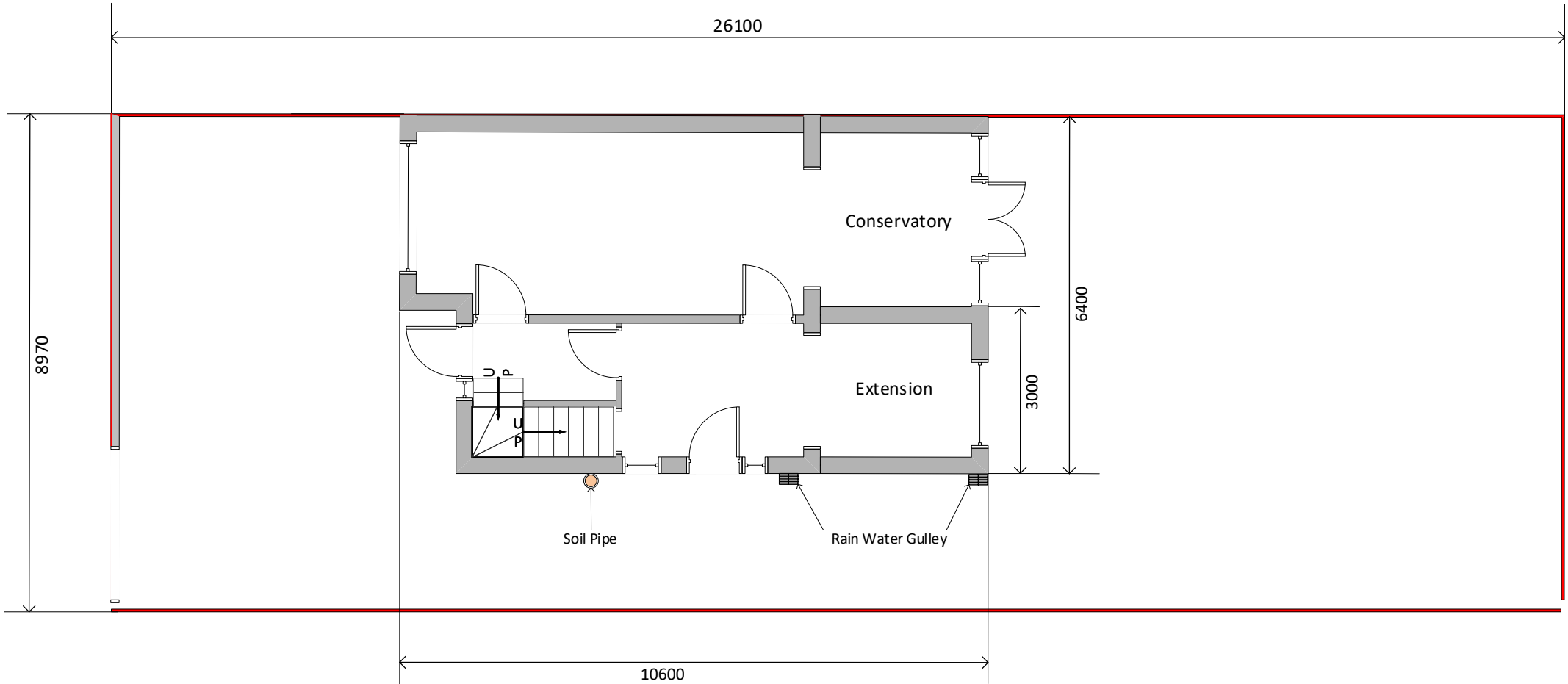

Notes The existing extension has been built using redbrick to match the brickwork in the main house, with a lean-to pitched slate roof sloping away from the house. It is 3000mm wide and 3000m long, with the peak of the roof at 2750mm running down to 2200mm

The existing Conservatory is built on a red brick dwarf wall with double glazed windows and doors and an Edwardian shaped glazed roof with its peak at 2700mm



**Drawing Proposal**

**Erection of a single Story side / rear extension**

**Drawing Details**

The purpose of this drawing is for the submission of a Pre Planning Application  
All Measurements have been drawn in millimetres.  
This drawing is not be used for the intention of any building, shop fitting or construction purposes.

**Drawing Name**

**Existing Floor Plans**

**Drawing Title**

**EFP-FY20PR-02**

**Premises Address**

**45 Salmesbury Avenue  
Blackpool  
FY2 0PR**

**SCALE**

**1-100 AT A4**